

# CITY OF HARTFORD SIDEWALK REPLACEMENT PROJECT

LOCATION:  
VARIOUS STREETS  
PHASE 1  
BID PACKAGES 1, 2, 3, 4, 5 & 6

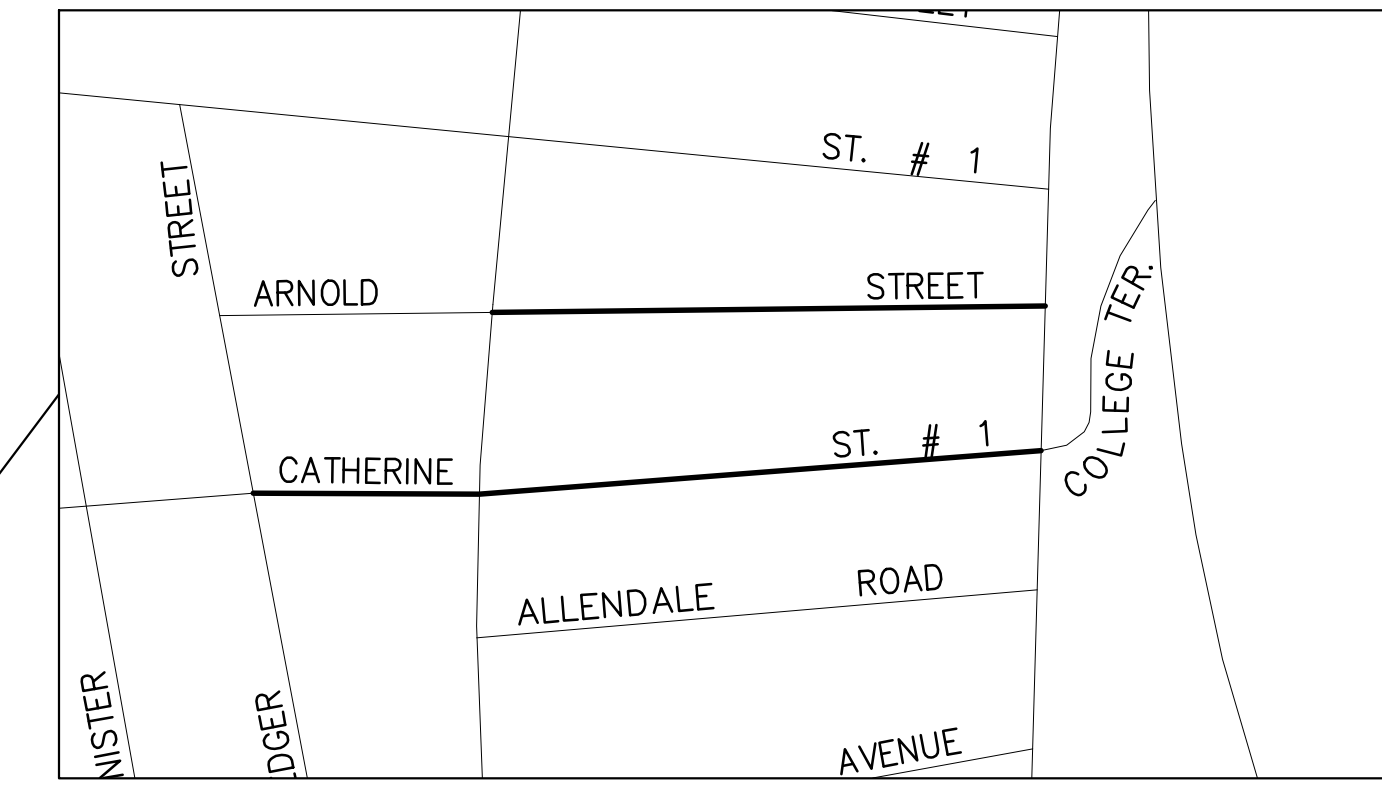

BID PACKAGE #1

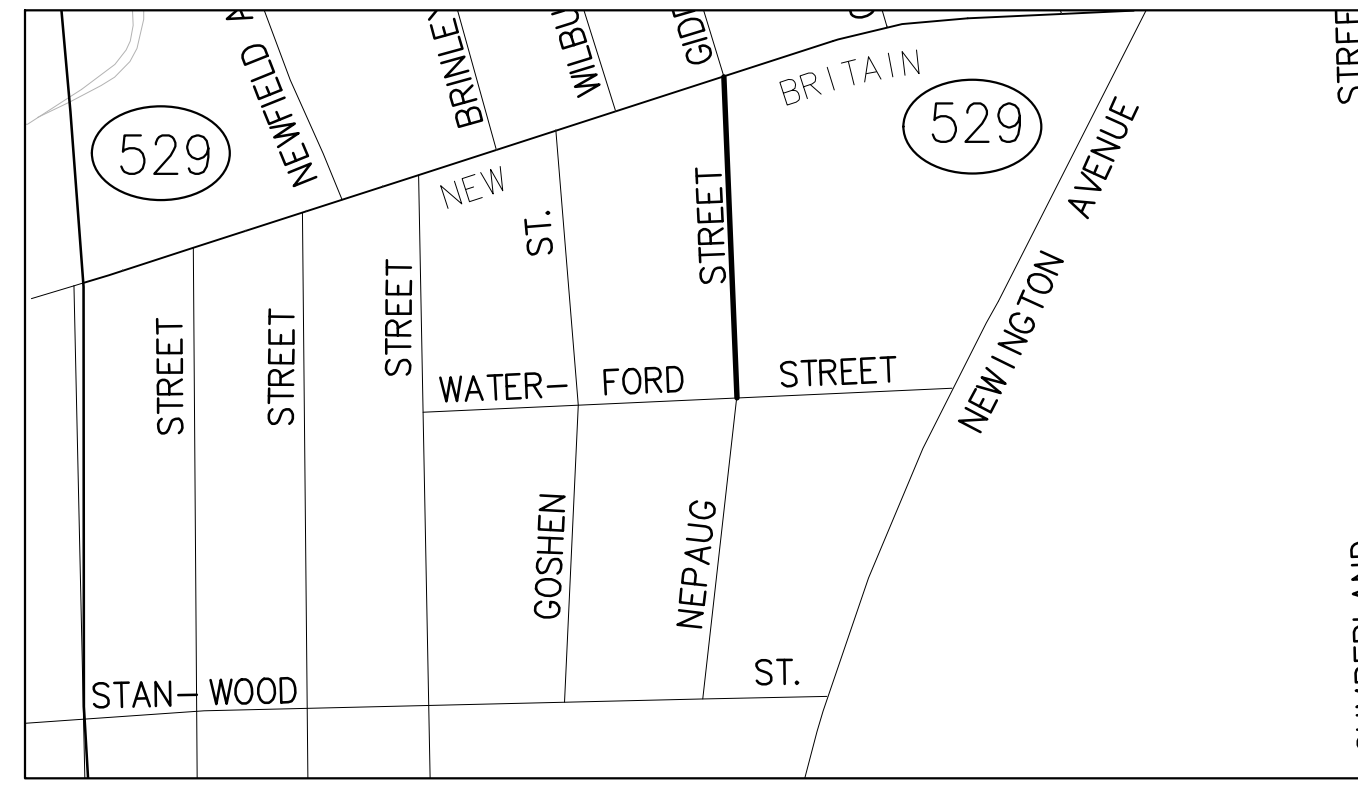

BID PACKAGE #2

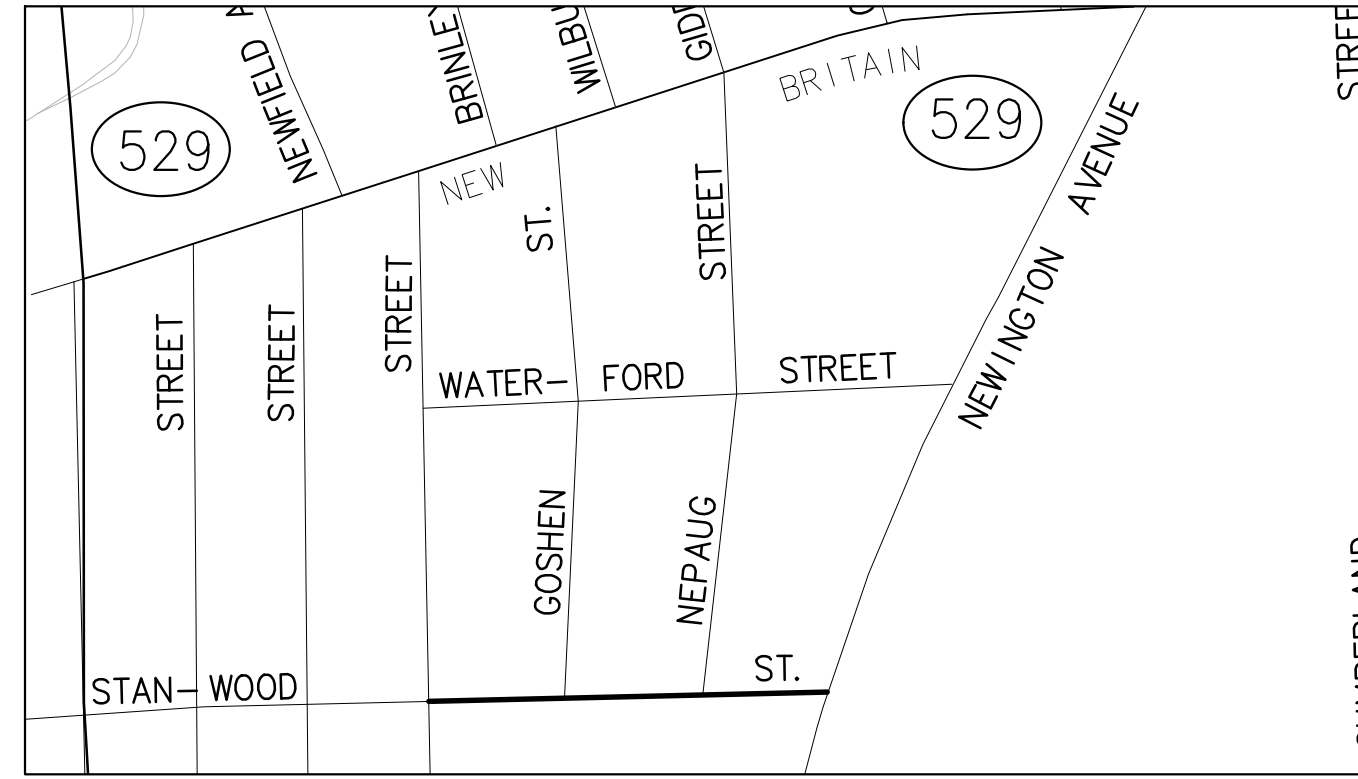

BID PACKAGE #3

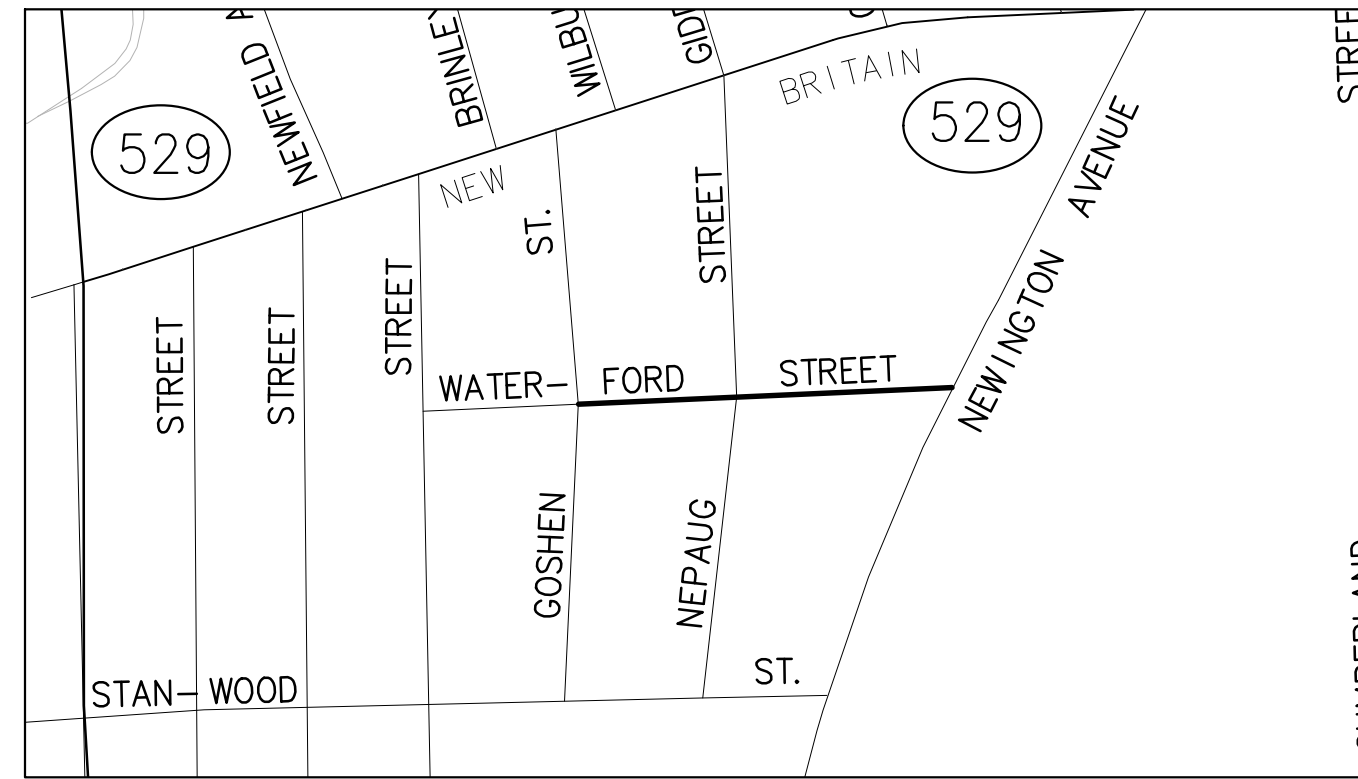

BID PACKAGE #4

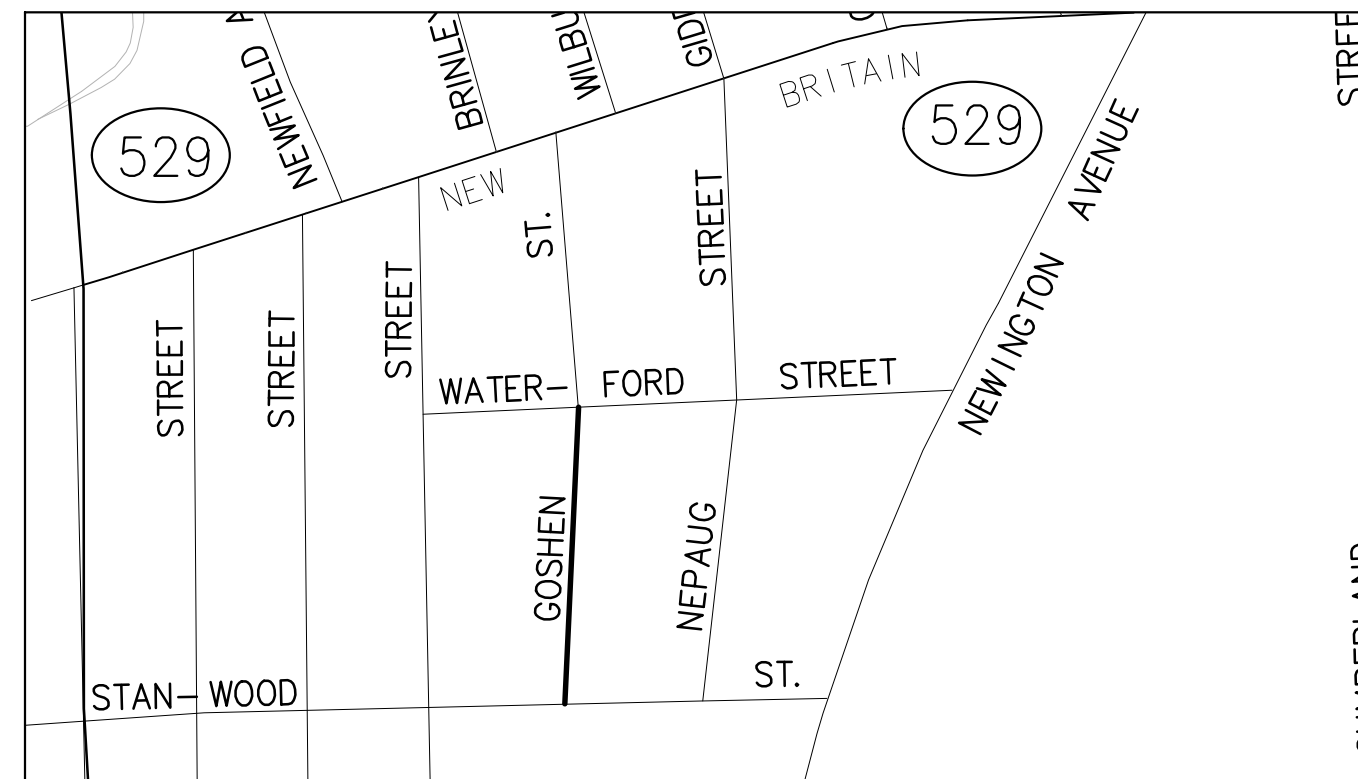

BID PACKAGE #5

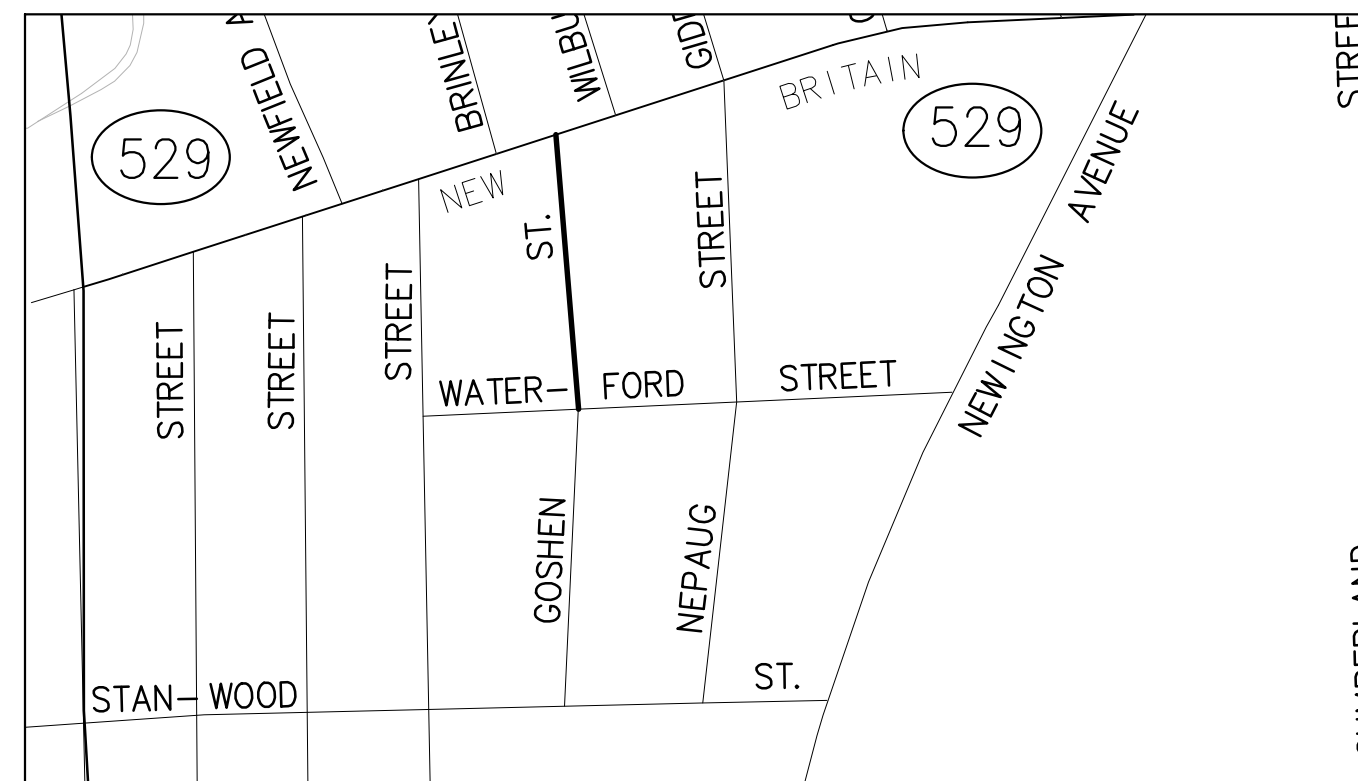

BID PACKAGE #6

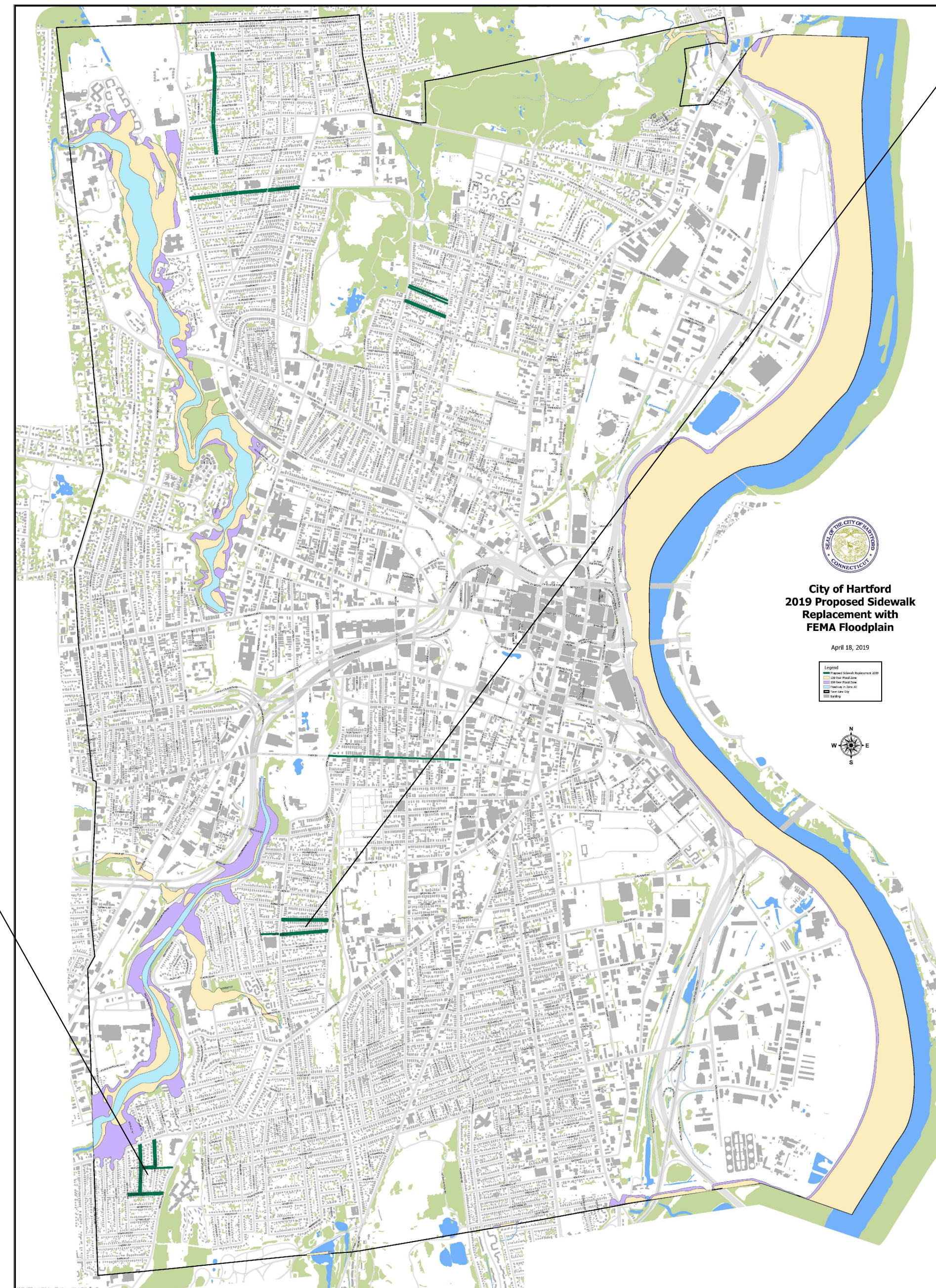

CITY OF HARTFORD  
N.T.S.

PREPARED FOR:  
CITY OF HARTFORD  
DEPARTMENT OF PUBLIC WORKS  
50 JENNINGS ROAD  
HARTFORD, CT 06103

## DRAWING LIST

	TITLE SHEET
C-101	ARNOLD STREET SIDEWALK PLAN
C-102	CATHERINE STREET SIDEWALK PLAN
C-103	NEPAUG STREET SIDEWALK PLAN
C-104	STANWOOD STREET SIDEWALK PLAN
C-105	WATERFORD STREET SIDEWALK PLAN
C-106	GOSHEN STREET SIDEWALK PLAN
C-107	GOSHEN STREET SIDEWALK PLAN
C-501	DETAILS

## DATES

ISSUE DATE: MAY 12, 2020  
REVISION:

PREPARED BY:  
**FREEMAN**  
COMPANIES

LAND DEVELOPMENT | ENGINEERING DESIGN | CONSTRUCTION SERVICES  
DBE | DAS | MBE | GNMSDC CERTIFIED  
CIVIL | GEOTECHNICAL  
SURVEY | ENVIRONMENTAL

FREEMAN COMPANIES, LLC

36 JOHN STREET  
HARTFORD, CT 06103

TEL: 860-251-9550

FAX: 860-986-7161

WWW.FREEMANCOS.COM

ELEVATE YOUR EXPECTATIONS

**LEGEND**

- APPROX. ROW
- CONTRACT LIMIT LINE
- ▭ SIDEWALK/DRIVEWAY RAMP TO REMAIN
- ▨ SIDEWALK (STANDARD REPLACEMENT)
- ▩ SIDEWALK (FULL DEPTH REPLACEMENT)
- ▣ NEW DRIVEWAY RAMP
- TREE

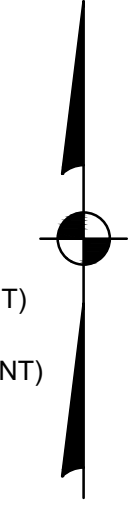

PREPARED FOR:  
 CITY OF HARTFORD  
 DEPT. OF PUBLIC WORKS  
 50 JENNINGS ROAD  
 HARTFORD, CT 06120

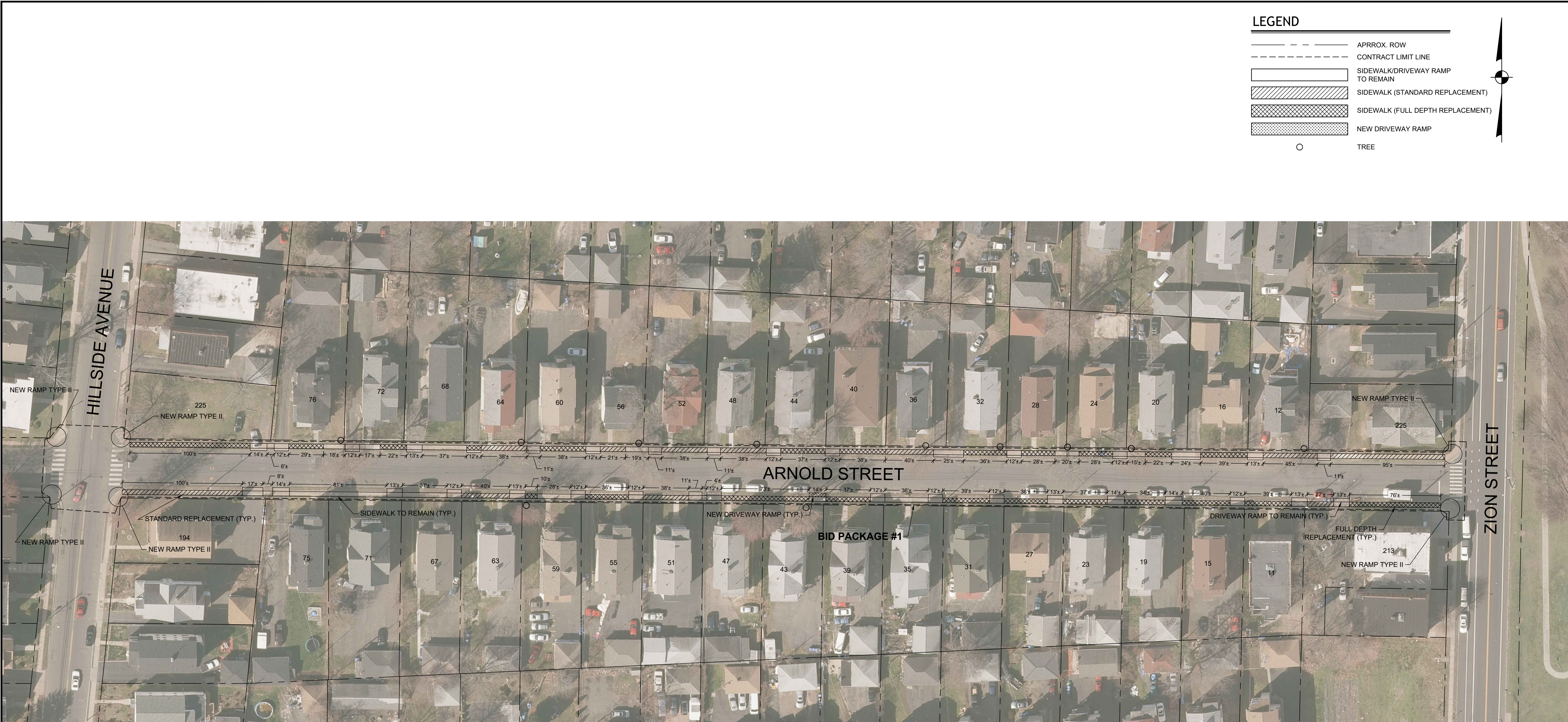

**BID PACKAGE #1**

NO.	DATE	DESCRIPTION

**FREEMAN COMPANIES, LLC**  
 DEB 1 DAS I MBE 1 GNWSC CERTIFIED  
 CIVIL, GEOTECHNICAL,  
 SURVEY, ENVIRONMENTAL  
 FREEMAN COMPANIES, LLC  
 36 JOHN STREET  
 HARTFORD, CT 06106  
 WWW.FREEMANCOS.COM  
 TEL: (860)251-9500  
 TOLL FREE: (800)694-5141  
 FAX: (860)986-7161

ELEVATE YOUR EXPECTATIONS

**SIDEWALK REPLACEMENT  
 PHASE 1  
 ARNOLD STREET  
 HARTFORD, CT 06112**

DESIGNED: P.P.  
 DRAFTED: M.K./P.T.  
 CHECKED: P.P.  
 APPROVED: J.N.L.  
 SCALE: 1" = 40'  
 FC PROJECT NO.: 2020-0113  
 DATE: 05/04/2020

**TITLE:  
 SIDEWALK PLAN**

SHEET NUMBER:  
**C-101**

**NOTES**

1. ARNOLD STREET WIDTH OF SIDEWALK = 5 FEET.
2. DIMENSIONS SHOWN ON PLANS ARE FOR INFORMATIONAL PURPOSES ONLY.
3. SIDEWALK CONSTRUCTION SEE DETAIL SHEET.
4. NEW DRIVEWAY RAMPS TO BE CONSTRUCTED PER DETAILS.
5. NEW SIDEWALK NEXT TO DRIVEWAY RAMPS TO REMAIN, SHALL BE DOWELED INTO EXISTING RAMPS, SEE DETAILS.
6. TREE REMOVAL TO BE BY CITY OR OTHERS.
7. ALL MERESTONES & MERESTONE COVERS TO BE PROTECTED DURING RECONSTRUCTION. DAMAGED OR MISSING COVERS SHALL BE REPLACED PER CITY STANDARDS.

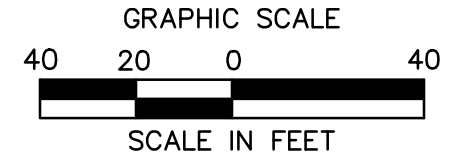

Freeman Companies, LLC - R:\2020\2020-0113 75C CM Sidewalk Project Hartford\DWG\Arnold Street.dwg May 13, 2020-12:26pm Plotted By: mkkok

THESE DRAWINGS SHALL NOT BE UTILIZED BY ANY PERSON, FIRM OR CORPORATION WITHOUT THE SPECIFIC WRITTEN PERMISSION OF FREEMAN COMPANIES, LLC



NO.	DATE	DESCRIPTION

**FREEMAN COMPANIES**  
 A DIVISION OF FREEMAN COMPANIES, LLC  
 DBE 1 DAS | MBE 1 GWSDC CERTIFIED  
 CIVIL / GEOTECHNICAL  
 SURVEY / ENVIRONMENTAL

FREEMAN COMPANIES, LLC  
 36 JOHN STREET  
 HARTFORD, CT 06106  
 WWW.FREEMANCOS.COM  
 TEL: (860) 231-9500  
 TOLL FREE: (800) 944-5141  
 FAX: (860) 986-7161

ELEVATE YOUR EXPECTATIONS

**SIDEWALK REPLACEMENT  
 PHASE 1  
 CATHERINE STREET  
 HARTFORD, CONNECTICUT**

DESIGNED:	P.P.
DRAFTED:	M.K./P.T.
CHECKED:	P.P.
APPROVED:	J.N.L.
SCALE:	1" = 40'
PC PROJECT NO.:	2020-0113
DATE:	05/04/2020

TITLE:  
**SIDEWALK PLAN**

SHEET NUMBER:  
**C-102**

**LEGEND**

- APPROX. ROW
- CONTRACT LIMIT LINE
- SIDEWALK/DRIVEWAY RAMP TO REMAIN
- SIDEWALK (STANDARD REPLACEMENT)
- SIDEWALK (FULL DEPTH REPLACEMENT)
- NEW DRIVEWAY RAMP
- TREE

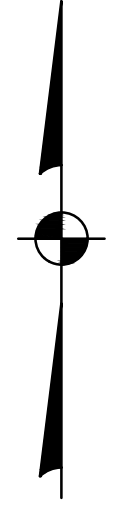

**BID PACKAGE #1**



**BID PACKAGE #1**

- NOTES**
1. CATHERINE STREET WIDTH OF SIDEWALK = 5 FEET.
  2. DIMENSIONS SHOWN ON PLANS ARE FOR INFORMATIONAL PURPOSES ONLY.
  3. SIDEWALK CONSTRUCTION SEE DETAIL SHEET.
  4. NEW DRIVEWAY RAMPS TO BE CONSTRUCTED PER DETAILS.
  5. NEW SIDEWALK NEXT TO DRIVEWAY RAMPS TO REMAIN, SHALL BE DOWELED INTO EXISTING RAMPS, SEE DETAILS.
  6. TREE REMOVAL TO BE BY CITY OR OTHERS.
  7. ALL MERESTONES & MERESTONE COVERS TO BE PROTECTED DURING RECONSTRUCTION. DAMAGED OR MISSING COVERS SHALL BE REPLACED PER CITY STANDARDS.

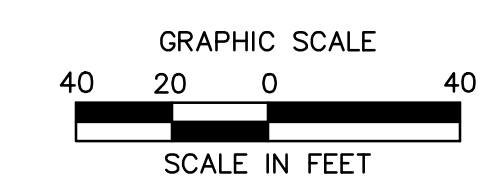

Freeman Companies, LLC - R:\2020\2020-0113 75C CM Sidewalk Project Hartford\DWG\Nepaug Street.dwg May 13, 2020--12:27pm Plotted By: mfwk



**BID PACKAGE #2  
CITY OF HARTFORD  
SET-ASIDE PROGRAM  
ONLY CERTIFIED MWBE CONTRACTORS**

### LEGEND

- — — — — APPROX. ROW
- - - - - CONTRACT LIMIT LINE
- [White Box] SIDEWALK/DRIVEWAY RAMP TO REMAIN
- [Diagonal Hatching] SIDEWALK (STANDARD REPLACEMENT)
- [Cross-hatching] SIDEWALK (FULL DEPTH REPLACEMENT)
- [Dotted Hatching] NEW DRIVEWAY RAMP
- TREE

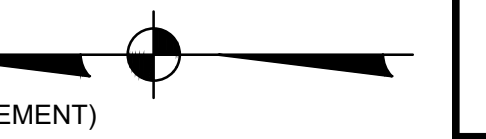

PREPARED FOR:  
CITY OF HARTFORD  
DEPT. OF PUBLIC WORKS  
50 JENNINGS ROAD  
HARTFORD, CT 06120



NO.	DATE	DESCRIPTION

**FREEMAN COMPANIES, LLC**  
 DBE | DAS | MBE | GWASDC CERTIFIED  
 CIVIL | GEOTECHNICAL  
 SURVEY | ENVIRONMENTAL

FREEMAN COMPANIES, LLC  
 36 JOHN STREET  
 HARTFORD, CT 06106  
 WWW.FREEMANCOS.COM  
 TEL: (860) 231-9500  
 TOLL FREE: (800) 604-5141  
 FAX: (860) 986-7161

ELEVATE YOUR EXPECTATIONS

**SIDEWALK REPLACEMENT**  
 PHASE 1  
 NEPAUG STREET  
 HARTFORD, CONNECTICUT

DESIGNED: P.P.  
 DRAFTED: M.K./P.T.  
 CHECKED: P.P.  
 APPROVED: J.N.L.  
 SCALE: 1" = 40'  
 FC PROJECT NO.: 2020-0113  
 DATE: 05/04/2020

TITLE:  
**SIDEWALK PLAN**

SHEET NUMBER:  
**C-103**

### NOTES

1. NEPAUG STREET WIDTH OF SIDEWALK = 5 FEET.
2. DIMENSIONS SHOWN ON PLANS ARE FOR INFORMATIONAL PURPOSES ONLY.
3. SIDEWALK CONSTRUCTION SEE DETAIL SHEET.
4. NEW DRIVEWAY RAMPS TO BE CONSTRUCTED PER DETAILS.
5. NEW SIDEWALK NEXT TO DRIVEWAY RAMPS TO REMAIN, SHALL BE DOWELED INTO EXISTING RAMPS, SEE DETAILS.
6. TREE REMOVAL TO BE BY CITY OR OTHERS.
7. ALL MERESTONES & MERESTONE COVERS TO BE PROTECTED DURING RECONSTRUCTION. DAMAGED OR MISSING COVERS SHALL BE REPLACED PER CITY STANDARDS.

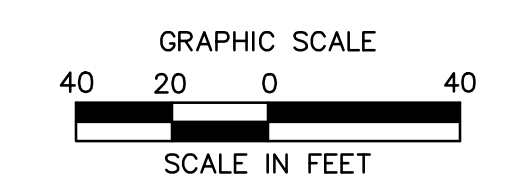



**LEGEND**

- APPROX. ROW
- CONTRACT LIMIT LINE
- ▭ SIDEWALK/DRIVEWAY RAMP TO REMAIN
- ▨ SIDEWALK (STANDARD REPLACEMENT)
- ▩ SIDEWALK (FULL DEPTH REPLACEMENT)
- ▧ NEW DRIVEWAY RAMP
- TREE

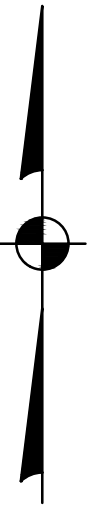

**BID PACKAGE #3  
CITY OF HARTFORD  
SET-ASIDE PROGRAM  
ONLY CERTIFIED MWBE CONTRACTORS**

**NOTES**

1. STANWOOD STREET WIDTH OF SIDEWALK = 5 FEET.
2. DIMENSIONS SHOWN ON PLANS ARE FOR INFORMATIONAL PURPOSES ONLY.
3. SIDEWALK CONSTRUCTION SEE DETAIL SHEET.
4. NEW DRIVEWAY RAMPS TO BE CONSTRUCTED PER DETAILS.
5. NEW SIDEWALK NEXT TO DRIVEWAY RAMPS TO REMAIN, SHALL BE DOWELED INTO EXISTING RAMPS, SEE DETAILS.
6. TREE REMOVAL TO BE BY CITY OR OTHERS.
7. ALL MERESTONES & MERESTONE COVERS TO BE PROTECTED DURING RECONSTRUCTION. DAMAGED OR MISSING COVERS SHALL BE REPLACED PER CITY STANDARDS.

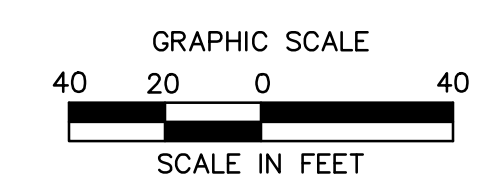

NO.	DATE	DESCRIPTION

**FREEMAN COMPANIES**  
DBE 1 DAS | MBE 1 GWASDC CERTIFIED  
CIVIL / GEOTECHNICAL  
SURVEY / ENVIRONMENTAL

FREEMAN COMPANIES, LLC  
36 JOHN STREET  
HARTFORD, CT 06106  
WWW.FREEMANCOS.COM  
TEL: (860) 231-9500  
TOLL FREE: (800) 694-5141  
FAX: (860) 986-7161

ELEVATE YOUR EXPECTATIONS

**SIDEWALK REPLACEMENT  
PHASE 1  
STANWOOD STREET  
HARTFORD, CONNECTICUT**

DESIGNED: P.P.  
DRAFTED: M.K./P.T.  
CHECKED: P.P.  
APPROVED: J.N.L.  
SCALE: 1" = 40'  
FC PROJECT NO.: 2020-0113  
DATE: 05/04/2020

**TITLE:  
SIDEWALK PLAN**

SHEET NUMBER:  
**C-104**



NO.	DATE	DESCRIPTION

**FREEMAN COMPANIES**  
DBE 1 DAS | MBE 1 GWASDC CERTIFIED  
CIVIL / GEOTECHNICAL  
SURVEY / ENVIRONMENTAL  
**FREEMAN COMPANIES, LLC**  
36 JOHN STREET  
HARTFORD, CT 06106  
WWW.FREEMANCOS.COM  
TEL: (860) 231-9500  
TOLL FREE: (800) 964-5141  
FAX: (860) 986-7161

ELEVATE YOUR EXPECTATIONS

**SIDEWALK REPLACEMENT  
PHASE 1  
WATERFORD STREET  
HARTFORD, CONNECTICUT**

DESIGNED: P.P.  
DRAFTED: M.K./P.T.  
CHECKED: P.P.  
APPROVED: J.N.L.  
SCALE: 1" = 40'  
FC PROJECT NO.: 2020-0113  
DATE: 05/04/2020

TITLE:  
**SIDEWALK PLAN**

SHEET NUMBER:  
**C-105**

**LEGEND**

- APPROX. ROW
- CONTRACT LIMIT LINE
- SIDEWALK/DRIVEWAY RAMP TO REMAIN
- SIDEWALK (STANDARD REPLACEMENT)
- SIDEWALK (FULL DEPTH REPLACEMENT)
- NEW DRIVEWAY RAMP
- TREE

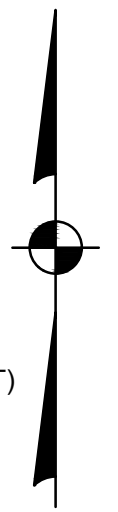

**BID PACKAGE #4  
CITY OF HARTFORD  
SET-ASIDE PROGRAM  
ONLY CERTIFIED MWBE CONTRACTORS**

**NOTES**

- WATERFORD STREET WIDTH OF SIDEWALK = 5 FEET.
- DIMENSIONS SHOWN ON PLANS ARE FOR INFORMATIONAL PURPOSES ONLY.
- SIDEWALK CONSTRUCTION SEE DETAIL SHEET.
- NEW DRIVEWAY RAMPS TO BE CONSTRUCTED PER DETAILS.
- NEW SIDEWALK NEXT TO DRIVEWAY RAMPS TO REMAIN, SHALL BE DOWELED INTO EXISTING RAMPS, SEE DETAILS.
- TREE REMOVAL TO BE BY CITY OR OTHERS.
- ALL MERESTONES & MERESTONE COVERS TO BE PROTECTED DURING RECONSTRUCTION. DAMAGED OR MISSING COVERS SHALL BE REPLACED PER CITY STANDARDS.

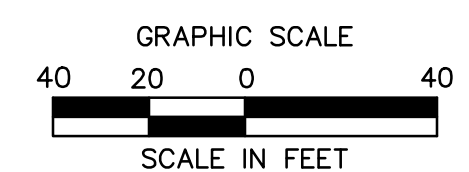

Freeman Companies, LLC. \\Server08\Engineers\2020\2020-0113 75C CM Sidewalk Project\_Hartford\DWG\Goshen Street.dwg May 13, 2020 - 2:39pm Plotted By: JLBR



**BID PACKAGE #5  
CITY OF HARTFORD  
SET-ASIDE PROGRAM  
ONLY CERTIFIED MWBE CONTRACTORS**

**LEGEND**

- APPROX. ROW
- CONTRACT LIMIT LINE
- [White Box] SIDEWALK/DRIVEWAY RAMP TO REMAIN
- [Diagonal Lines Box] SIDEWALK (STANDARD REPLACEMENT)
- [Cross-hatch Box] SIDEWALK (FULL DEPTH REPLACEMENT)
- [Dotted Box] NEW DRIVEWAY RAMP
- TREE

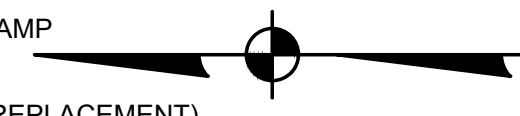

PREPARED FOR:  
CITY OF HARTFORD  
DEPT. OF PUBLIC WORKS  
50 JENNINGS ROAD  
HARTFORD, CT 06120



NO.	DATE	DESCRIPTION

**FREEMAN COMPANIES**  
AN ENGINEERING, ARCHITECTURAL, ENVIRONMENTAL & CONSTRUCTION SERVICES FIRM  
 DBE | DAS | MBE | GWASDC CERTIFIED  
 CIVIL | GEOTECHNICAL  
 SURVEY | ENVIRONMENTAL

FREEMAN COMPANIES, LLC  
 36 JOHN STREET  
 HARTFORD, CT 06106  
 WWW.FREEMANCOS.COM  
 TEL: (860) 231-9500  
 TOLL FREE: (800) 694-5141  
 FAX: (860) 986-7161

ELEVATE YOUR EXPECTATIONS

**SIDEWALK REPLACEMENT  
PHASE 1  
GOSHEN STREET  
HARTFORD, CT 06112**

DESIGNED: P.P.  
 DRAFTED: M.K./P.T.  
 CHECKED: P.P.  
 APPROVED: J.N.L.  
 SCALE: 1" = 40'  
 FC PROJECT NO.: 2020-0113  
 DATE: 05/04/2020

TITLE:  
**SIDEWALK PLAN**

SHEET NUMBER:  
**C-106**

**NOTES**

1. GOSHEN STREET WIDTH OF SIDEWALK = 5 FEET.
2. DIMENSIONS SHOWN ON PLANS ARE FOR INFORMATIONAL PURPOSES ONLY.
3. SIDEWALK CONSTRUCTION SEE DETAIL SHEET.
4. NEW DRIVEWAY RAMPS TO BE CONSTRUCTED PER DETAILS.
5. NEW SIDEWALK NEXT TO DRIVEWAY RAMPS TO REMAIN, SHALL BE DOWELED INTO EXISTING RAMPS, SEE DETAILS.
6. TREE REMOVAL TO BE BY CITY OR OTHERS.
7. ALL MERESTONES & MERESTONE COVERS TO BE PROTECTED DURING RECONSTRUCTION. DAMAGED OR MISSING COVERS SHALL BE REPLACED PER CITY STANDARDS.

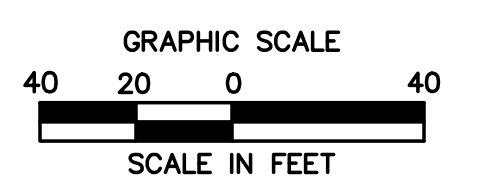

WATERFORD STREET

STANWOOD STREET



**BID PACKAGE #6  
CITY OF HARTFORD  
SET-ASIDE PROGRAM  
ONLY CERTIFIED MWBE CONTRACTORS**

**LEGEND**

- APPROX. ROW
- CONTRACT LIMIT LINE
- SIDEWALK/DRIVEWAY RAMP TO REMAIN
- SIDEWALK (STANDARD REPLACEMENT)
- SIDEWALK (FULL DEPTH REPLACEMENT)
- NEW DRIVEWAY RAMP
- TREE

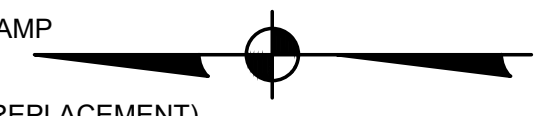

PREPARED FOR:  
CITY OF HARTFORD  
DEPT. OF PUBLIC WORKS  
50 JENNINGS ROAD  
HARTFORD, CT 06120



NO.	DATE	DESCRIPTION

**FREEMAN COMPANIES**  
DBE 1 DAS | MBE 1 GWASDC CERTIFIED  
 CIVIL | GEOTECHNICAL  
 SURVEY | ENVIRONMENTAL  
 FREEMAN COMPANIES, LLC  
 36 JOHN STREET  
 HARTFORD, CT 06106  
 WWW.FREEMANCOS.COM  
 TEL: (860) 231-9500  
 TOLL FREE: (800) 694-5141  
 FAX: (860) 986-7161

ELEVATE YOUR EXPECTATIONS

**SIDEWALK REPLACEMENT  
PHASE 1  
GOSHEN STREET  
HARTFORD, CT 06112**

DESIGNED: P.P.  
 DRAFTED: M.K./P.T.  
 CHECKED: P.P.  
 APPROVED: J.N.L.  
 SCALE: 1" = 40'  
 FC PROJECT NO.: 2020-0113  
 DATE: 05/04/2020

TITLE:  
**SIDEWALK PLAN**

SHEET NUMBER:  
**C-107**

**NOTES**

1. GOSHEN STREET WIDTH OF SIDEWALK = 5 FEET.
2. DIMENSIONS SHOWN ON PLANS ARE FOR INFORMATIONAL PURPOSES ONLY.
3. SIDEWALK CONSTRUCTION SEE DETAIL SHEET.
4. NEW DRIVEWAY RAMPS TO BE CONSTRUCTED PER DETAILS.
5. NEW SIDEWALK NEXT TO DRIVEWAY RAMPS TO REMAIN, SHALL BE DOWELED INTO EXISTING RAMPS, SEE DETAILS.
6. TREE REMOVAL TO BE BY CITY OR OTHERS.
7. ALL MERESTONES & MERESTONE COVERS TO BE PROTECTED DURING RECONSTRUCTION. DAMAGED OR MISSING COVERS SHALL BE REPLACED PER CITY STANDARDS.

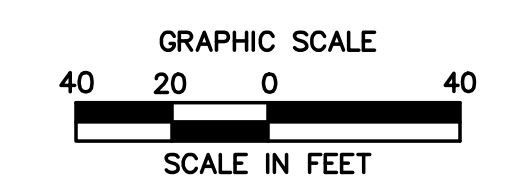

Freeman Companies, LLC. \\Server08\Engineering\2020\2020-0113 75C CM Sidewalk Project\_Hartford\DWG\Goshen Street.dwg May 14, 2020 - 10:57am Plotted By: jlehou



NO.	DATE	DESCRIPTION

DESIGNED:	P.P.
DRAFTED:	M.K./P.T.
CHECKED:	P.P.
APPROVED:	J.N.L.
SCALE:	1" = 4'
FC PROJECT NO.:	2020-0113
DATE:	05/04/2020

TITLE:  
**DETAILS**

SHEET NUMBER:  
**C-501**

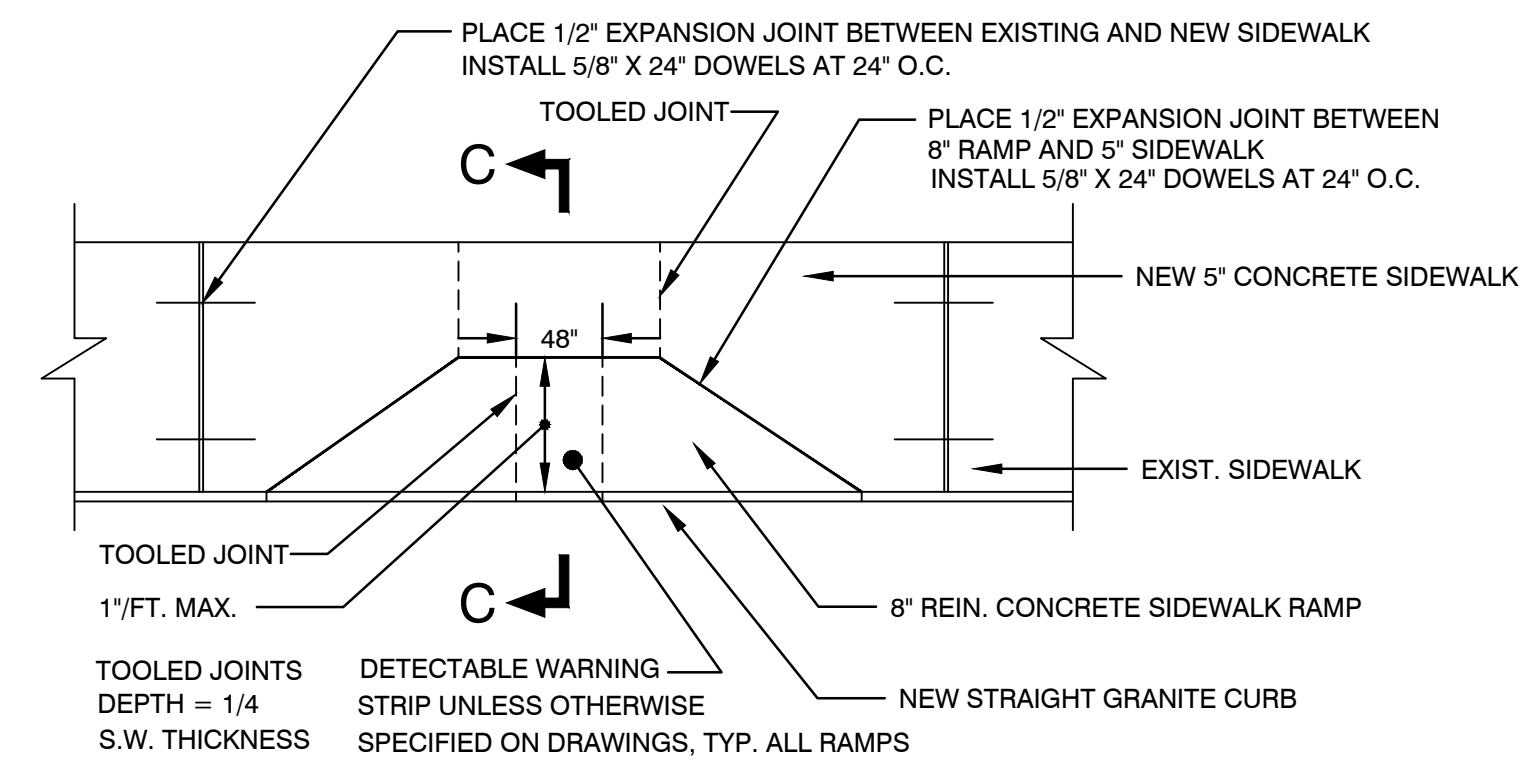

**SIDEWALK RAMP TYPE I**

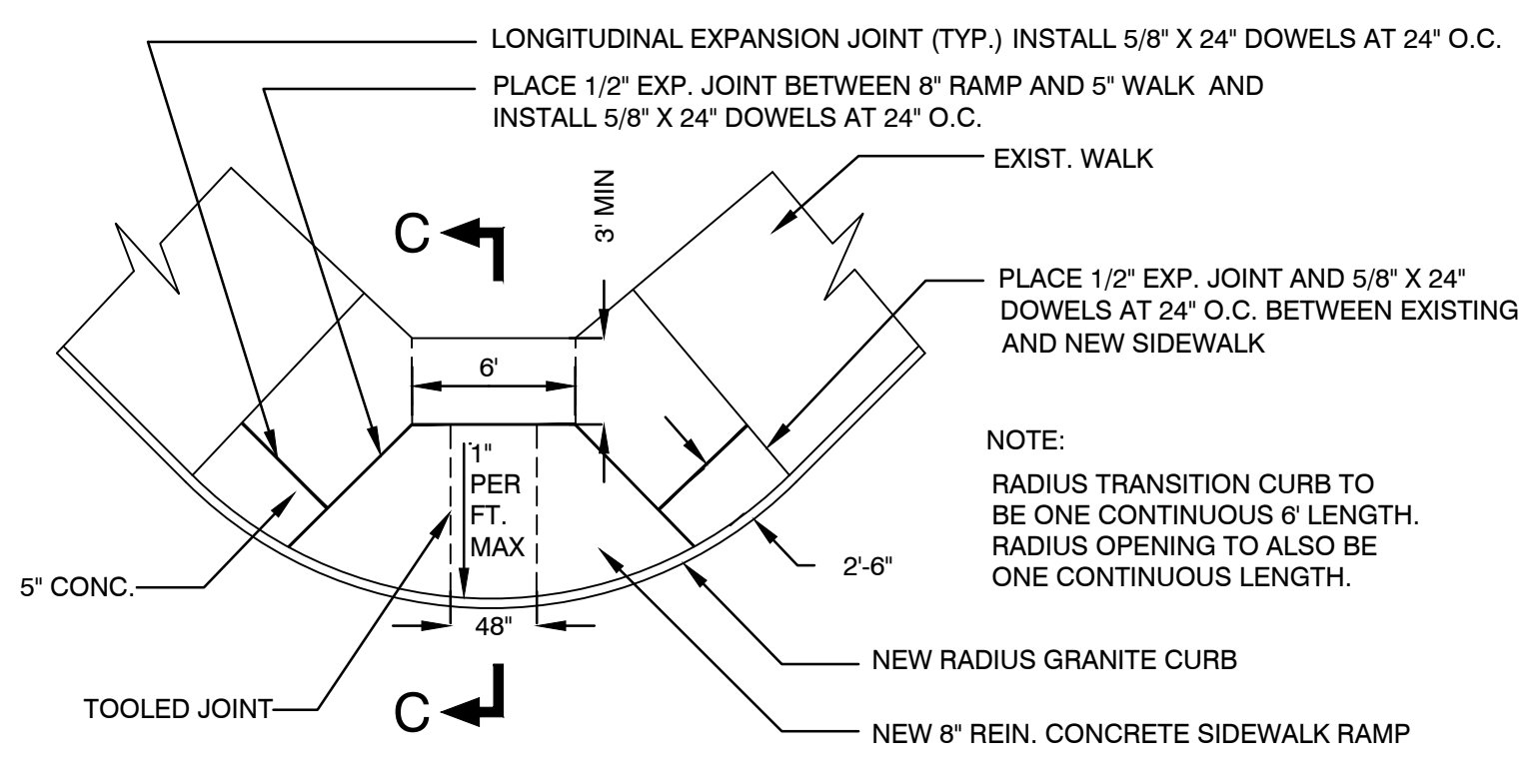

**SIDEWALK RAMP TYPE II**

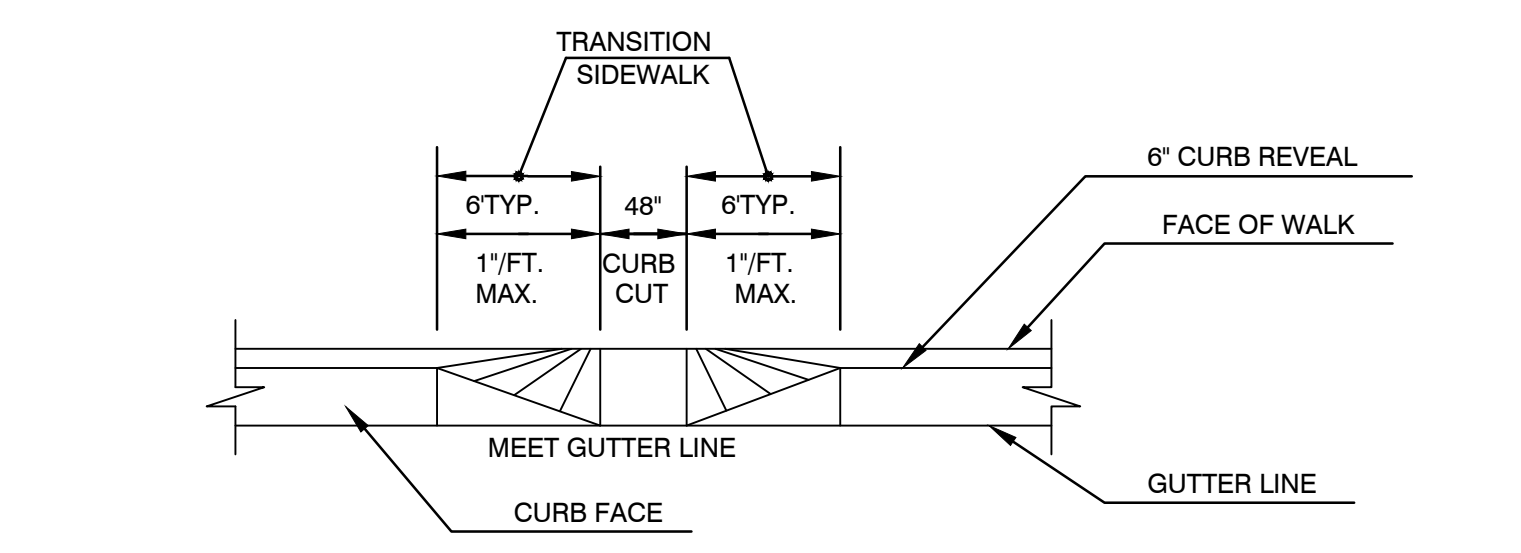

**ELEVATION**

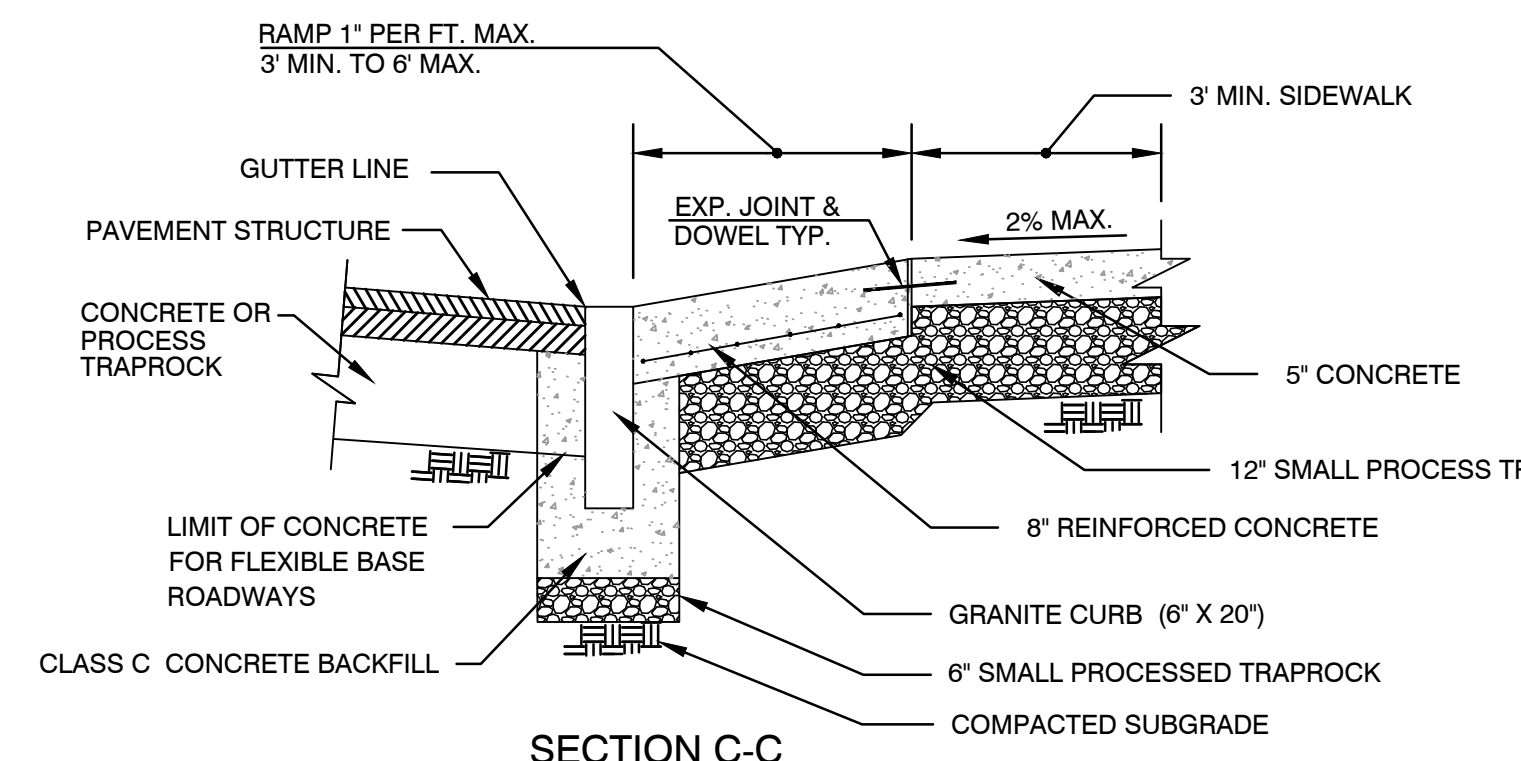

**SIDEWALK RAMP TYPE I, II**

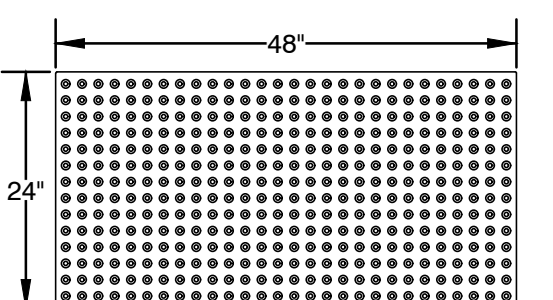

- NOTES:
1. DETECTABLE WARNING STRIP TO BE "ARMOR-TILE" BY ENGINEERED PLASTICS INC., OR APPROVED EQUAL.
  2. INSTALL DETECTABLE WARNING STRIP PER MANUFACTURER'S CAST IN PLACE INSTRUCTIONS.
  3. COLOR TO BE BRICK RED.

**DETECTABLE WARNING STRIP**

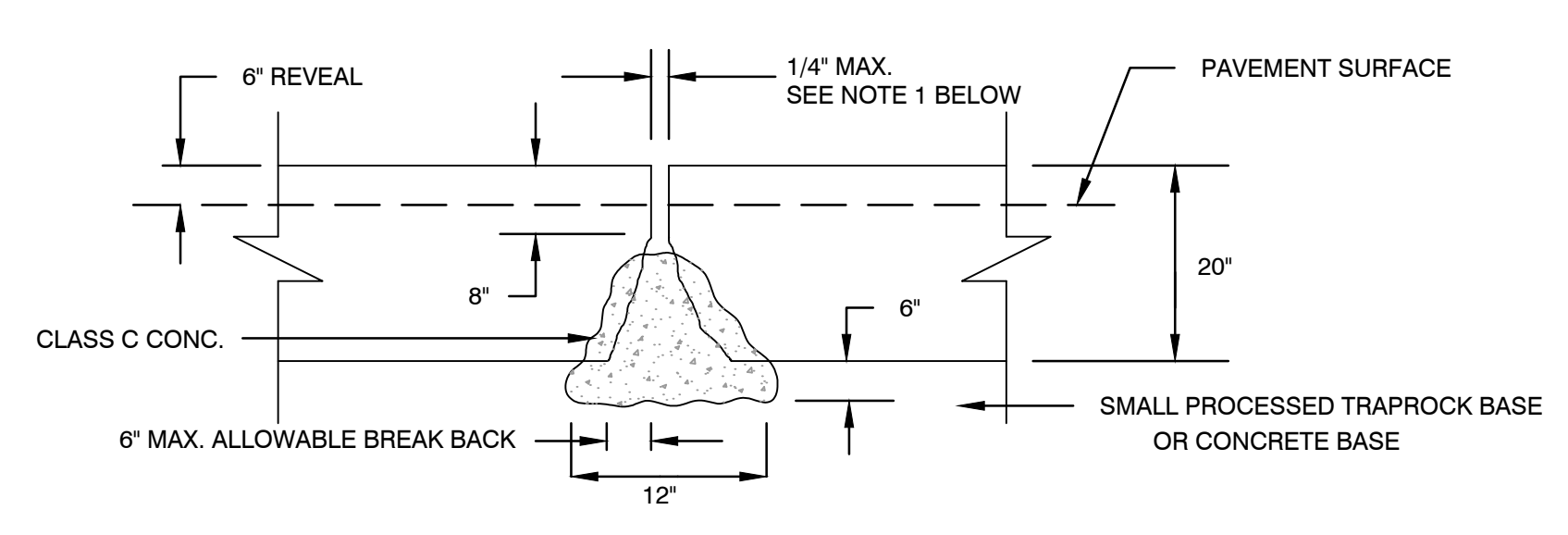

**ELEVATION**

**TYPICAL JOINT DETAIL FOR STRAIGHT GRANITE CURB**

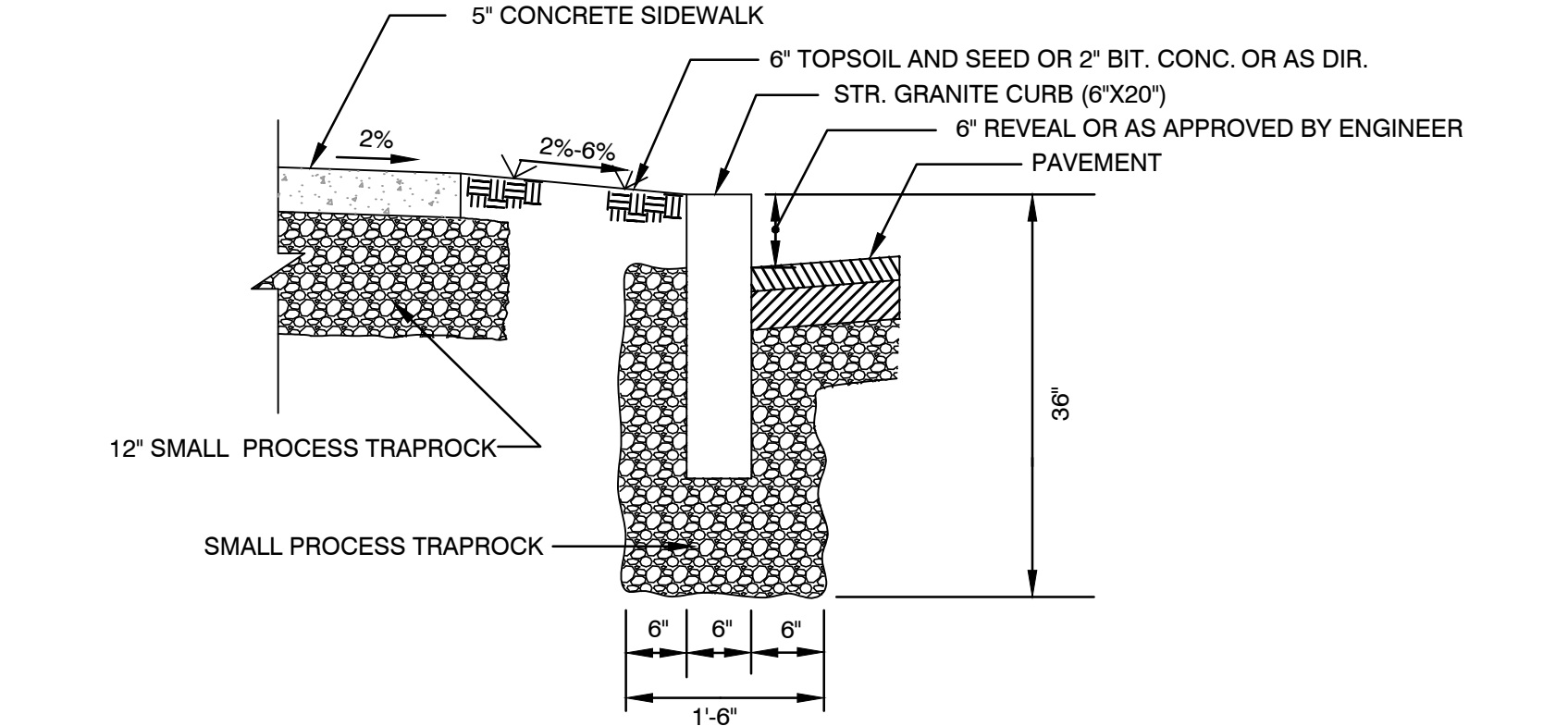

**STRAIGHT GRANITE CURB SECTION**

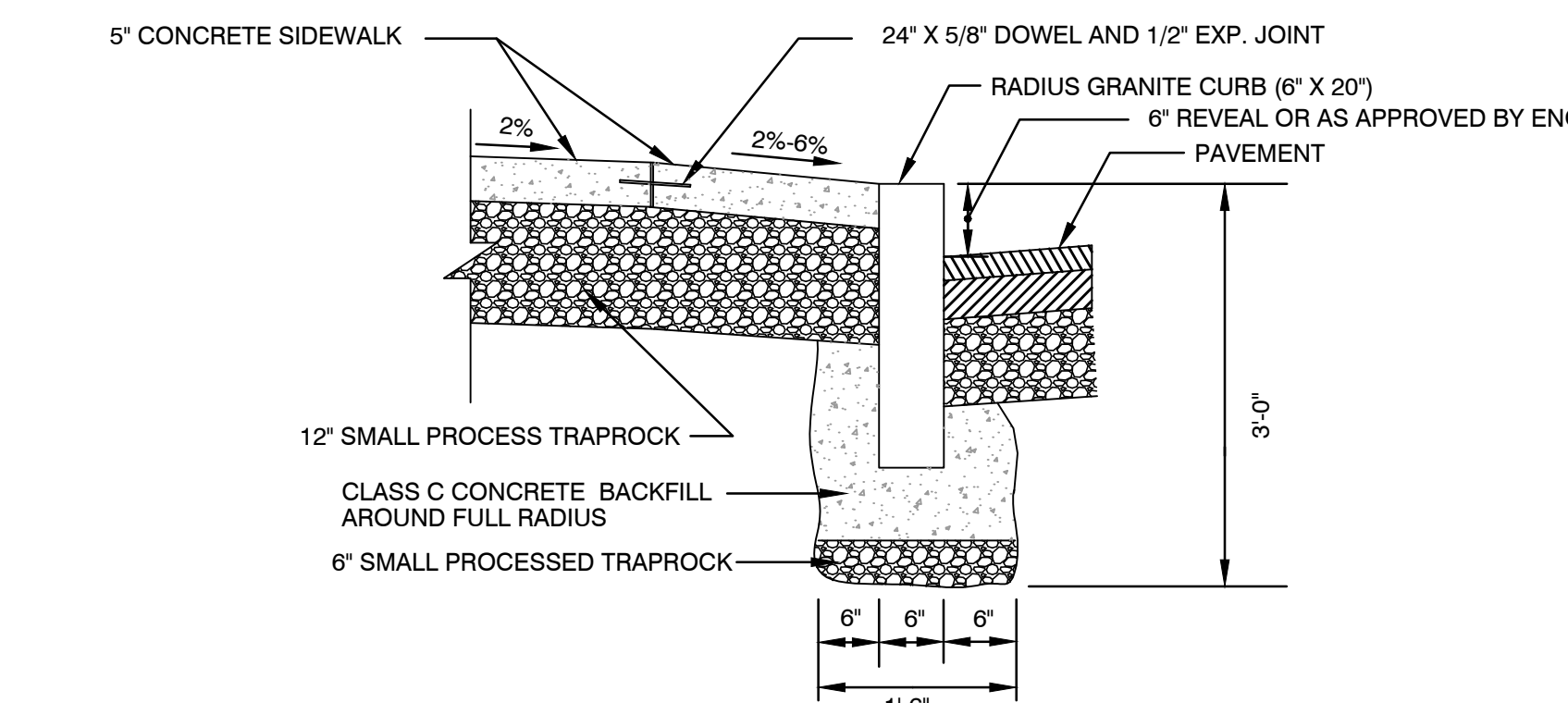

**RADIUS GRANITE CURB SECTION**

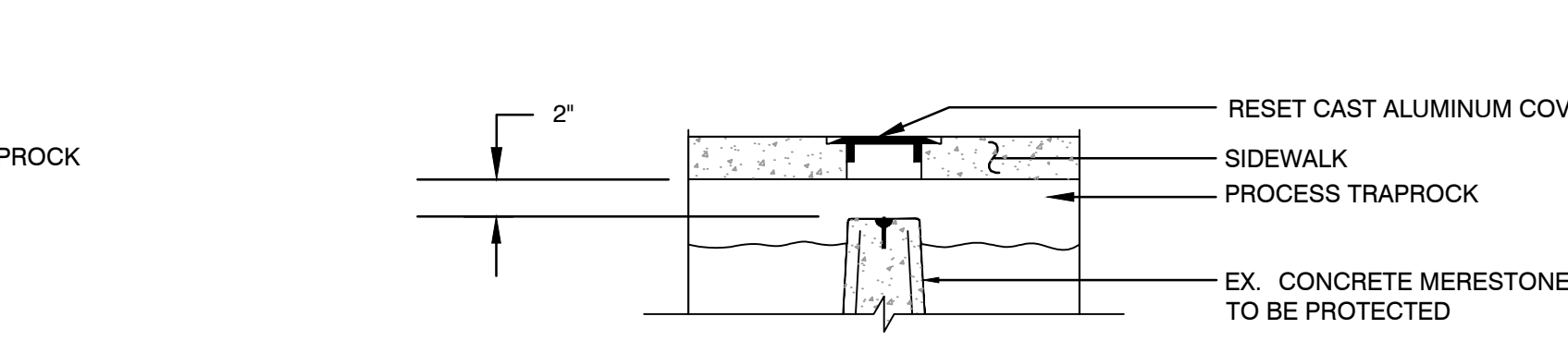

**CONCRETE MERESTONE**

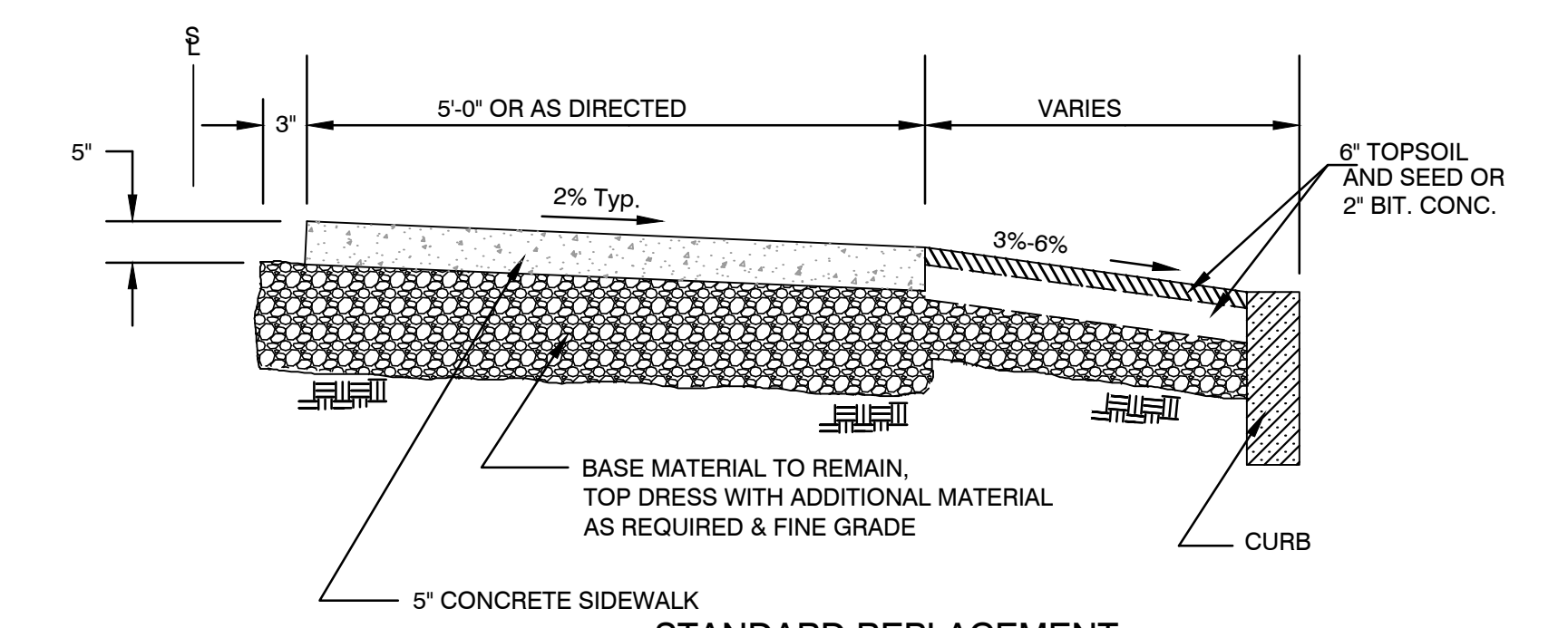

**STANDARD REPLACEMENT**

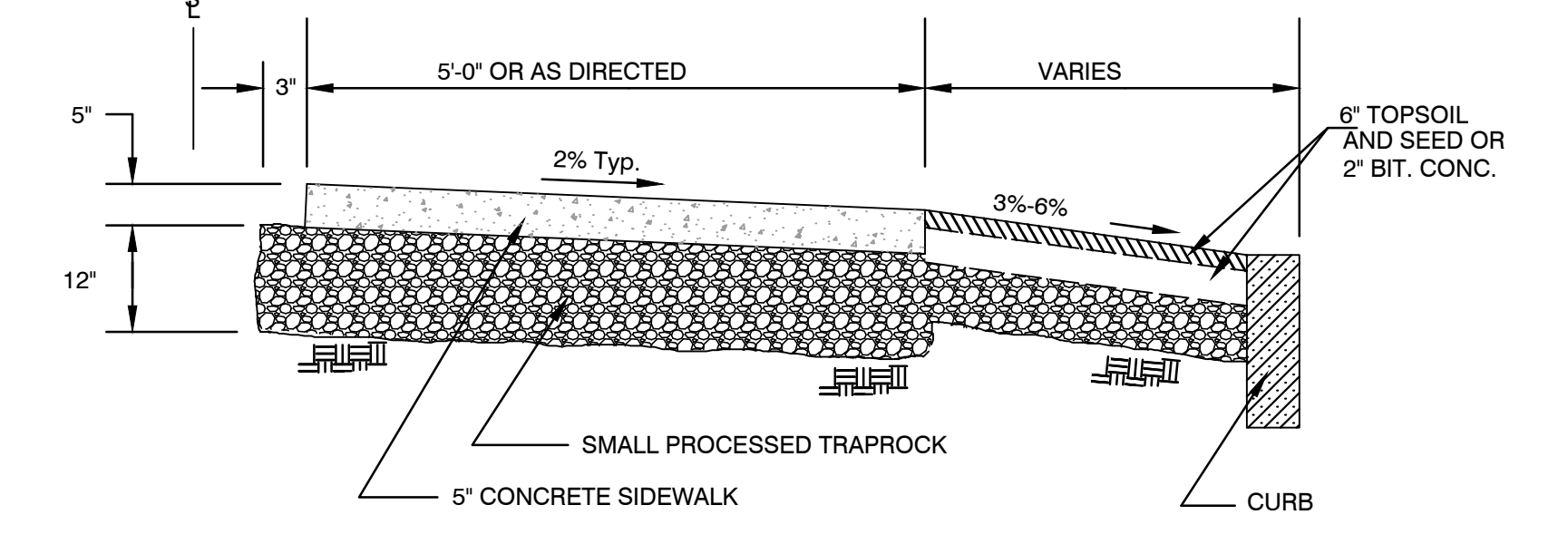

**FULL DEPTH REPLACEMENT**

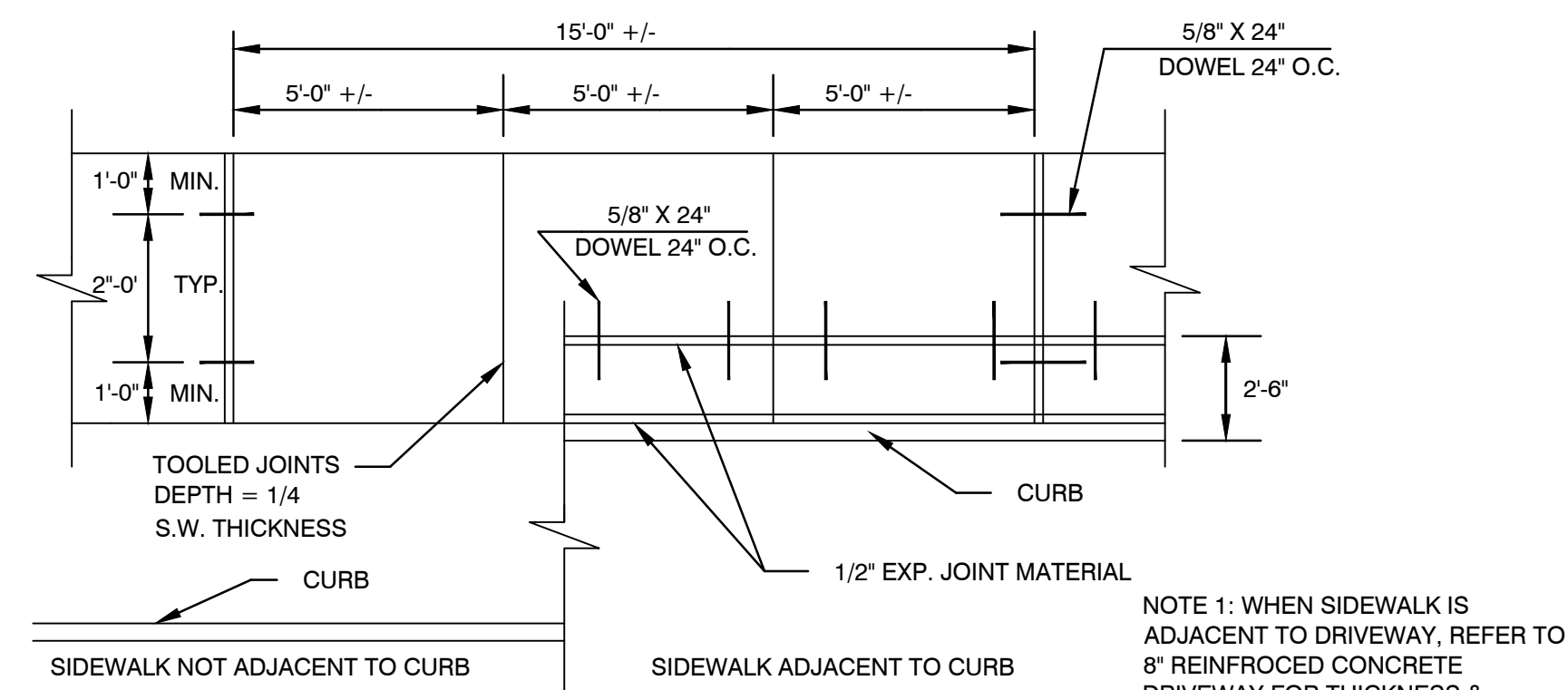

**5" CONCRETE SIDEWALK**

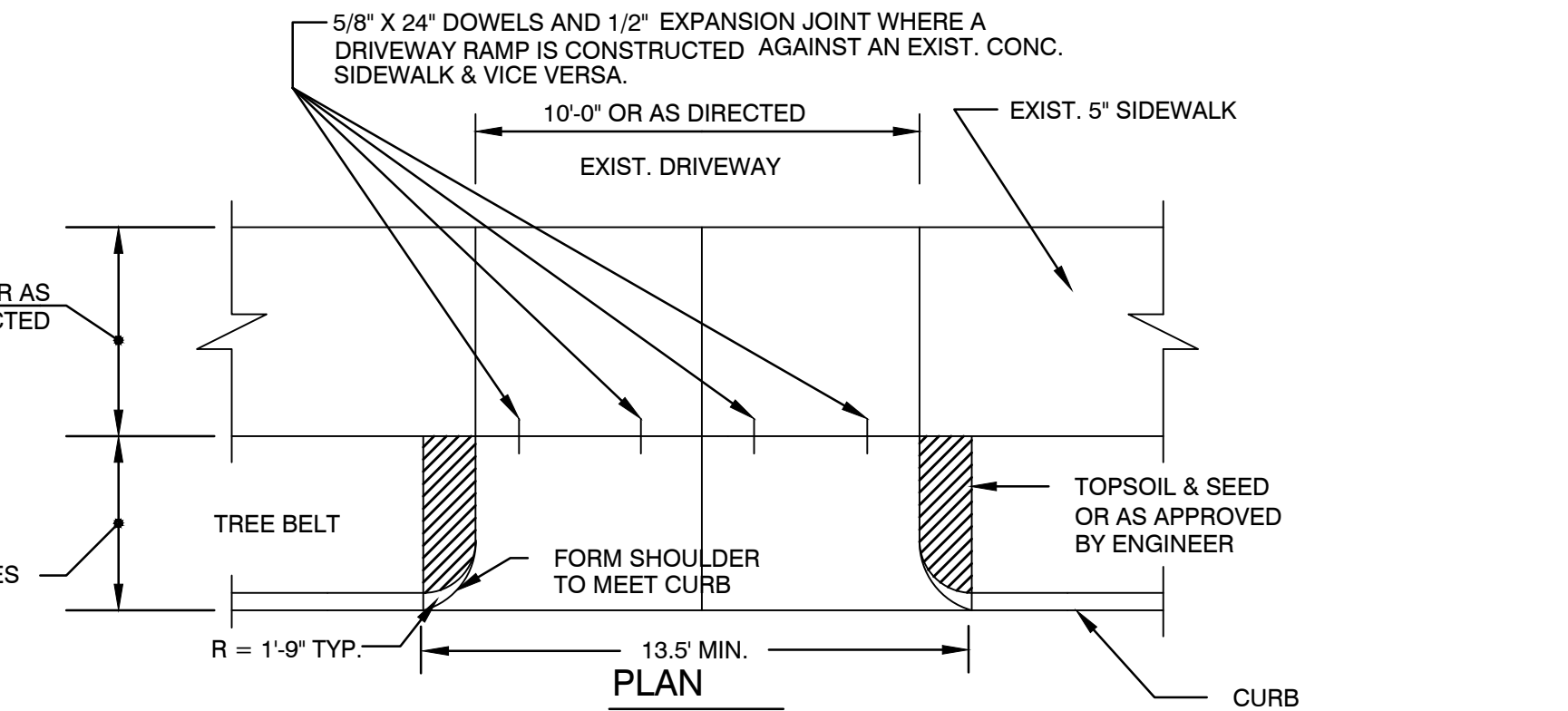

**PLAN**

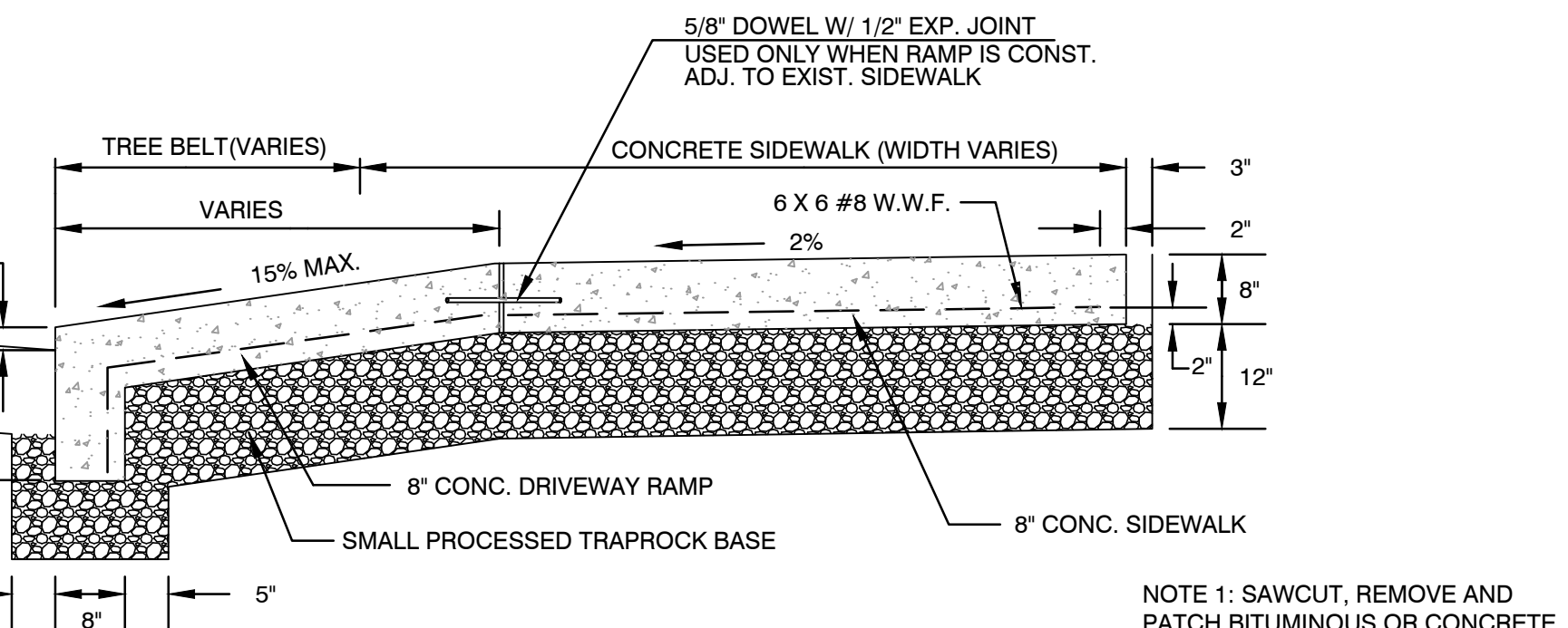

**SECTION**

**8" REINFORCED CONCRETE DRIVEWAY**

- NOTE 1: SAWCUT, REMOVE AND PATCH BITUMINOUS OR CONCRETE DRIVEWAY AS REQUIRED.