

TYPE 'C' CATCH BASIN TOP

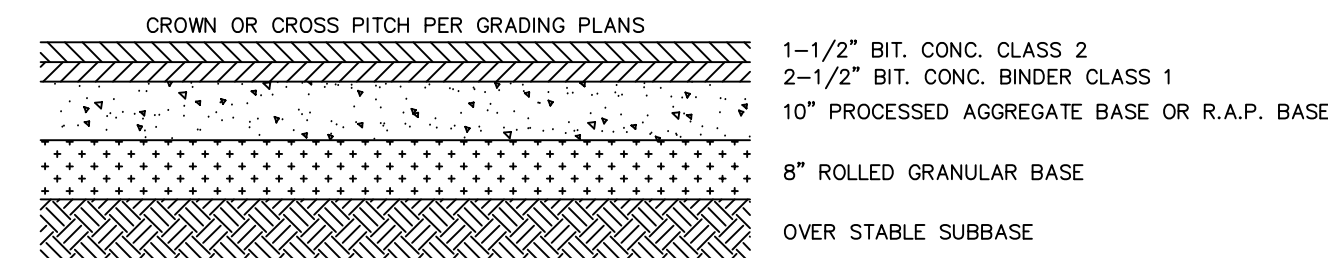

ACCESS DRIVE AND PARKING AREAS
BITUMINOUS PAVEMENT DETAIL



SIDEWALKS
BITUMINOUS PAVEMENT DETAIL

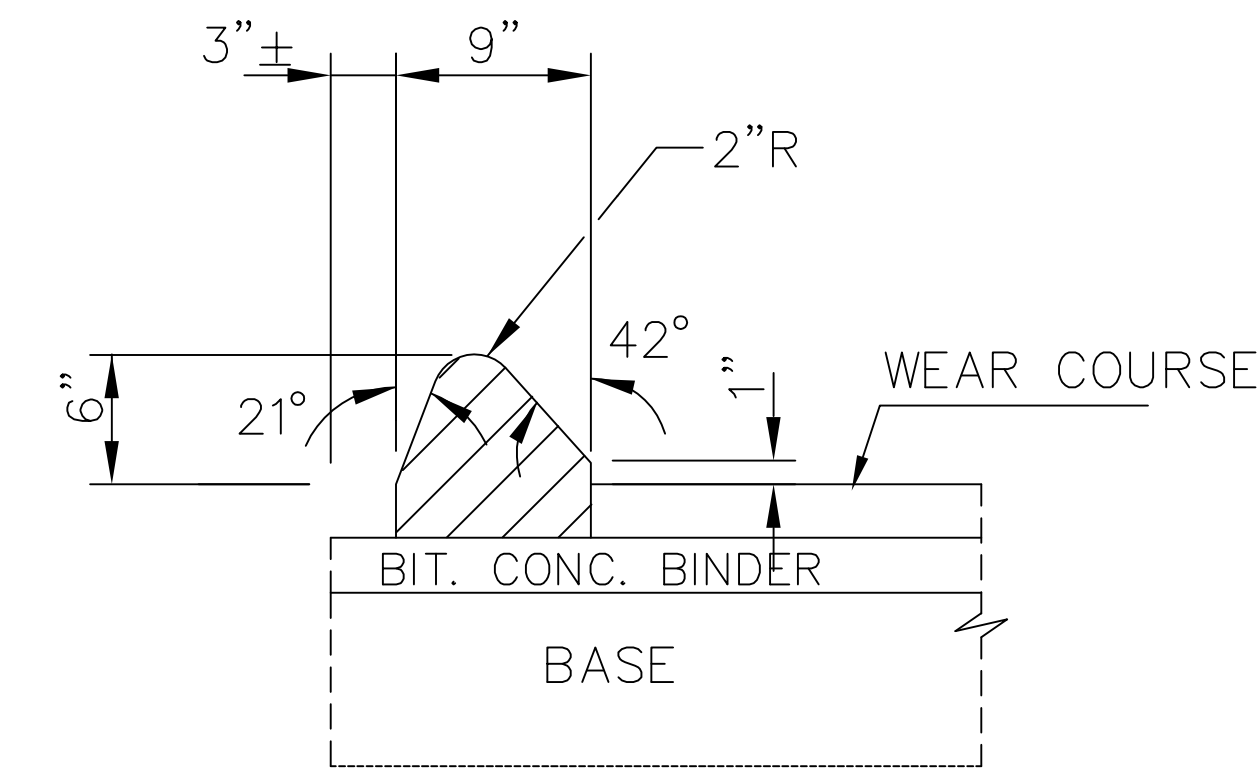

BITUMINOUS CONCRETE LIP CURB

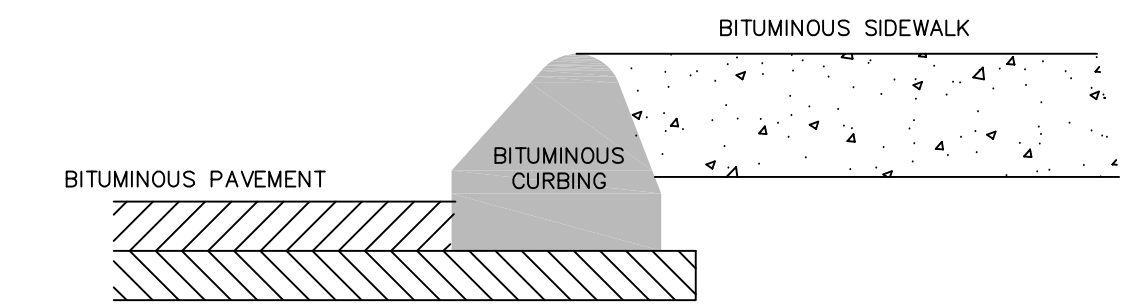

SIDEWALK ALONG CURB

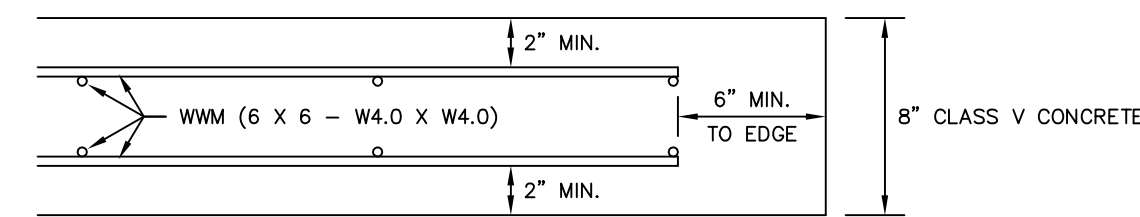

CONCRETE REINFORCEMENT

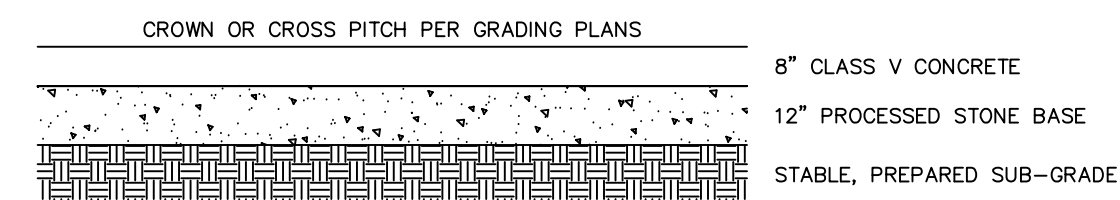

IF THE EXISTING SUBGRADE IS DEEMED UNSUITABLE
BY TOWN ENGINEERING STAFF, IT SHALL BE REPLACED
WITH 12" OF COMPACTED BANK RUN GRAVEL.

SECTION

CONCRETE DUMPSTER PAD

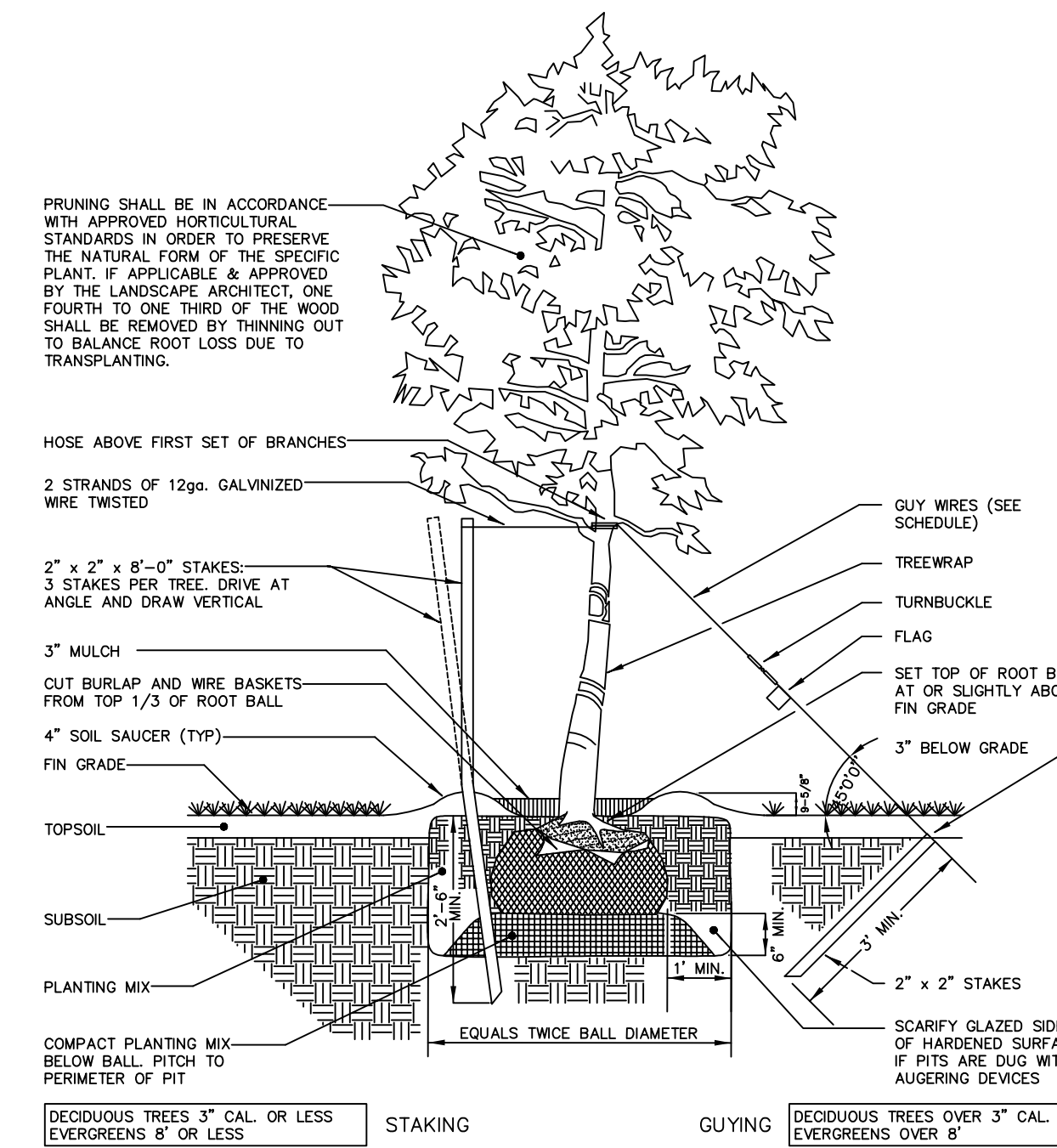

TREE PLANTING DETAILS

TO MY KNOWLEDGE AND BELIEF, THIS MAP IS
SUBSTANTIALLY CORRECT AS NOTED HEREON

BARRESI
ASSOCIATES LLC

570 HAYDEN STATION ROAD - UNIT D - WINDSOR, CT 06095
(860) 219-9260 www.barresilc.com

DATE	REVISION	SCALE: 1 IN = 40 FT	MARCH 25, 2019

CDBG SITE PLAN
PREPARED FOR
CHESTER HOUSING ASSOCIATES LP
218 MIDDLESEX AVENUE
CHESTER, CONNECTICUT