

August 7, 2019

Mr. Adam Fox, P.E.  
Principal Engineer  
Environmental Compliance Section  
Bureau of Engineering and Construction  
State of Connecticut Department of Transportation  
2800 Berlin Turnpike, P.O. Box 317546  
Newington, CT 06131-7546

Attention: Amie Maines, P.E. / Denise Young

Subject: On-Call Asbestos, Lead, Air Quality & Demolition Compliance  
Agreement No.: 8.07-01 (18)  
HazMat Inspection – Seventeen (17) District 3 Traffic Signal Intersections, Various  
Cities/Towns, CT  
ConnDOT Assignment No. 519-5853  
ConnDOT Project No. 173-468  
TRC Project No. 289951.5853.0710

Dear Mr. Fox:

TRC performed a limited survey for hazardous building materials associated with traffic signals and pedestrian control equipment at 17 Traffic Signal Intersection Sites in 10 cities/towns (Bridgeport, East Haven, Fairfield, Madison, Milford, New Haven, North Haven, Stratford, West Haven & Westport) in District 3, Connecticut. Results of the survey identified the following

- Lead paint is **presently presumed** on various metal traffic components (i.e. span poles, pedestrian crosswalk push button & hoods, traffic lights themselves and control cabinets) at Intersection Nos. 015-267, 043-221, 050-201, 050-207, 075-204, 075-220, 083-237, 08-244, 092-241, 092-242, 100-205, 138-201, 138-250, 138-276, 156-212, 156-218 & 158-213.
- Any paint waste generated from the lead painted metal traffic components at the Intersection Sites listed above should be tested for TCLP lead to determine proper waste disposal (hazardous vs. non-hazardous).
- All the Intersection Sites had traffic span poles that were either galvanized metal (unpainted) or wood (unpainted) except for Intersection Nos. 43-221 (all green painted span poles) & 50-207 (1 grey painted span pole).
- All Intersection Sites that had pedestrian pedestals were found to be galvanized (unpainted).
- At Intersection No. 75-204, the controller cabinet was found to be galvanized (unpainted).

Potential universal waste (UW) and Connecticut Regulated Waste (CRW) items associated with the traffic lights themselves, crosswalk signal hoods/buttons and controller cabinets (i.e. Hg lamps/PCB ballasts and/or printed circuit boards) are also likely present at the Intersection Sites.

Inspector notes, TRC Mobile Data Solutions report & project description information are attached.

If you have any questions, please call TRC at (860) 298-9692.

Very Truly Yours,

TRC

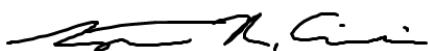

Stephen R. Arienti, CHMM  
Senior Project Manager – Program Manager

Reviewed By:

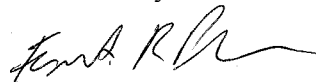

Erik R. Plimpton, P.E., CHMM, CMC  
Vice President – Engineer in Charge

**List of Locations in Project #0173-0468:**

<u>TOWN</u>	<u>INT. #</u>	<u>DESCRIPTION</u>	<u>INSTALLATION TYPE</u>
Bridgeport ✓	015-267	S.R. 730 (Huntington Tpke) at Broadbridge Rd.	Replace pedestrian signal equipment
East Haven ✓	043-221	Rte 100 (Main St.) at Rte 100 (High St.), Main St., and Thompson Ave.	Replace pedestrian signal equipment
Fairfield ✓	050-201	U.S. Rte 1 (Post Rd.) at Rte 135 (N. Benson Rd.) and S. Benson Rd.	Replace traffic control signal equipment
Fairfield ✓	050-207	U.S. Rte 1 (Post Rd.) at Ruane St.	Replace traffic control signal equipment
Madison ✓	075-204	U.S. Rte 1 (Boston Post Rd.) at E. Wharf Rd. and Scotland Ave.	Replace traffic control signal equipment
Madison	075-220	U.S. Rte. 1 (Boston Post Rd.) at Samson Rock Rd. and Wall St.	Replace traffic control signal equipment
Milford ✓	083-237	Rte. 162 (S. Broad St./New Haven Ave.) at N. Broad St., River St., and Factory Ln.	Replace pedestrian signal equipment
Milford ✓	083-244	Rte. 162 (New Haven Ave.) at Prospect St. and Shipyard Ln.	Replace pedestrian signal equipment
New Haven ✓	092-241	Rte. 80 (Foxon Blvd.) at Rte. 103 (Quinnipiac Ave.) and Quinnipiac Ave.	Replace traffic control signal equipment
New Haven ✓	092-242	Rte. 80 (Foxon Blvd.) at Eastern St.	Replace traffic control signal equipment
North Haven ✓	100-205	U.S. Rte. 5/Rte. 103 (Washington Ave.) at U.S. Rte 5/Rte. 22 (Bishop St.) and Rte. 22 (Clintonville Rd.)	Replace traffic control signal equipment
Stratford ✓	138-201	U.S. Rte. 1 (Boston Ave.) at Bruce Ave.	Replace traffic control signal equipment
Stratford ✓	138-250	Rte. 110 (E. Main St.) at Drives for Dock S.C. and Stratford Retailers Condos	Replace traffic control signal equipment
Stratford ✓	138-276	U.S. Rte 1 (Barnum Ave.) at Soundview Ave. and Mary Ave. #2	Replace traffic control signal equipment
West Haven ✓	156-212	Rte. 162 (Wagner Pl./Saw Mill Rd.) at Elm St.	Replace pedestrian signal equipment
West Haven ✓	156-218	Rte. 162 (Jones Hill Rd.) at Colonial Blvd. and Morgan Ln.	Replace traffic control signal equipment
Westport ✓	158-213	U.S. Rte. 1 (State St. East) at Taylor Pl. and Main St.	Replace traffic control signal equipment

PP  
136 WASHINGTON AVE  
NORTH HAVEN

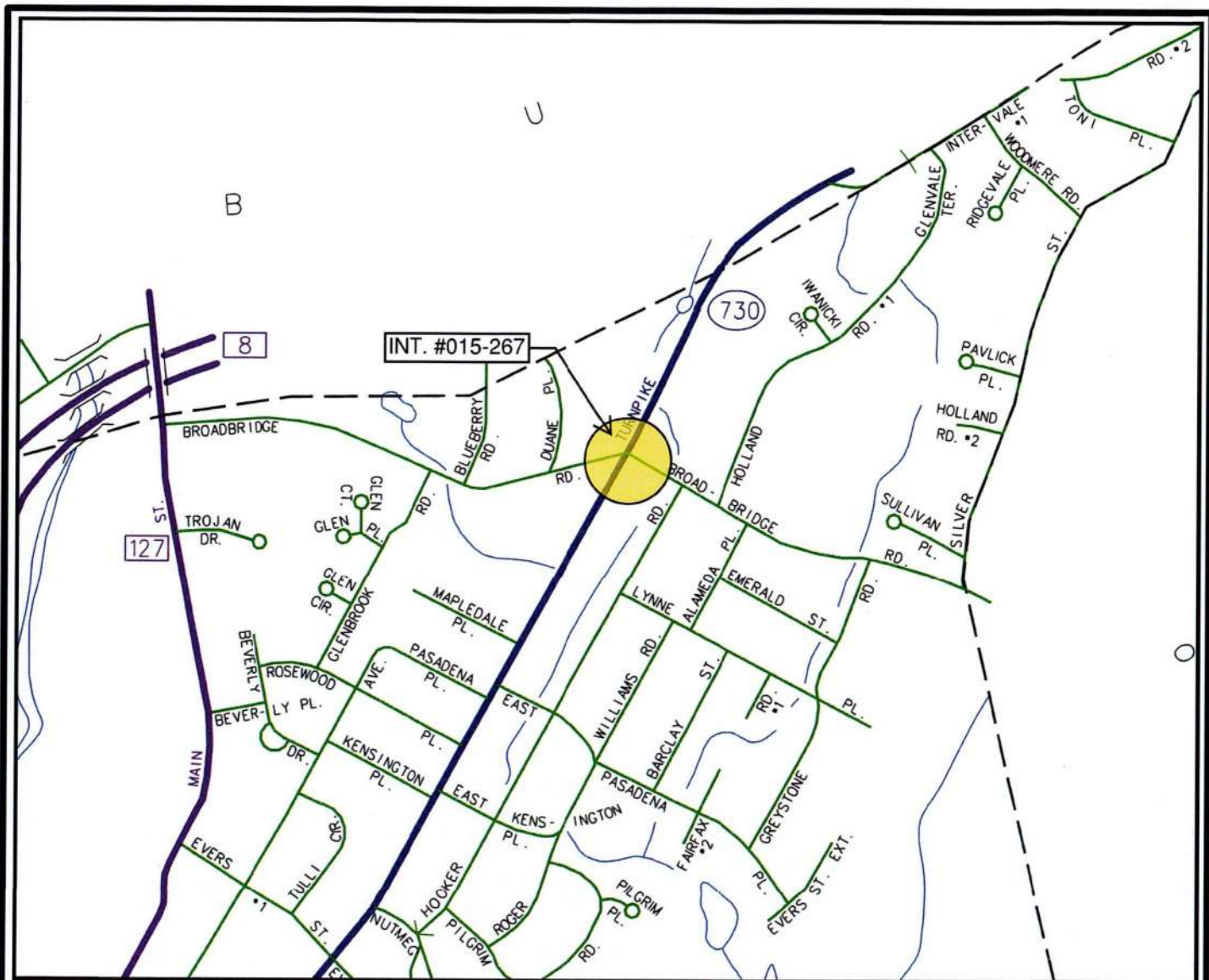

- 10 GREEN PAINTED TRAFFIC SIGNALS
- 1 LARGE UNPAINTED GALVANIZED POLE
- 2 SHORT ALUMINUM TRAFFIC LIGHT POLES
- 2 GREEN PAINTED PUSH BUTTON BOXES
- 1 GREY PAINTED CONTROL BOX

SCALE - NONE

STATE OF CONNECTICUT  
 DEPARTMENT OF TRANSPORTATION  
 BUREAU OF ENGINEERING & CONSTRUCTION  
 DIVISION OF TRAFFIC ENGINEERING

PROJECT NO. 0173-0468  
 INT. #015-267  
 CITY OF BRIDGEPORT  
 S.R. 730 (HUNTINGTON TURNPIKE) AT  
 BROADBRIDGE ROAD

- NO ACM SUSPECTS

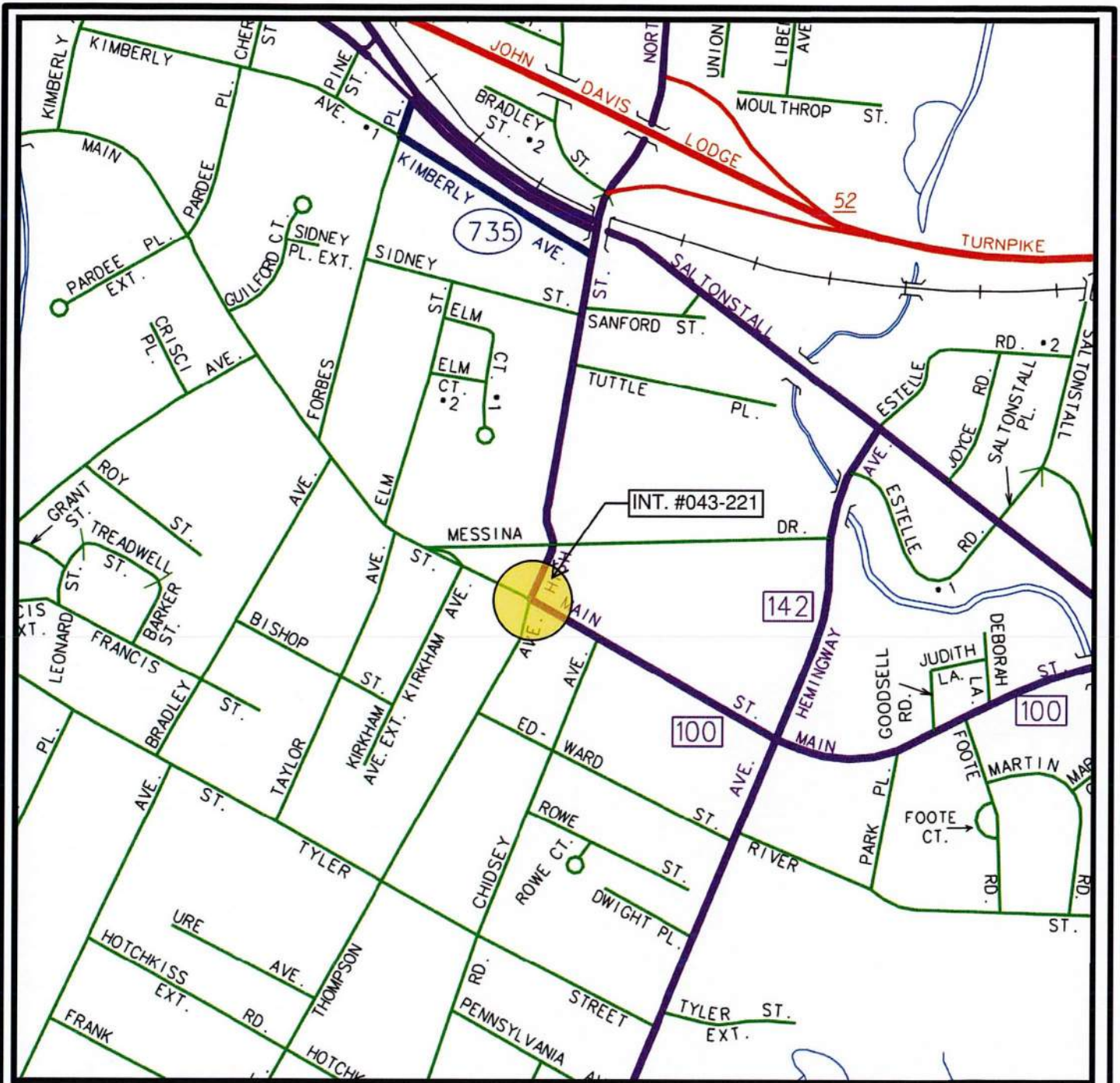

- 4 large upright poles (green)
- 8 traffic signals (green)
- 4 push box buttons (green)
- 8 cross walk signals (green)
- 1 control box (grey)
- No suspect ACM

SCALE - NONE

<p><b>STATE OF CONNECTICUT</b>          DEPARTMENT OF TRANSPORTATION          BUREAU OF ENGINEERING &amp; CONSTRUCTION          DIVISION OF TRAFFIC ENGINEERING</p>
<p>PROJECT NO. 0173-0468          INT. #043-221          TOWN OF EAST HAVEN          RTE. 100 (MAIN ST.) AT RTE. 100 (HIGH ST.),          MAIN ST. AND THOMPSON AVE.</p>

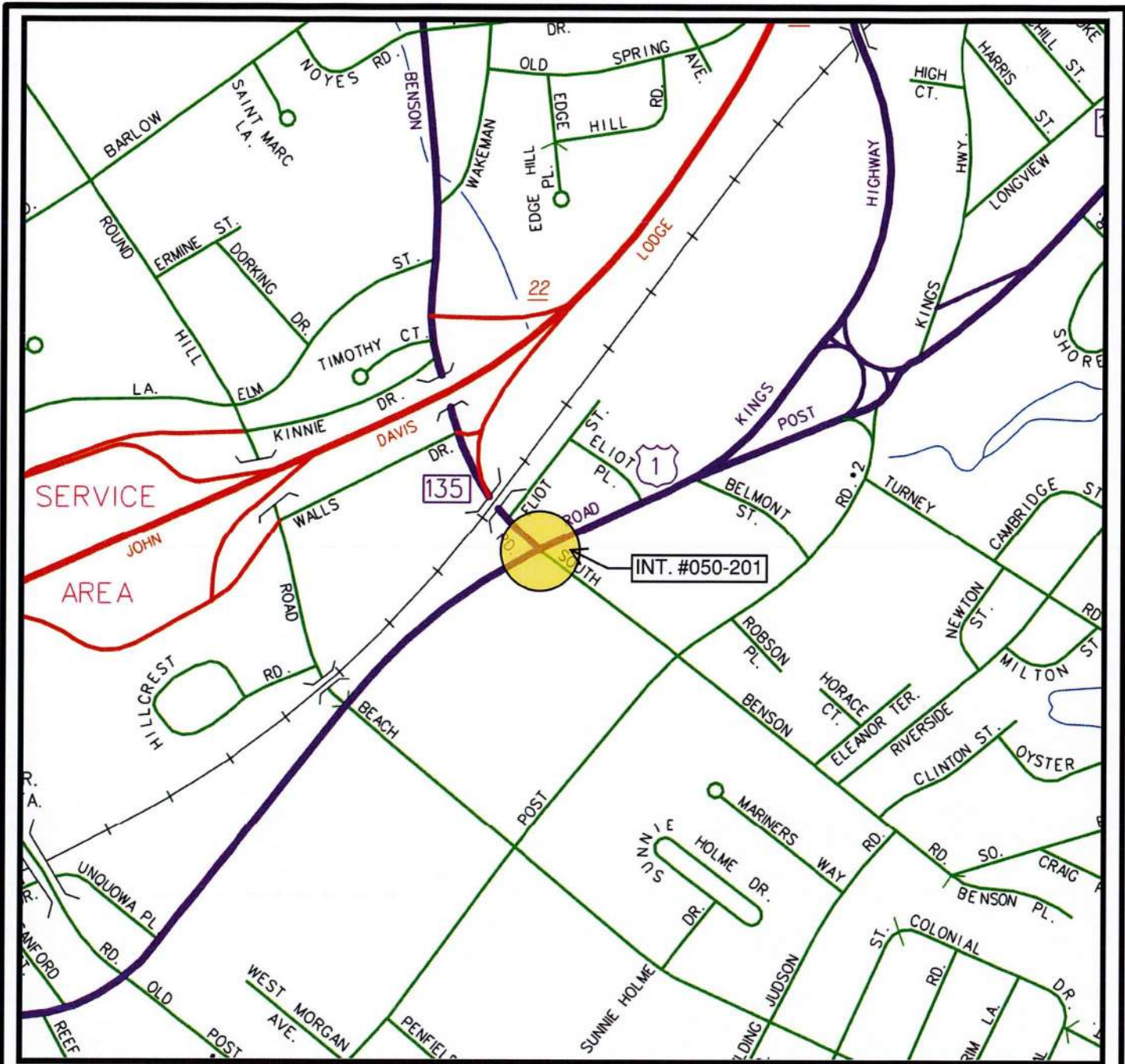

- 9 YELLOW PAINTED TRAFFIC LIGHTS
- 1 GRAY PAINTED CONTROL BOX
- 1 LARGE GALVANIZED POLE
- 4 YELLOW PAINTED TRAFFIC SIGNALS
- 4 YELLOW PUSH BUTTON BOXES
- 3 ALUMINUM UNPAINTED WALK SIGN POLES
- NO ACM SUSPECTS

SCALE - NONE

**STATE OF CONNECTICUT**  
 DEPARTMENT OF TRANSPORTATION  
 BUREAU OF ENGINEERING & CONSTRUCTION  
 DIVISION OF TRAFFIC ENGINEERING

---

PROJECT NO. 0173-0468  
 INT. #050-201  
 TOWN OF FAIRFIELD  
 U.S. RTE 1 (POST RD.) AT RTE. 135 (N. BENSON RD.)  
 AND S. BENSON RD.

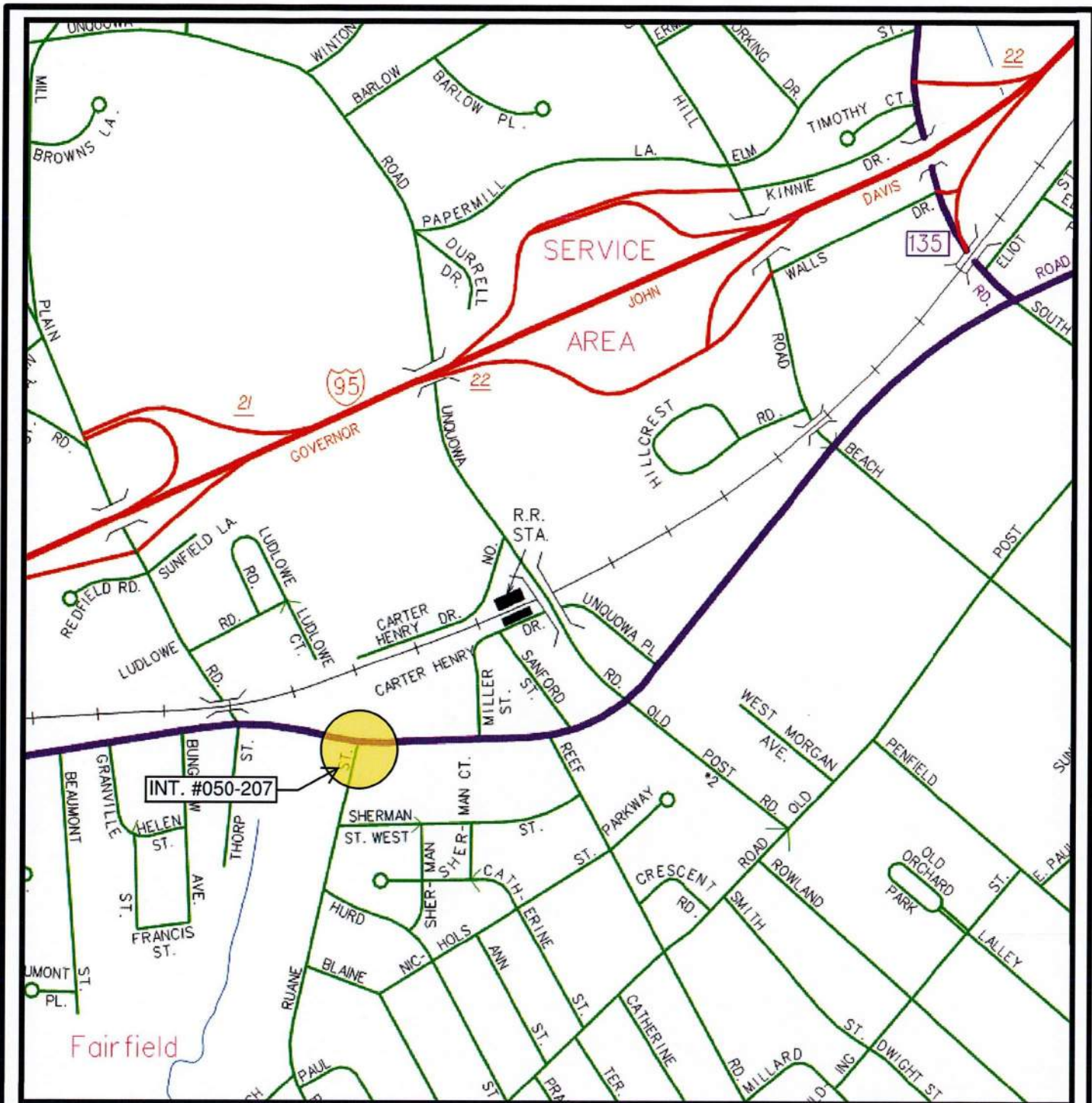

- 2 SHORT ALUMINUM POLES
- 2 GREEN WALK SIGNAL BOXES  
PAINT
- 7 GREEN PAINTED TRAFFIC SIGNALS
- 1 GREY CONTROL BOX  
PAINT
- 1 ~~GREEN~~ LARGE POLE (← GREY PAINT)
- 2 GREEN PUSH BUTTON BOXES
- NO ACM SUSPECTS

SCALE - NONE

STATE OF CONNECTICUT  
 DEPARTMENT OF TRANSPORTATION  
 BUREAU OF ENGINEERING & CONSTRUCTION  
 DIVISION OF TRAFFIC ENGINEERING

PROJECT NO. 0173-0468  
 INT. #050-207  
 TOWN OF FAIRFIELD  
 U.S. RTE 1 (POST RD.) AT RUANE ST.

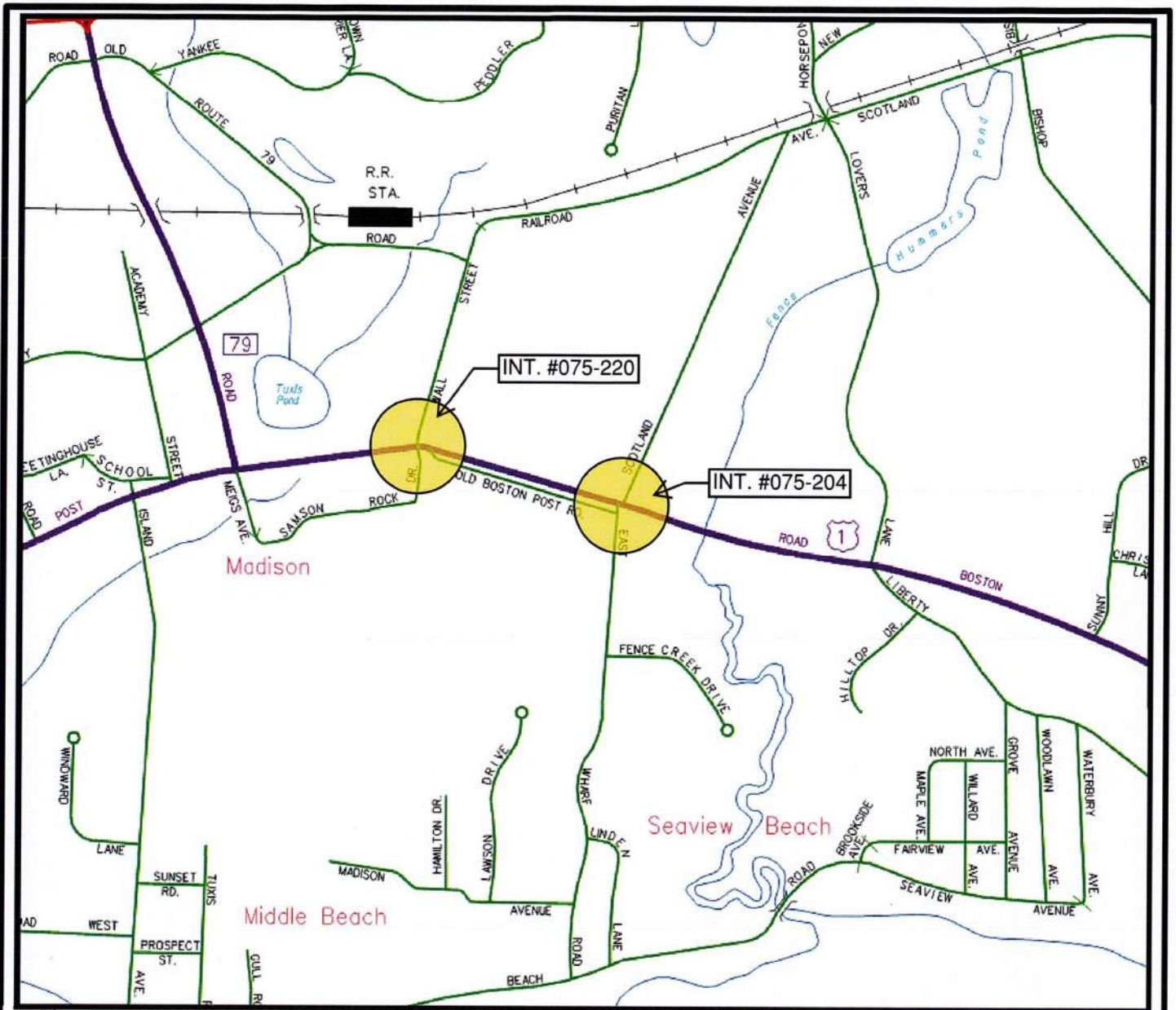

- 204/0 YELLOW/GREEN TRAFFIC LIGHTS  
 2 YELLOW CROSSING SIGNALS  
 2 YELLOW PUSH BOTTOM BOXES  
 1 LARGE GALVANIZED LIGHT POLE  
 1 SMALL ALUMINUM CROSS SIGN POLE  
 1 GREY METAL UNPAINTED CONTROL BOX

- 220/9 YELLOW/BLACK TRAFFIC LIGHTS  
 3 YELLOW CROSSING SIGNALS  
 4 BLACK CROSSING SIGNALS ON BLACK POLES  
 2 ALUMINUM SHIRT CROSS POLES  
 1 LARGE GALVANIZED POLE

3/4 GREEN PUSH BOTTOM BOXES

SCALE - NONE

STATE OF CONNECTICUT  
 DEPARTMENT OF TRANSPORTATION  
 BUREAU OF ENGINEERING & CONSTRUCTION  
 DIVISION OF TRAFFIC ENGINEERING

PROJECT #0173-0468: INT. #075-204 & #075-220  
 TOWN OF MADISON  
 U.S. RTE 1 (BOSTON POST RD.) AT E. WHARF RD. AND SCOTLAND AVE.;  
 U.S. RTE 1 (BOSTON POST RD.) AT SAMSON RD. AND WALL ST.

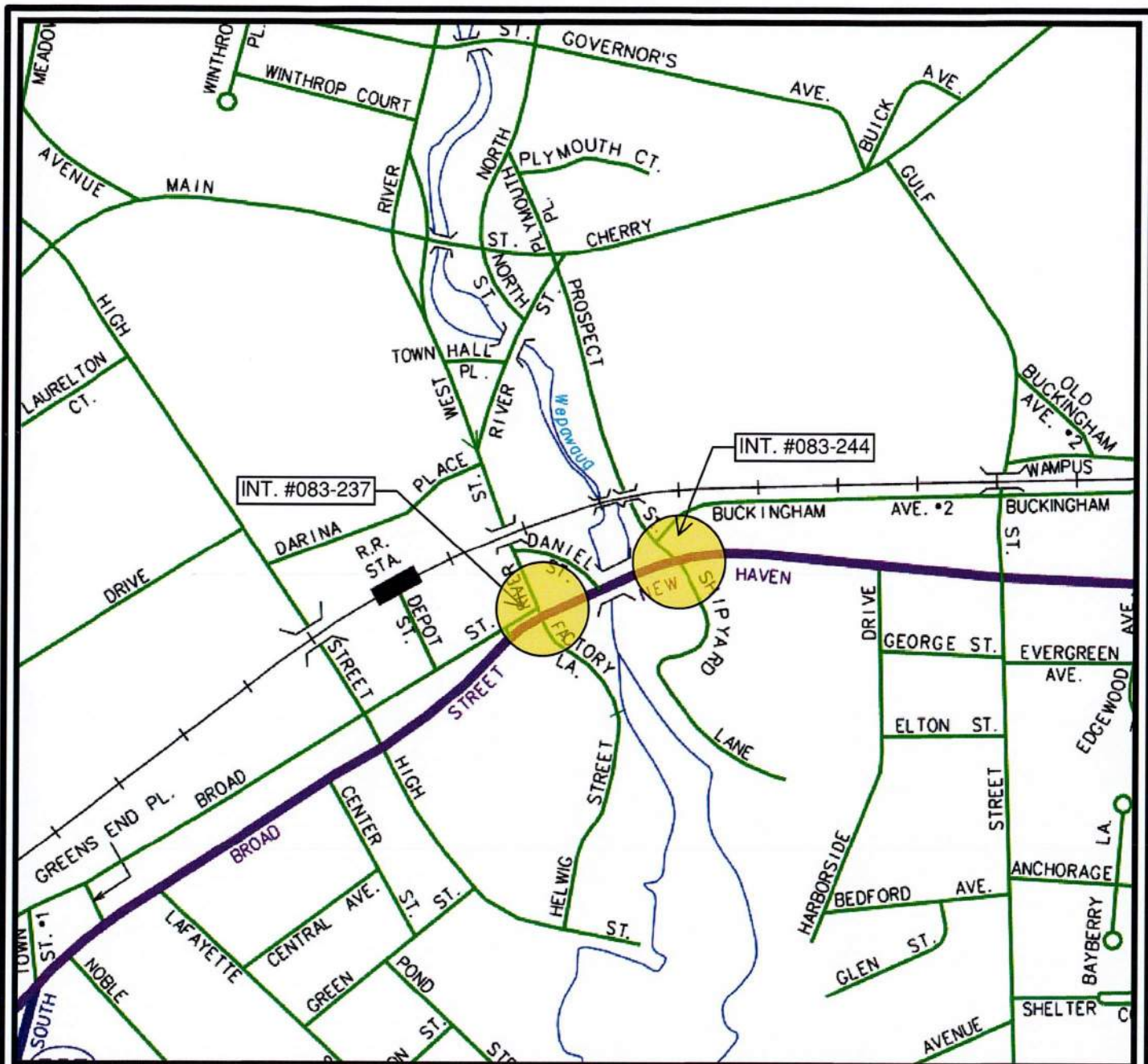

- 237
- 3 large / 1 small unpainted galv poles
  - 4 green/yellow push button boxes
  - 8 green cross walk lights
  - 7 green traffic lights
  - 1 grey control box

- 244
- 6 green cross walk signals
  - 2 large unpainted galv poles
  - 7 green Traffic lights
  - 1 short alum unpainted pole
  - 3 green push box buttons
- No ACM
- SCALE - NONE

**STATE OF CONNECTICUT**  
 DEPARTMENT OF TRANSPORTATION  
 BUREAU OF ENGINEERING & CONSTRUCTION  
 DIVISION OF TRAFFIC ENGINEERING

PROJECT NO. 0173-0468; INT. #083-237 & #083-244  
 CITY OF MILFORD  
 RTE. 162 (S. BROAD ST./NEW HAVEN AVE.) AT  
 N BROAD ST./RIVER ST./FACTORY LN.;  
 RTE. 162 (NEW HAVEN AVE.) AT  
 PROSPECT ST. AND SHIPYARD LN.



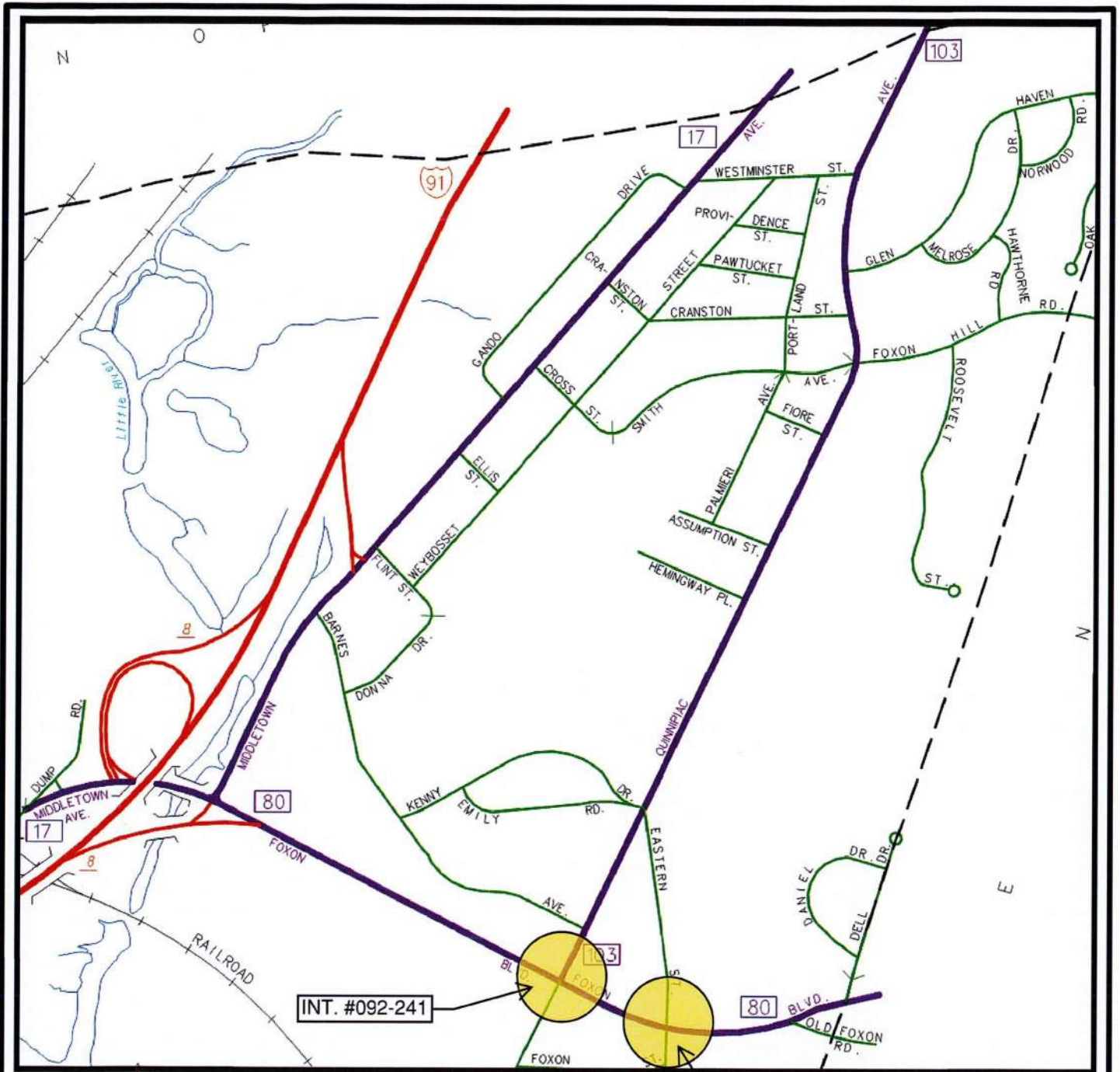

92-241

- No ACM

- 5 Traffic lights (yellow/black)
- 2 large galvanized poles / 2 short gal (unpainted)
- 1 control box (grey)
- 8 cross walk signals (yellow/black/green)
- 4 push button boxes (yellow)

INT. #092-242

- No ACM

- 2 short / 2 large galvanized poles
- 4 cross walk signals (yellow/green)
- 8 traffic lights (yellow, 1 green)

SCALE - NONE

**STATE OF CONNECTICUT**  
 DEPARTMENT OF TRANSPORTATION  
 BUREAU OF ENGINEERING & CONSTRUCTION  
 DIVISION OF TRAFFIC ENGINEERING

---

PROJECT NO. 0173-0468: INT. #092-241 & #092-242  
 CITY OF NEW HAVEN  
 RTE. 80 (FOXON BLVD.) AT  
 RTE. 103 (QUINNIPIAC AVE.) AND QUINNIPIAC AVE.;  
 RTE. 80 (FOXON BLVD.) AT EASTERN ST.

- 92-242
- 4 push button boxes (green)
  - 1 control box (grey)

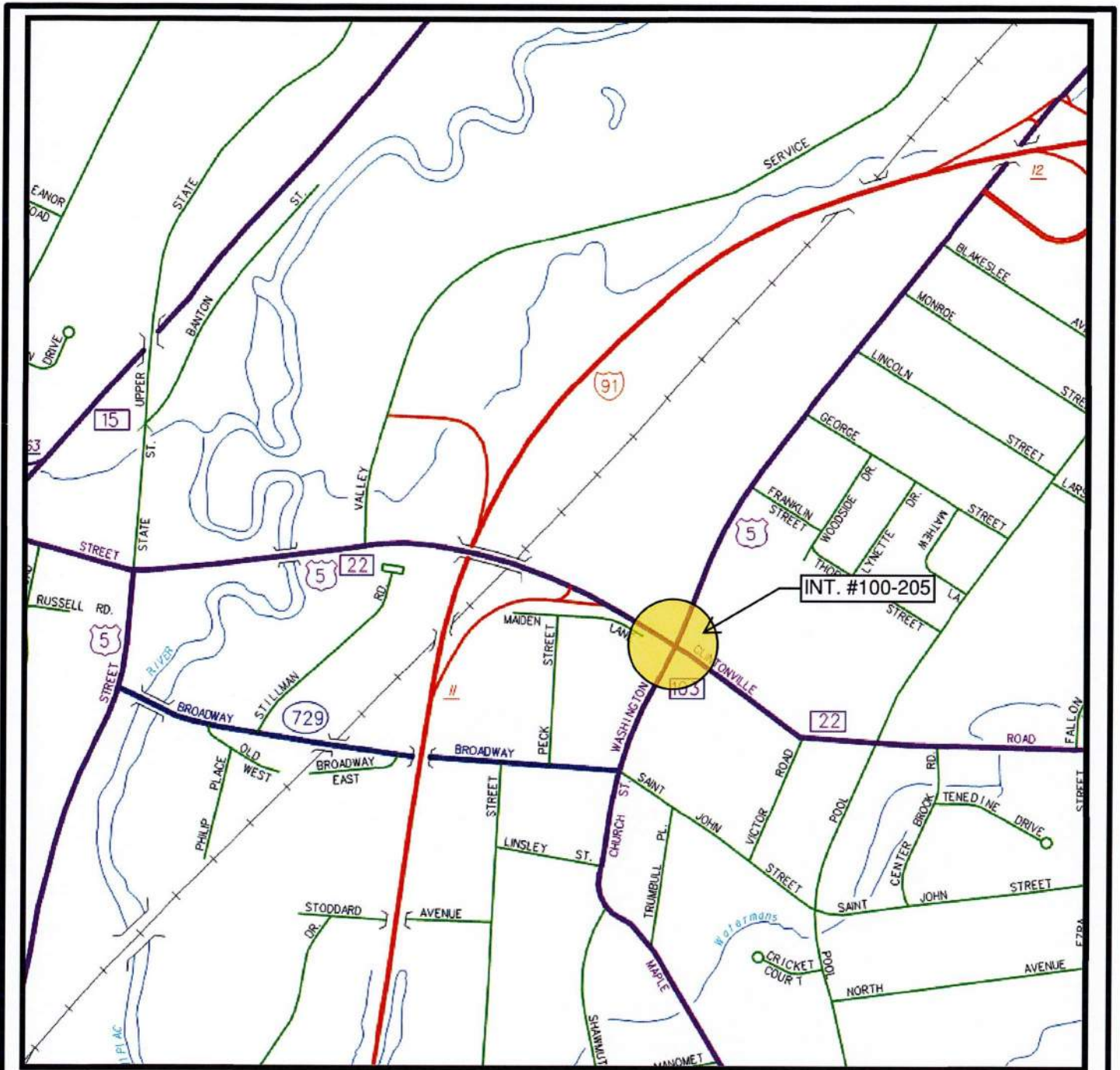

- 8 walk cross walk signals (yellow/black/green)
- 7 traffic signals (yellow/black)
- control box (grey paint)
- 6 box buttons (yellow)
- 7 unpainted galvanized poles
- 3 LG/4 small

SCALE - NONE

**STATE OF CONNECTICUT**  
 DEPARTMENT OF TRANSPORTATION  
 BUREAU OF ENGINEERING & CONSTRUCTION  
 DIVISION OF TRAFFIC ENGINEERING

---

PROJECT NO. 0173-0468  
 INT. #100-205  
 TOWN OF NORTH HAVEN  
 U.S. RTE. 5/RTE. 103 (WASHINGTON AVE.) AT  
 U.S. RTE. 5/RTE. 22 (BISHOP ST.) AND  
 RTE. 22 (CLINTONVILLE RD.)



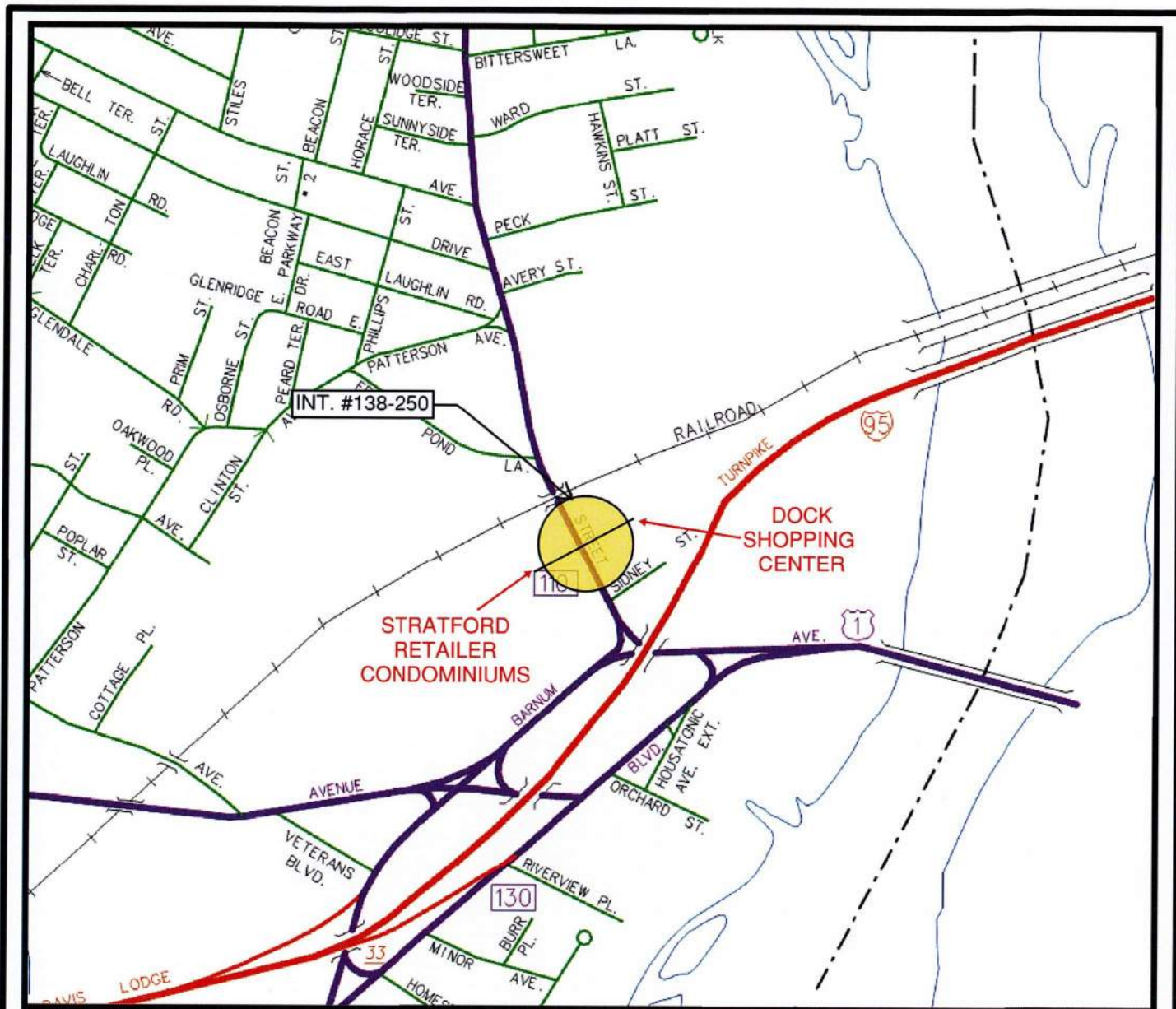

- 2 short alum / 2 large galv unpainted / 1 mini pole unpainted
- 6 cross walk signals (~~green~~) black
- 16 Green traffic lights
- 4 green push button boxes
- 1 grey control box

SCALE - NONE

**STATE OF CONNECTICUT**  
 DEPARTMENT OF TRANSPORTATION  
 BUREAU OF ENGINEERING & CONSTRUCTION  
 DIVISION OF TRAFFIC ENGINEERING

---

PROJECT NO. 0173-0468  
 INT. #138-250  
 TOWN OF STRATFORD  
 RTE 110 (E. MAIN ST.) AT DRIVES FOR  
 DOCK SHOPPING CENTER AND STRATFORD  
 RETAILERS CONDOMINIUMS

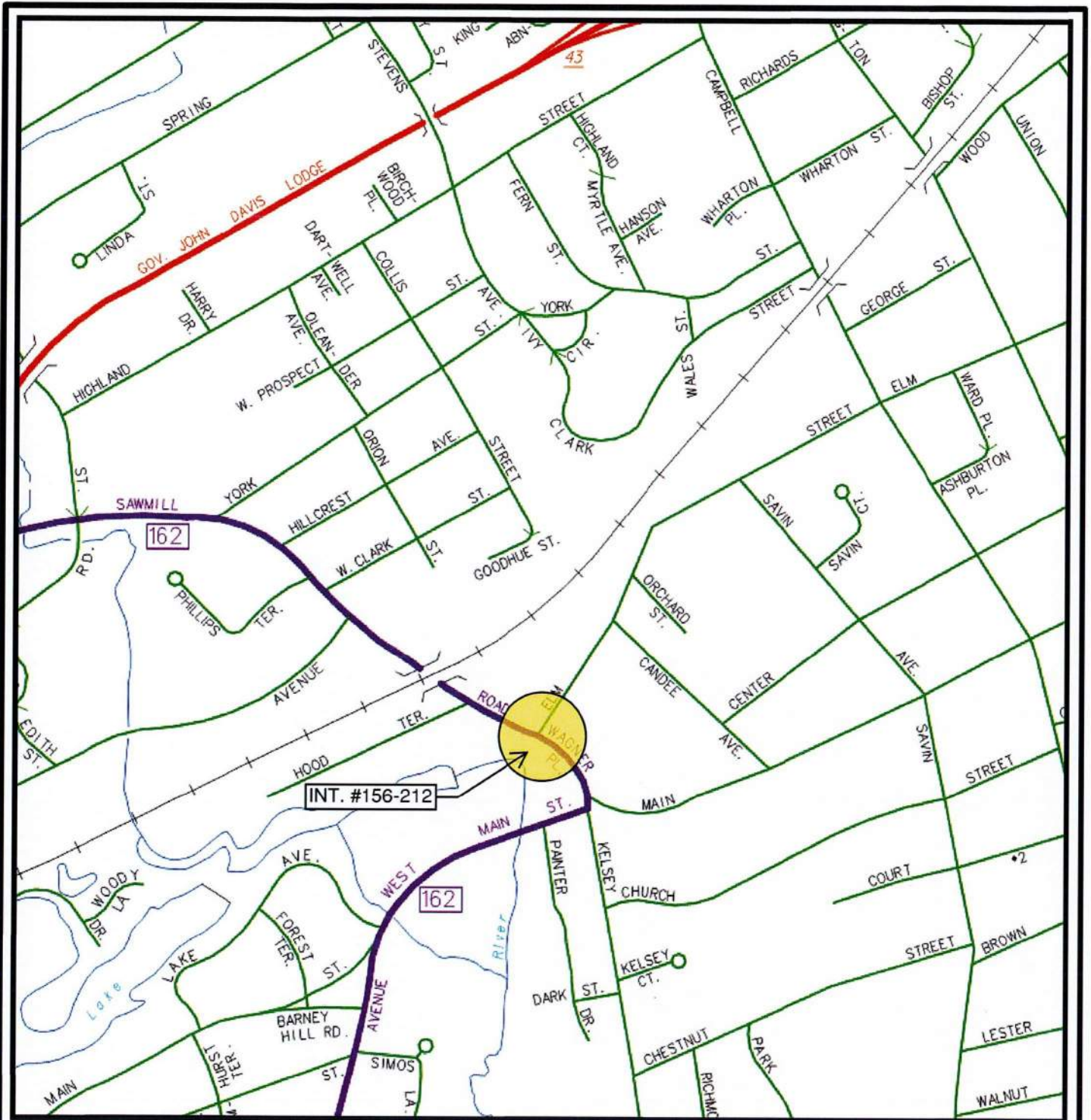

- 6 green traffic signals
- 1 medium unpainted galvanized pole
- 1 short unpainted gal pole
- 1 black crossing signal
- 1 gray control box
- 1 green push button box

SCALE - NONE

<p><b>STATE OF CONNECTICUT</b>          DEPARTMENT OF TRANSPORTATION          BUREAU OF ENGINEERING &amp; CONSTRUCTION          DIVISION OF TRAFFIC ENGINEERING</p>
<p>PROJECT NO. 0173-0468          INT. #156-212          CITY OF WEST HAVEN          RTE. 162 (SAW MILL RD./WAGNER PL.) AT ELM ST.</p>

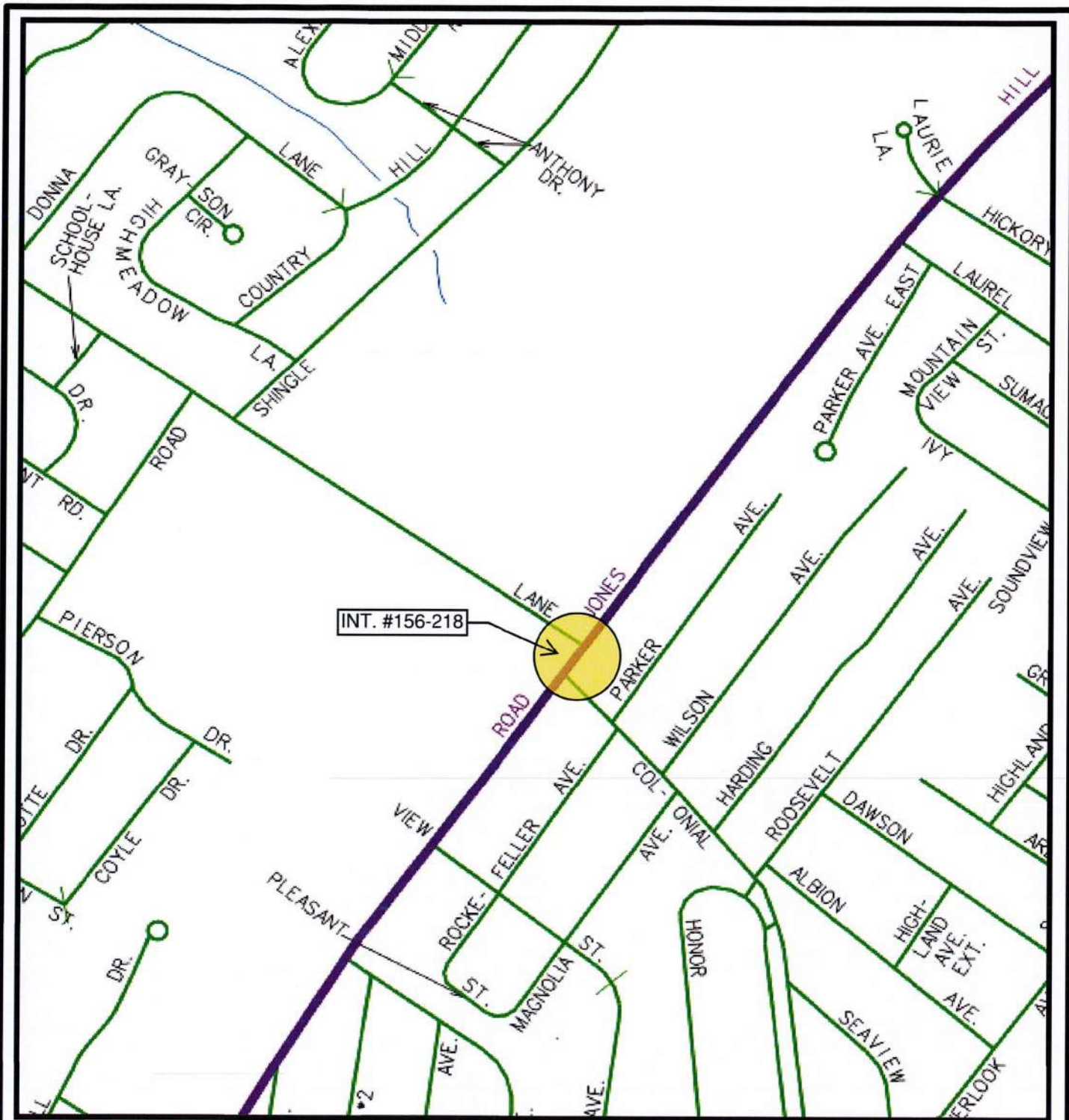

- 12 green traffic signals
- 6 black cross walk signals
- 2 unpainted Large galvanized poles
- 1 grey / unpainted control box
- 4 short unpainted aluminum poles
- 5 green push button boxes

- 5 wooden poles
- No suspect ACM

SCALE - NONE

**STATE OF CONNECTICUT**  
 DEPARTMENT OF TRANSPORTATION  
 BUREAU OF ENGINEERING & CONSTRUCTION  
 DIVISION OF TRAFFIC ENGINEERING

---

PROJECT NO. 0173-0468  
 INT. #156-218  
 CITY OF WEST HAVEN  
 RTE. 162 (JONES HILL RD.) AT COLONIAL BLVD. AND  
 MORGAN LN.

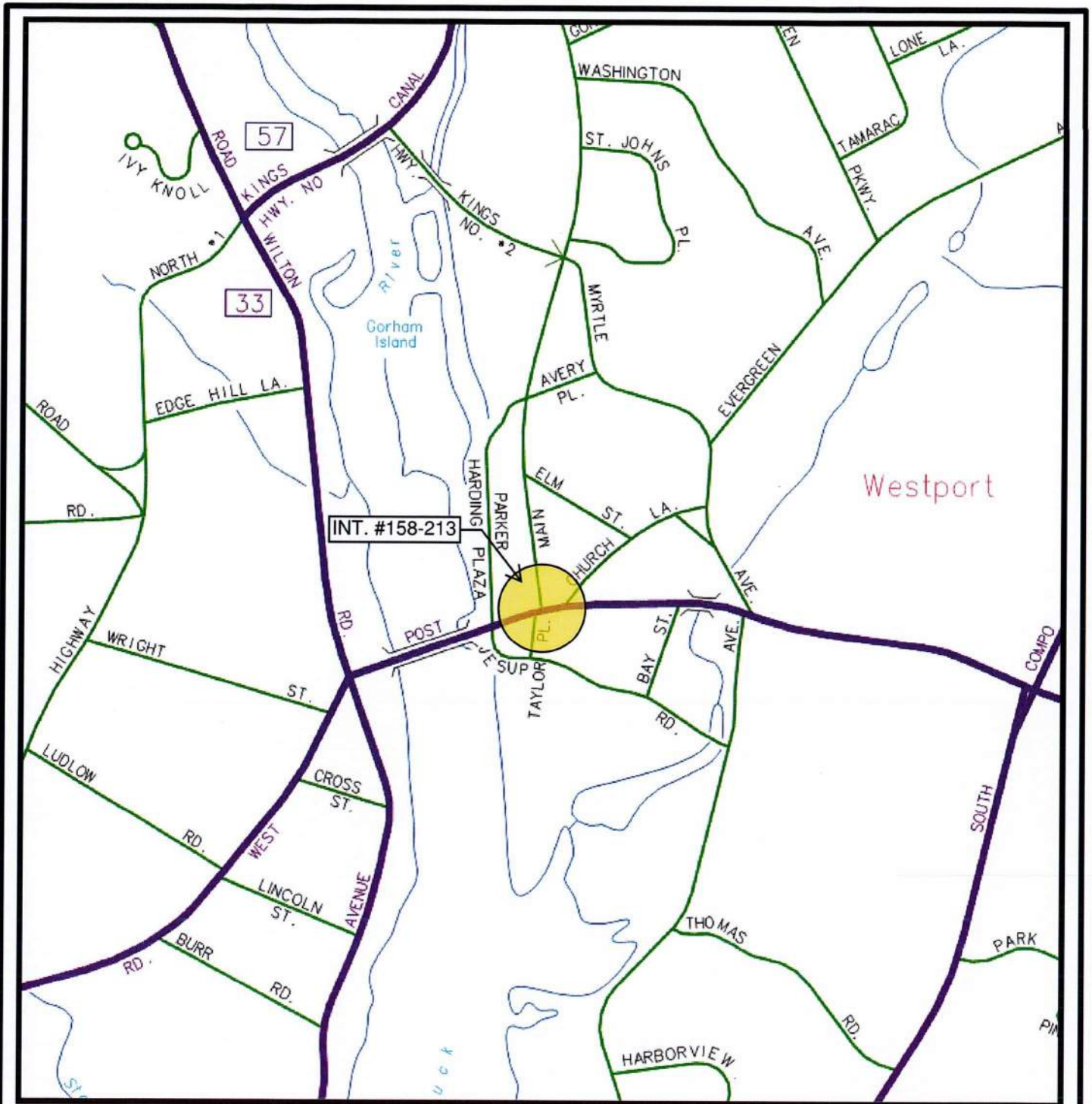

Westport

INT. #158-213

- 7 YELLOW PAINTED TRAFAC LIGHTS
- 2 UNPAINTED GALVANIZED LARGE POLES
- 2 PUSH BOTTON CROSS GREEN/YELLOW
- 1 GREEN TRAFAC LIGHT SHOOT POLE GALVANIZED
- NO ACM SUSPECTS

SCALE - NONE

STATE OF CONNECTICUT  
 DEPARTMENT OF TRANSPORTATION  
 BUREAU OF ENGINEERING & CONSTRUCTION  
 DIVISION OF TRAFFIC ENGINEERING

PROJECT NO. 0173-0468  
 INT. #158-213  
 TOWN OF WESTPORT  
 U.S. RTE. 1 (STATE ST. EAST) AT TAYLOR PL.  
 AND MAIN ST.

**Project Title:** Installation of Traffic Control Signals in District 3 with APS Upgrades

**Project Number:**

- PE Project Number: 0173-0468
- CN Project Number: 0173-0468

**Detailed Project Description:**

This project will upgrade and replace existing traffic control signal equipment which will require excavation of existing signal equipment as well as excavation for new foundations for span poles, mast arms, pedestals, controller cabinets, etc. Additional excavation will also be required for sidewalk ramps that will be installed or reconstructed to meet current ADA standards. A majority of the excavation is expected to take place within areas that have undergone extensive ground disturbance in the past; however, it is possible that some of the excavation may take place in areas where the ground has not been previously extensively disturbed. There is significantly less than an acre of disturbance for each location. All intersections listed below consist of new signal equipment being installed at existing signalized locations.

**Purpose and Need Statement:**

This project will install new traffic control signal equipment, which may include span poles, mast arms, signal heads, span wires, pedestrian countdown heads and pedestals, pedestrian push button pedestals, sidewalks and sidewalk ramps, conduits, loop detectors, and signing and pavement markings.

Existing span poles and foundations will be removed and replaced with new foundations and galvanized structures.



## ConnDOT, North Haven - Westport Traffic Signals, New Haven, , North Haven, 06473, CT, US, Washington Ave, 136

Created	2019-03-05 09:02:35 EST by Michael Stewart
Updated	2019-08-11 09:48:57 EDT by Stephen Arienti
Location	41.3962348457811, -72.8546814434909
Status	<span style="color: blue;">■</span> Survey Complete

### Job Information

Site Name	North Haven - Westport Traffic Signals
Address	136 Washington Ave North Haven, CT 06473
TRC Project Number	289951.5853.0710
Project Manager	Erik Plimpton, Stephen Arienti
Inspector(s)	Pat Schaffner, Michael Stewart, Tyler Macgillivray
Client	ConnDOT
Type of Asbestos Survey	Reno/Demo
Additional Analysis for NOB Materials (Calc)	TEM NY NOB 198.4
Date	2019-03-05

Overview Photo



Intersection 100-205



Intersection 100-205



Intersection 100-205



Intersection 100-205



Intersection 043-221



Intersection 043-221



Intersection 043-221



Intersection 092-241



Intersection 092-241



Intersection 092-241



Intersection 092-241



Intersection 092-242



Intersection 092-242



Intersection 092-242



Intersection 092-242





Intersection 156-212



Intersection 156-212



Intersection 156-212



Intersection 156-218



Intersection 156-218



Intersection 156-218



Intersection 156-218



Intersection 156-218



Intersection 083-244



Intersection 083-244



Intersection 083-244



Intersection 083-244



Intersection 083-237

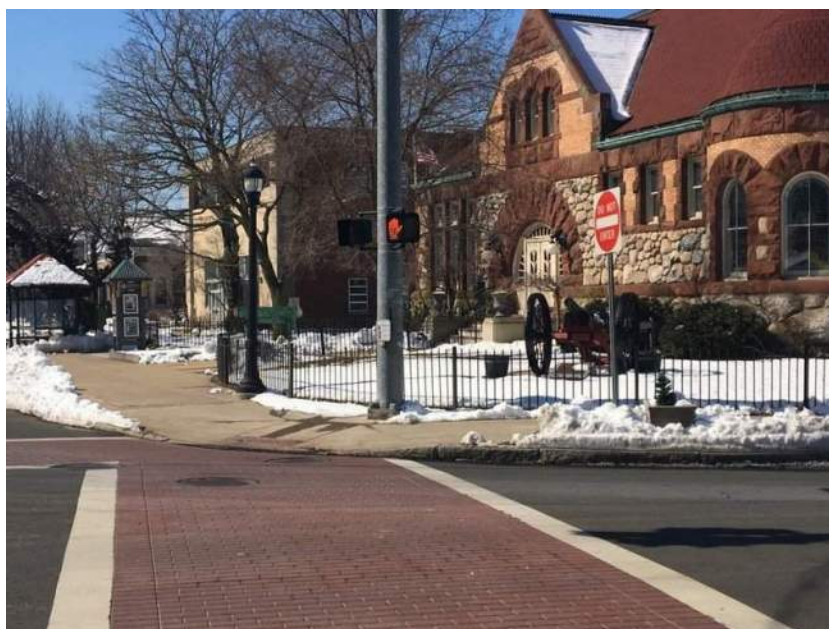

Intersection 083-237



Intersection 083-237



Intersection 083-237





. Intersection 138-201



Intersection 138-201



Intersection 138-201



Intersection 138-276



Intersection 138-276



Intersection 138-276







Intersection 158-213



Intersection 158-213



Intersection 158-213



Intersection 050-201



Intersection 050-201



Intersection 050-201





Intersection 050-201



Intersection 050-207



Intersection 050-207



Intersection 015-267



Intersection 015-267



Intersection 015-267



Intersection 075-204



Intersection 075-204



Intersection 075-204



Intersection 075-204



Intersection 075-220



Intersection 075-220



Intersection 075-220



Intersection 075-220

---

Surveys Performed	Asbestos, Hazardous Materials Inventory, Bridge/Signs/Light Pole/Traffic Signal Items
-------------------	---

---

**General Information**

Asbestos Samples Submitted to TRC Lab	No
App Name	WinBSI HBM Survey 1.0

---

**Generate Report Documentation**

Select one or more documents below to be generated. Once completed in the cloud, they will be sent to the listed email address. Please report any difficulties or errors to Justin Coleman.

What documents should be generated?	Photographs and other images, Hazardous material inventory
-------------------------------------	--

---

Where should the document(s) be sent?	sarienti@trcsolutions.com
Generate Documents	N/A