

**STATE OF CONNECTICUT**  
**NED LAMONT**  
**GOVERNOR**

# HARTFORD ARMORY GREASE TRAP REPLACEMENT

INSTALLATION ADDRESS: 360 BROAD STREET HARTFORD, CONNECTICUT

**PROJECT NUMBER: 19MIL21801**

## MILITARY DEPARTMENT

**MAJOR GENERAL FRANCIS J. EVON, JR.**  
**ADJUTANT GENERAL**

## STATE OF CONNECTICUT MILITARY DEPARTMENT FACILITIES MANAGEMENT

**360 BROAD STREET**  
**HARTFORD, CONNECTICUT 06105**

GENERAL:



ENGINEER:

**SALAMONE  
 &  
 ASSOCIATES, P.C.**  
**CONSULTING ENGINEERS**

116 North Plains Industrial Road  
 Wallingford, Connecticut 06492  
 Phone: (203) 281-6895 Fax: (203) 287-8728

DISCLAIMER

THE INFORMATION INDICATED HERewith IS THE SOLE PROPERTY OF SALAMONE & ASSOCIATES, P.C. AND ANY REPRODUCTION BY ANY METHOD IN PART IS STRICTLY PROHIBITED WITHOUT WRITTEN PERMISSION OF SALAMONE & ASSOCIATES, P.C.

REVISION

MARK	DATE	DESCRIPTION

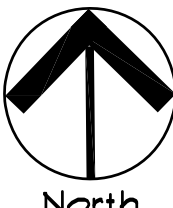
DRAWN BY: SJS	 North
APPD BY: JAS	
SCALES: AS NOTED	
FILE AS:	

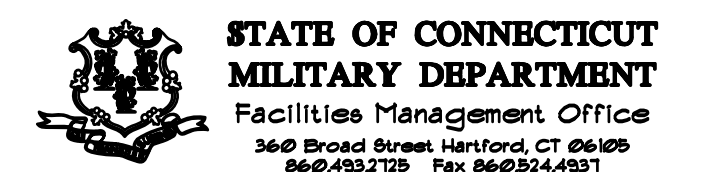

**PROJECT**  
**HARTFORD ARMORY**  
**GREASE TRAP REPLACEMENT**  
**360 BROAD ST. HARTFORD, CT**

**DRAWING TITLE**  
**TITLE SHEET**

DATE JUNE 26, 2019	DRAWING NO. T-01
AGENCY TRACKING NUMBER HA-16-001	

PROJECT SITE KEY PLAN

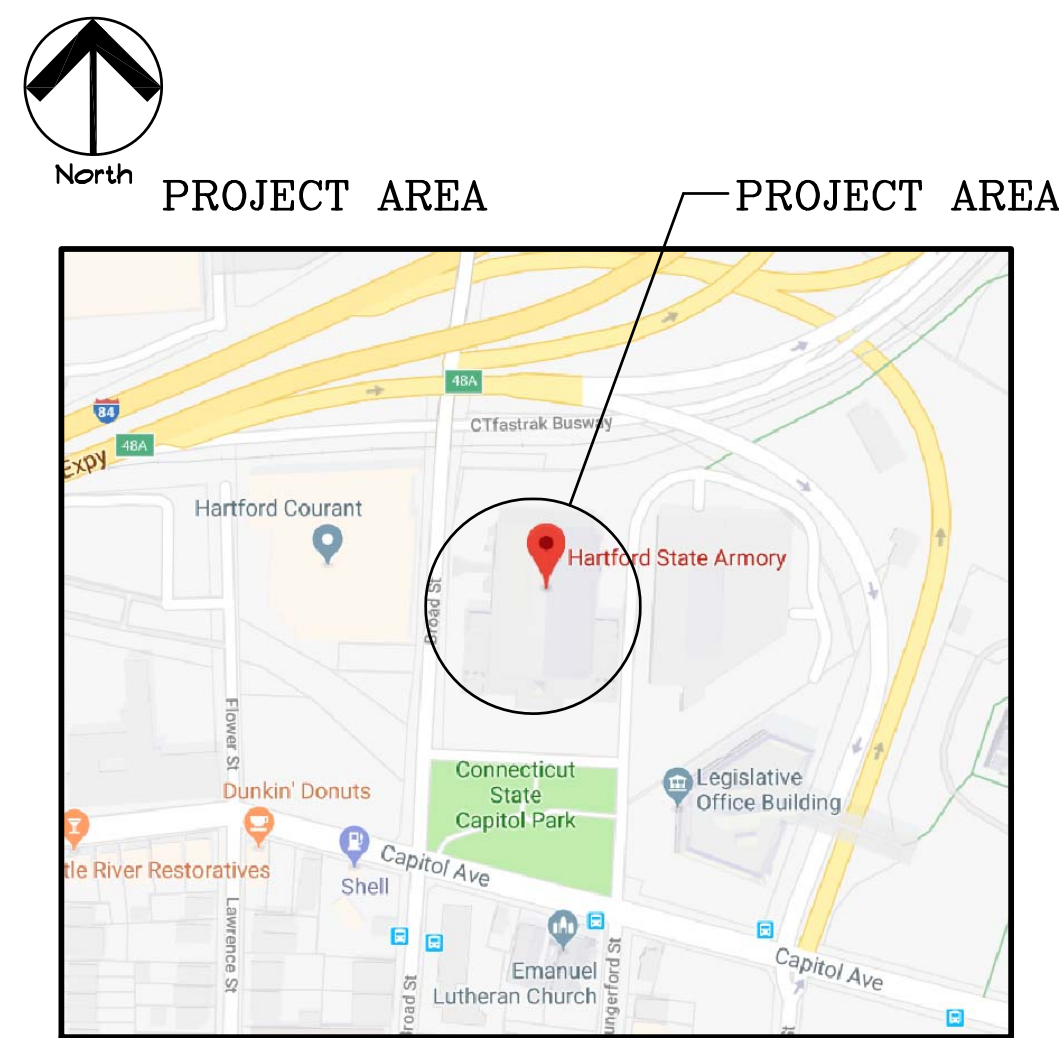

SHEET INDEX

- T-01 TITLE SHEET
- DP-101 PARTIAL BASEMENT PLUMBING DEMOLITION PLAN
- P-101 PARTIAL BASEMENT PLUMBING PLAN
- P-201 PLUMBING DETAILS, SYMBOLS AND ABBREVIATIONS

LOCATION PLAN  
 NEW LONDON, CONNECTICUT

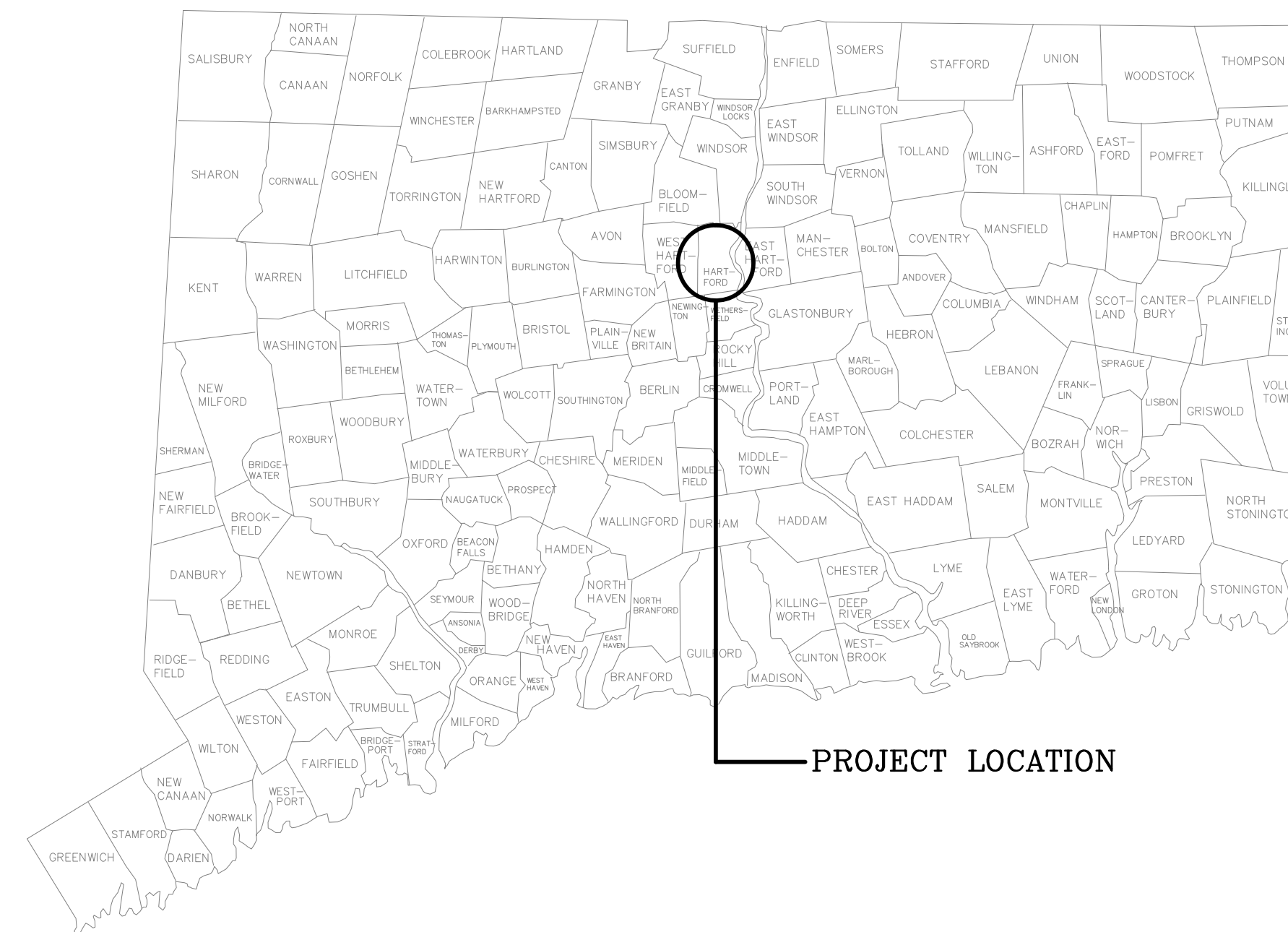

PROJECT NUMBER: 00A-5016001

PROJ NUMBER: 0945016001

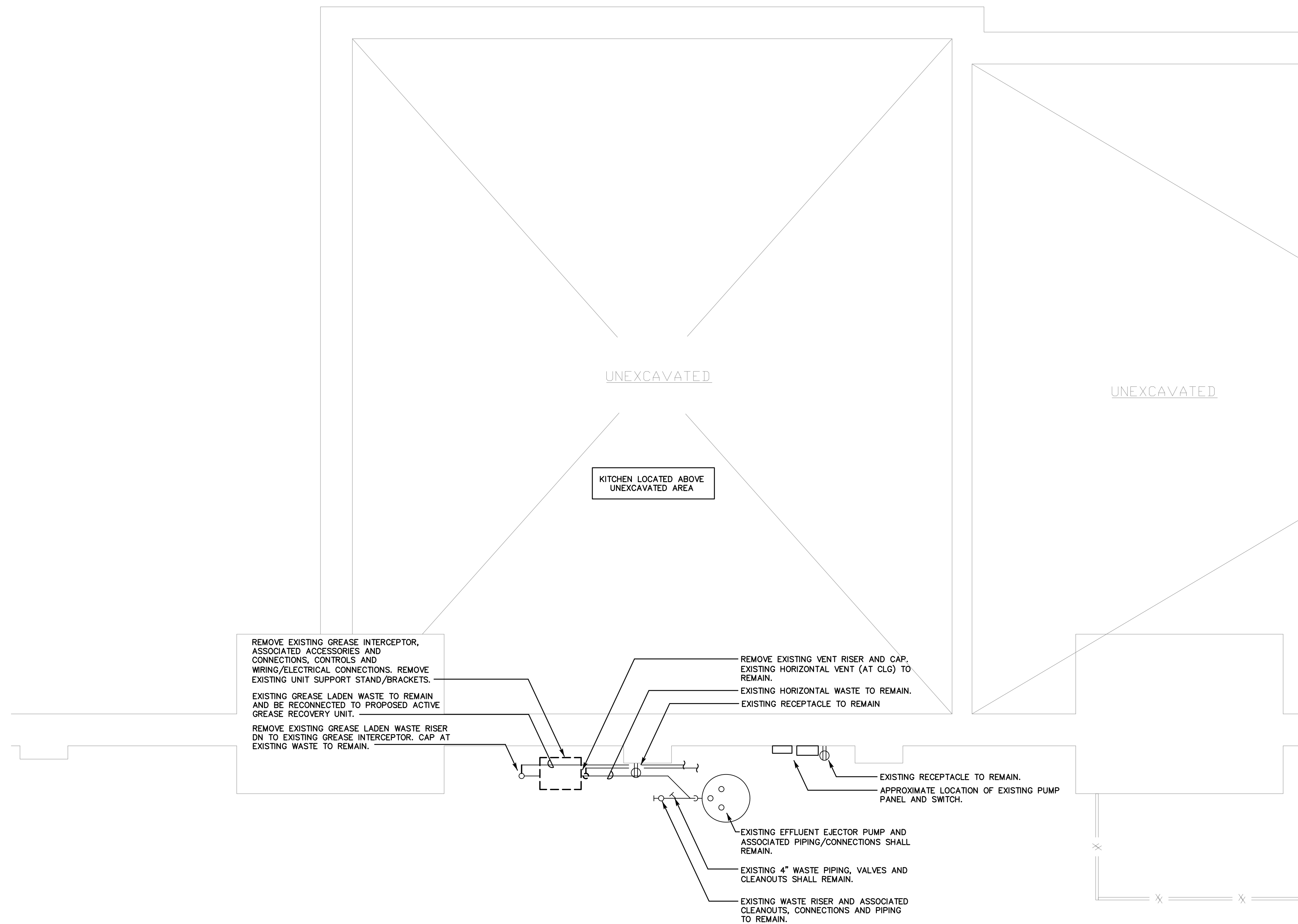

**PARTIAL BASEMENT  
PLUMBING DEMOLITION PLAN**  
SCALE: 1/4"=1'-0"

GENERAL:

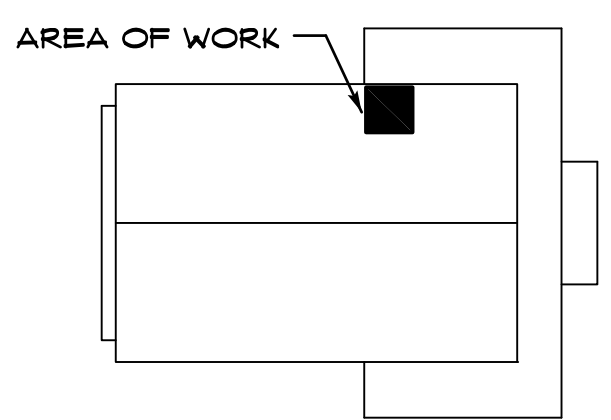

**KEY PLAN**  
SCALE: N.T.S.

ARCHITECT/ ENGINEER

**SALAMONE  
&  
ASSOCIATES, P.C.**

CONSULTING ENGINEERS

116 North Plains Industrial Road  
Wallingford, Connecticut 06492  
Phone: (203) 281-6895 Fax: (203) 287-8728

DISCLAIMER

THE INFORMATION INDICATED HERewith IS THE SOLE PROPERTY OF SALAMONE & ASSOCIATES, P.C. AND ANY REPRODUCTION BY ANY METHOD IN PART IS STRICTLY PROHIBITED WITHOUT WRITTEN PERMISSION OF SALAMONE & ASSOCIATES, P.C.

REVISION

MARK	DATE	DESCRIPTION

DRAWN BY: SJS

APPD BY: JAS

SCALES: AS NOTED

FILE AS:

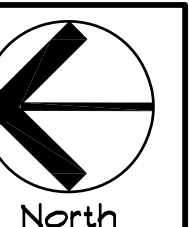

PROJECT

**HARTFORD ARMORY  
GREASE TRAP REPLACEMENT**

360 BROAD ST. HARTFORD, CT

DRAWING TITLE

**PARTIAL BASEMENT  
PLUMBING DEMOLITION PLAN**

DATE

JUNE 26, 2019

DRAWING NO.

DP-101

AGENCY TRACKING NUMBER  
HA-16-001

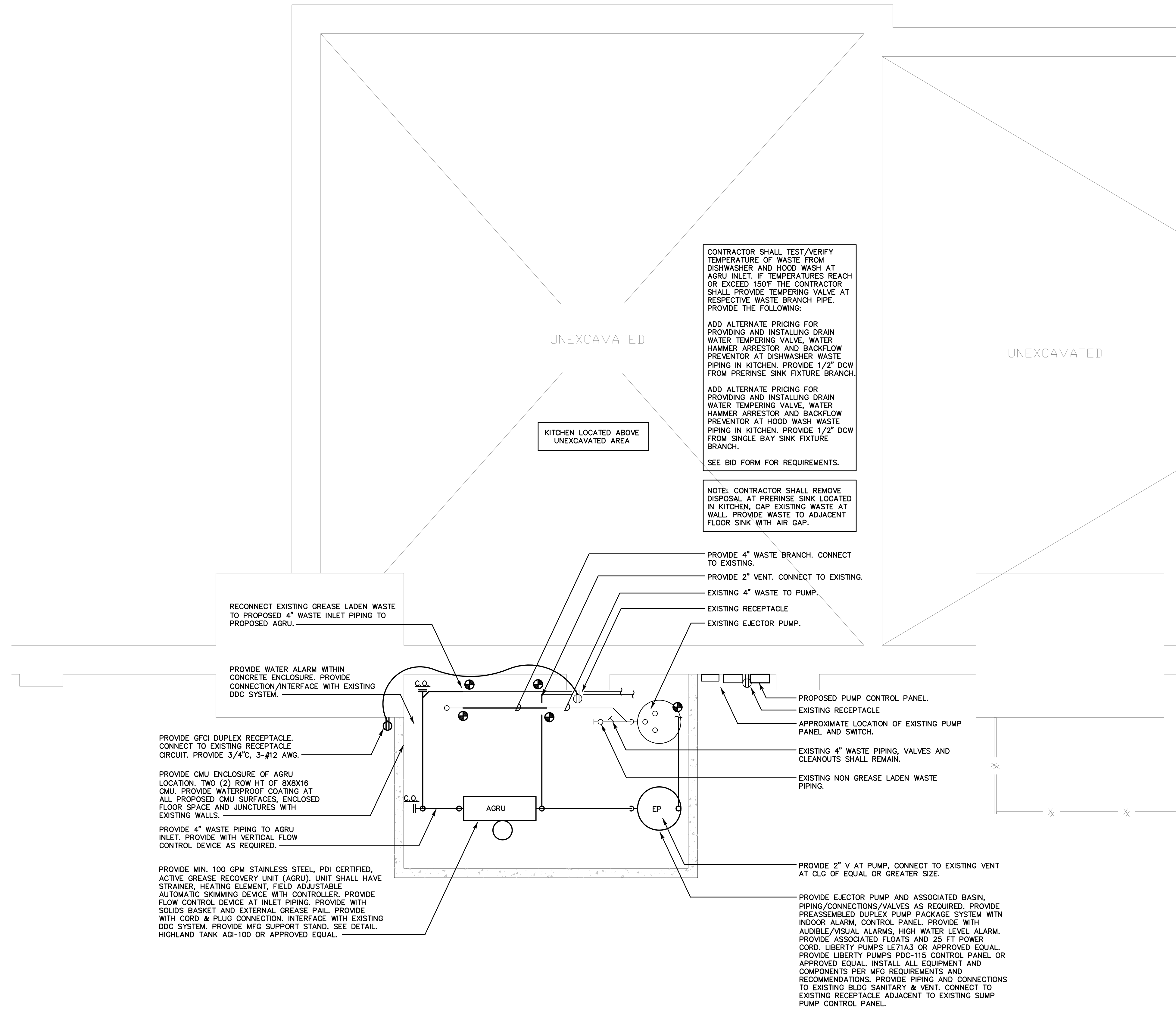

**PARTIAL BASEMENT  
PLUMBING PLAN**  
SCALE: 1/4"=1'-0"

**NOTE:**  
ALL WORK SHALL BE DONE IN STRICT CONFORMANCE WITH CT MDC AND DEEP REQUIREMENTS AND RECOMMENDATIONS. EQUIPMENT SHALL BE INSTALLED PER MFG INSTRUCTIONS AND RECOMMENDATIONS. MOST STRINGENT REQUIREMENTS SHALL APPLY. CONTRACTOR SHALL OBTAIN AND PAY FOR ALL REQUIRED PERMITS. COORDINATE WITH LOCAL HEALTH DEPT AND AUTHORITIES HAVING JURISDICTION. TYPICAL.

GENERAL:

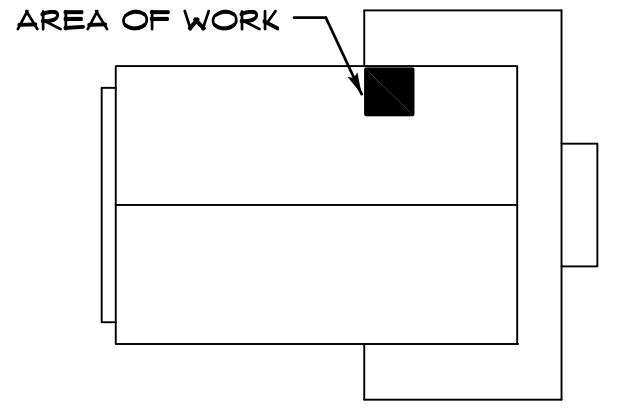

ARCHITECT/ ENGINEER

**SALAMONE  
&  
ASSOCIATES, P.C.**

**CONSULTING ENGINEERS**

116 North Plains Industrial Road  
Wallingford, Connecticut 06492  
Phone: (203) 281-6895 Fax: (203) 287-8728

**DISCLAIMER**

THE INFORMATION INDICATED HERewith IS THE SOLE PROPERTY OF SALAMONE & ASSOCIATES, P.C. AND ANY REPRODUCTION BY ANY METHOD IN PART IS STRICTLY PROHIBITED WITHOUT WRITTEN PERMISSION OF SALAMONE & ASSOCIATES, P.C.

**REVISION**

MARK	DATE	DESCRIPTION

DRAWN BY: SJS  
 APPD BY: JAS  
 SCALES: AS NOTED  
 FILE AS: North

**STATE OF CONNECTICUT  
MILITARY DEPARTMENT**  
Facilities Management Office  
360 Broad Street, Hartford, CT 06105  
860-483-2125 Fax 860-334-4837

PROJECT  
**HARTFORD ARMOY  
GREASE TRAP REPLACEMENT**  
 360 BROAD ST. HARTFORD, CT

DRAWING TITLE  
**PARTIAL BASEMENT  
PLUMBING PLAN**

DATE <b>JUNE 26, 2019</b>	DRAWING NO. <b>P-101</b>
AGENCY TRACKING NUMBER <b>HA-16-001</b>	

PROJ NUMBER: 0945016001

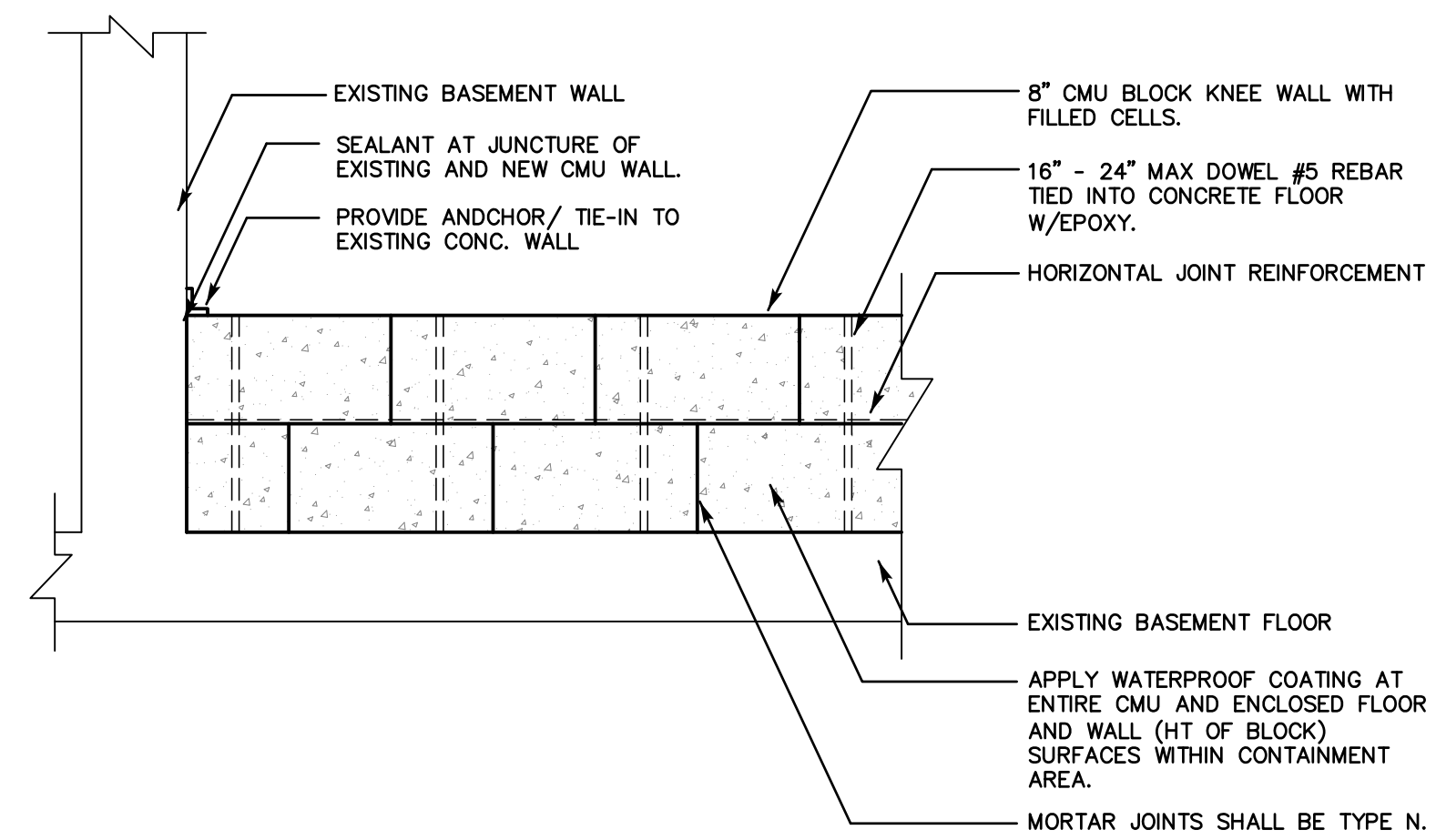

**CMU CONTAINMENT AREA DETAIL**  
SCALE: N.T.S.

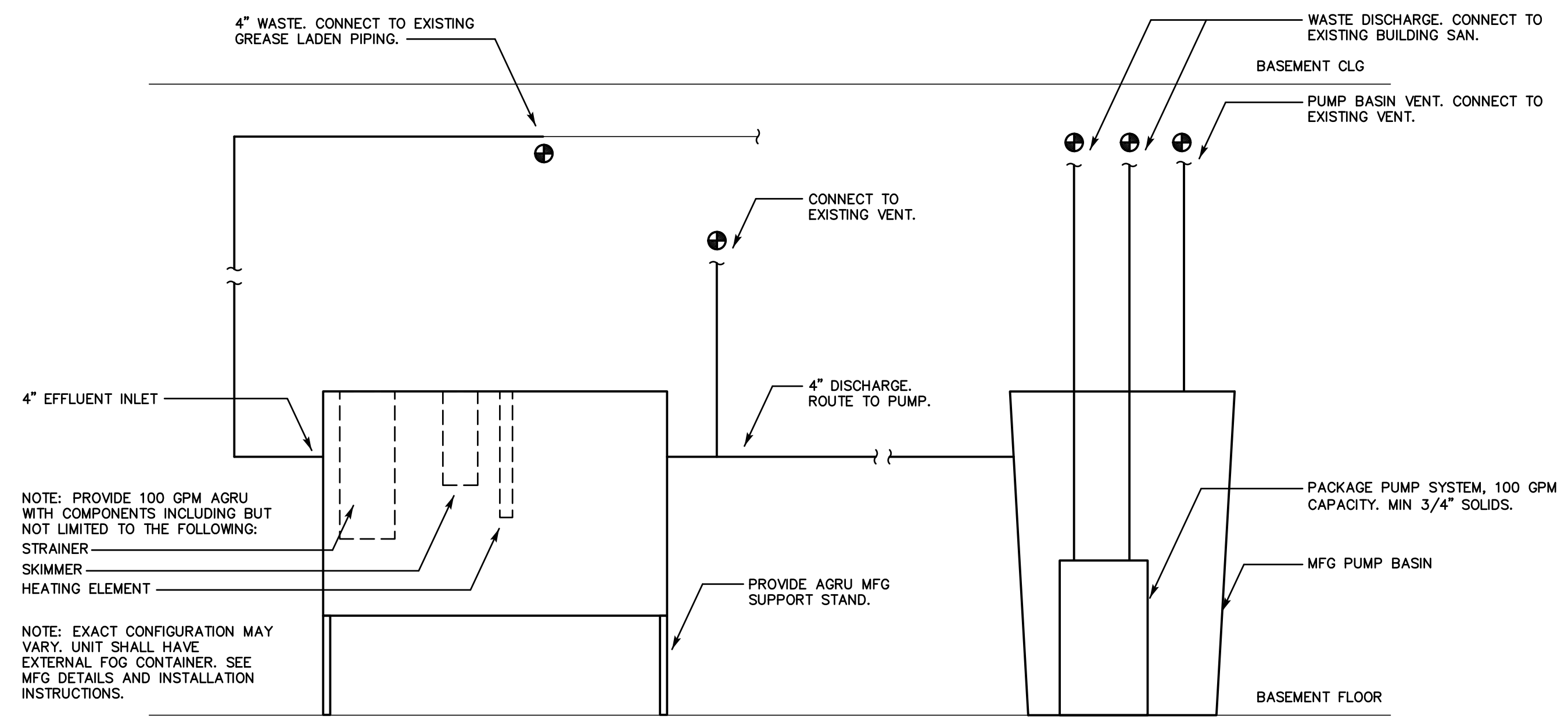

**GREASE INTERCEPTOR/PUMP SCHEMATIC**  
SCALE: N.T.S.

EFFLUENT PUMP SCHEDULE	
UNIT NO.	EP
SERVICE	AGRU DISCHARGE
LOCATION	BASEMENT
CAPACITY	100 GPM
ELECTRICAL (HP)	3/4 HP
DESIGN BASED MODEL	LE71A3
DESIGN BASED MANUFACTURER	LIBERTY
<b>NOTES:</b>	
1. INSTALL PER MANUFACTURERS INSTALLATION INSTRUCTIONS.	
2. PROVIDE PACKAGED SYSTEM WITH BASIN, FLOAT, ALARM/SENSOR, PANEL.	

ACTIVE GREASE RECOVERY UNIT	
UNIT NO.	AGRU
SERVICE	KITCHEN
LOCATION	BASEMENT
RATED CAPACITY (GPM)	100
DESIGN BASED MODEL	AGI-100
DESIGN BASED MANUFACTURER	HIGHLAND TANK
<b>NOTES:</b>	
1. INSTALL PER MANUFACTURERS INSTALLATION INSTRUCTIONS.	
2. PROVIDE WITH THE FOLLOWING COMPONENTS/FEATURES:	
STRAINER	
HEATING ELEMENT	
FIELD ADJUSTABLE AUTOMATIC SKIMMING DEVICE WITH CONTROLLER	
FLOW CONTROL DEVICE	
CORD & PLUG CONNECTION	
MFG SUPPORT STAND	

PLUMBING SYMBOL LIST	
	PIPE ELBOW, TURNED UP
	PIPE ELBOW, TURNED DOWN
	PIPING TO BE PROVIDED
	CLEAN OUT

PLUMBING ABBREVIATIONS	
AGRU	ACTIVE GREASE RECOVERY UNIT
C.O.	CLEANOUT
DN	DOWN
EP	EFFLUENT PUMP
GPM	GALLONS PER MINUTE
NTS	NOT TO SCALE
SAN	SANITARY
TYP	TYPICAL

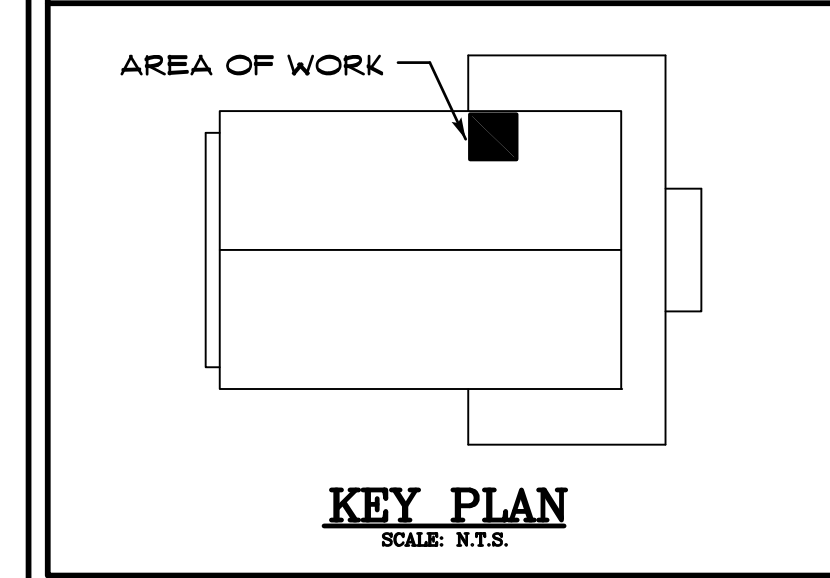
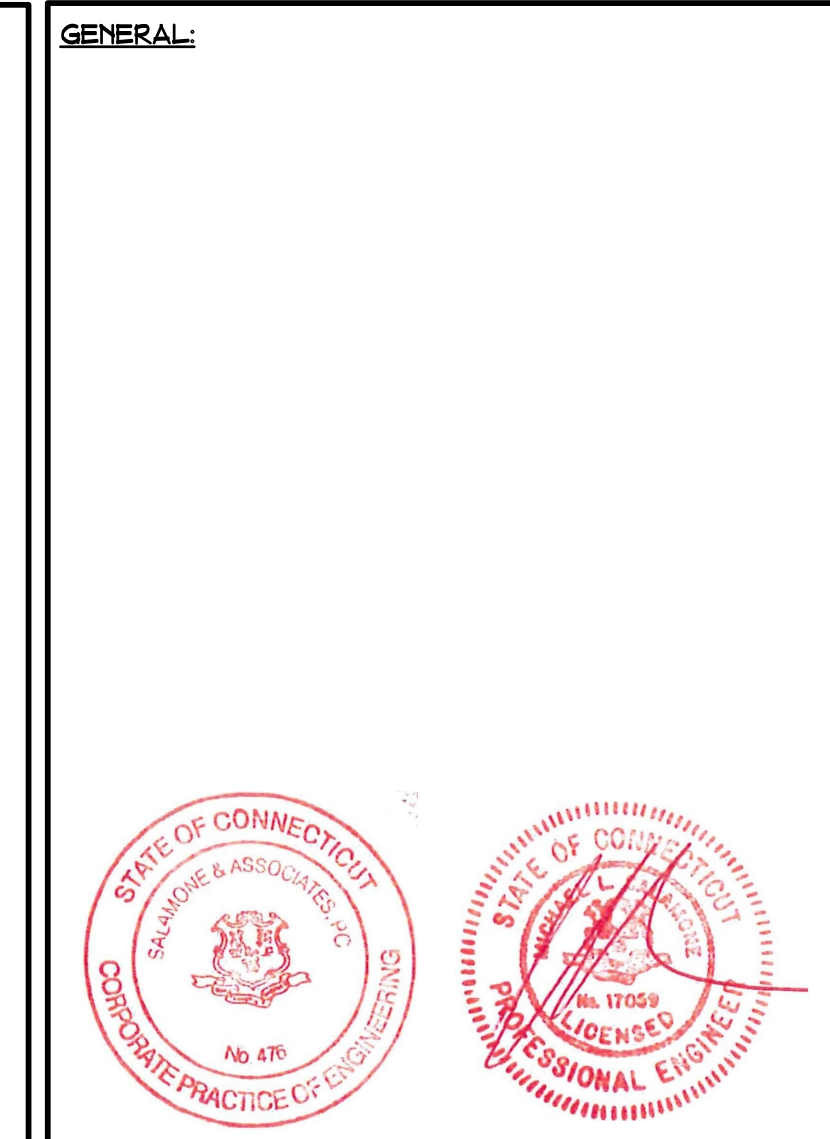

ARCHITECT/ ENGINEER

**SALAMONE & ASSOCIATES, P.C.**

CONSULTING ENGINEERS

116 North Plains Industrial Road  
Wallingford, Connecticut 06492  
Phone: (203) 281-6895 Fax: (203) 287-8728

**DISCLAIMER**

THE INFORMATION INDICATED HERewith IS THE SOLE PROPERTY OF SALAMONE & ASSOCIATES, P.C. AND ANY REPRODUCTION BY ANY METHOD IN PART IS STRICTLY PROHIBITED WITHOUT WRITTEN PERMISSION OF SALAMONE & ASSOCIATES, P.C.

REVISION		
MARK	DATE	DESCRIPTION

DRAWN BY: SJS  
APPD BY: JAS  
SCALES: AS NOTED  
FILE AS:

**STATE OF CONNECTICUT  
MILITARY DEPARTMENT**  
Facilities Management Office  
360 Broad Street, Hartford, CT 06105  
860-432-1215 Fax: 860-324-4837

PROJECT  
**HARTFORD ARMORY  
GREASE TRAP REPLACEMENT**  
360 BROAD ST. HARTFORD, CT

DRAWING TITLE  
**PLUMBING DETAILS, SYMBOLS  
AND ABBREVIATIONS**

DATE <b>JUNE 26, 2019</b>	DRAWING NO. <b>P-201</b>
AGENCY TRACKING NUMBER <b>HA-16-001</b>	