

CONSTRUCTION NOTES:

REMOVE ALL CERAMIC TILE AND BACKER BOARD WHERE INDICATED ON DRAWING.

REMOVE ALL FLOOR TILE AND MUD SET MORTAR WHERE INDICATED ON DRAWING.

ALL PLUMBING, WIRING, CEILING WORK AND REPAIR/REPLACEMENT OF METAL STUDS TO BE DONE BY AGENCY STAFF.

ALLOW 10 DAYS BETWEEN DEMOLITION AND START OF NEW WORK FOR AGENCY STAFF TO ROUGH IN PLUMBING AND REPAIR METAL STUDS AS NEEDED.

PROVIDE 1/2" HARDY BOARD BACKER FOR WALL TILES.

PLUMBING AND DRAIN WORK TO BE DONE BY OTHERS.

PROVIDE MAPEI 4 to 1 MUD BED, PITCH FLOOR TO EXISTING DRAINS IN ALL DIRECTIONS.

PROVIDE "HUMP" IN FLOOR UNDERLAYMENT WHERE INDICATED IN DRAWINGS.

PROVIDE LATICRETE 9235 WATERPROOF MEMBRANE 2 APPLICATIONS ON FLOORS.

FLOOR UNDERLAYMENT TO BE EXAMINED WITH PROJECT MANAGER BEFORE TILING TO ASSURE PITCH AND WATERPROOFING.

PROVIDE LATICRETE HYDRO BAN ON WALLS.

PROVIDE AMERICAN OLEAN MOSAIC 2X2 GROUP 3 ON FLOORS. AGENCY TO CHOOSE COLOR.

PROVIDE AMERICAN OLEAN GLAZED 4 X 4 WALL TILE GROUP 1 ON WALLS.

PROVIDE LATICRETE SPECTRA LOCK COMMERCIAL GROUT ON FLOORS AND WALLS.

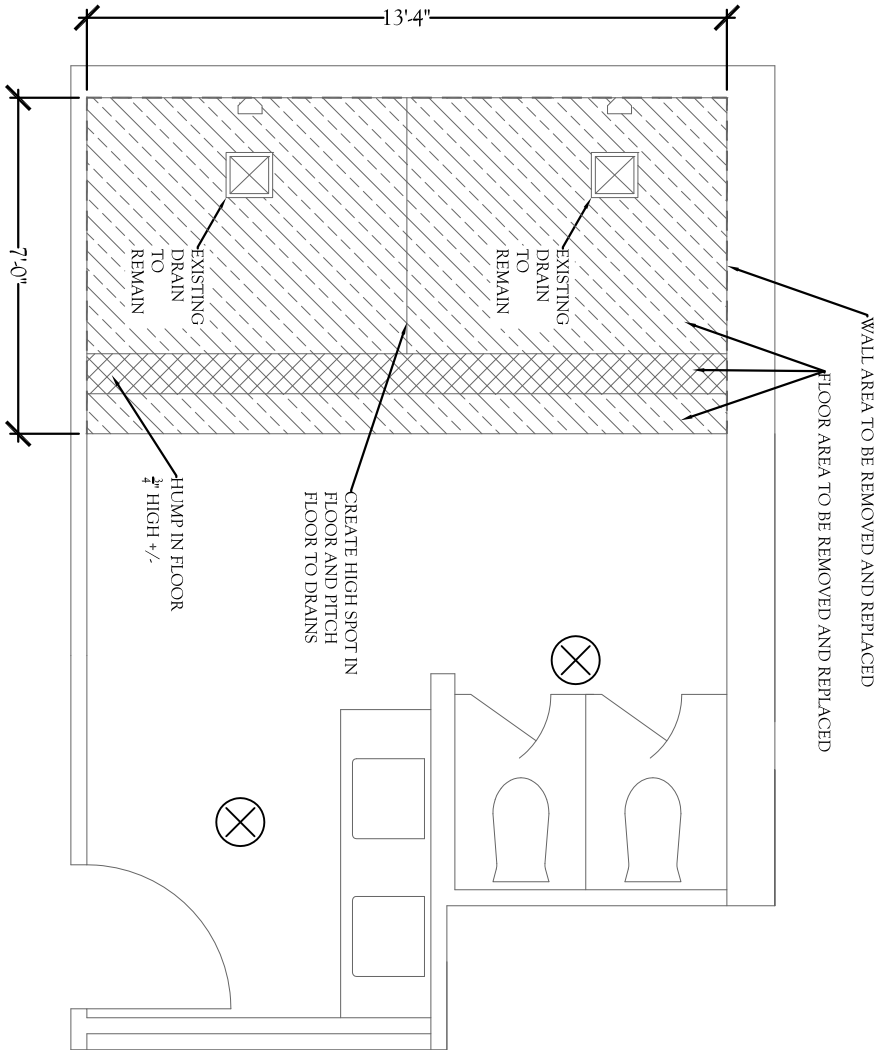

BLD 2 APT E

WALL AREA TO BE REMOVED AND REPLACED

FLOOR AREA TO BE REMOVED AND REPLACED