

ATHLETIC FACILITY IMPROVEMENTS AT RHAM HIGH SCHOOL

85 WALL STREET
HEBRON, CONNECTICUT

MAY 15, 2019

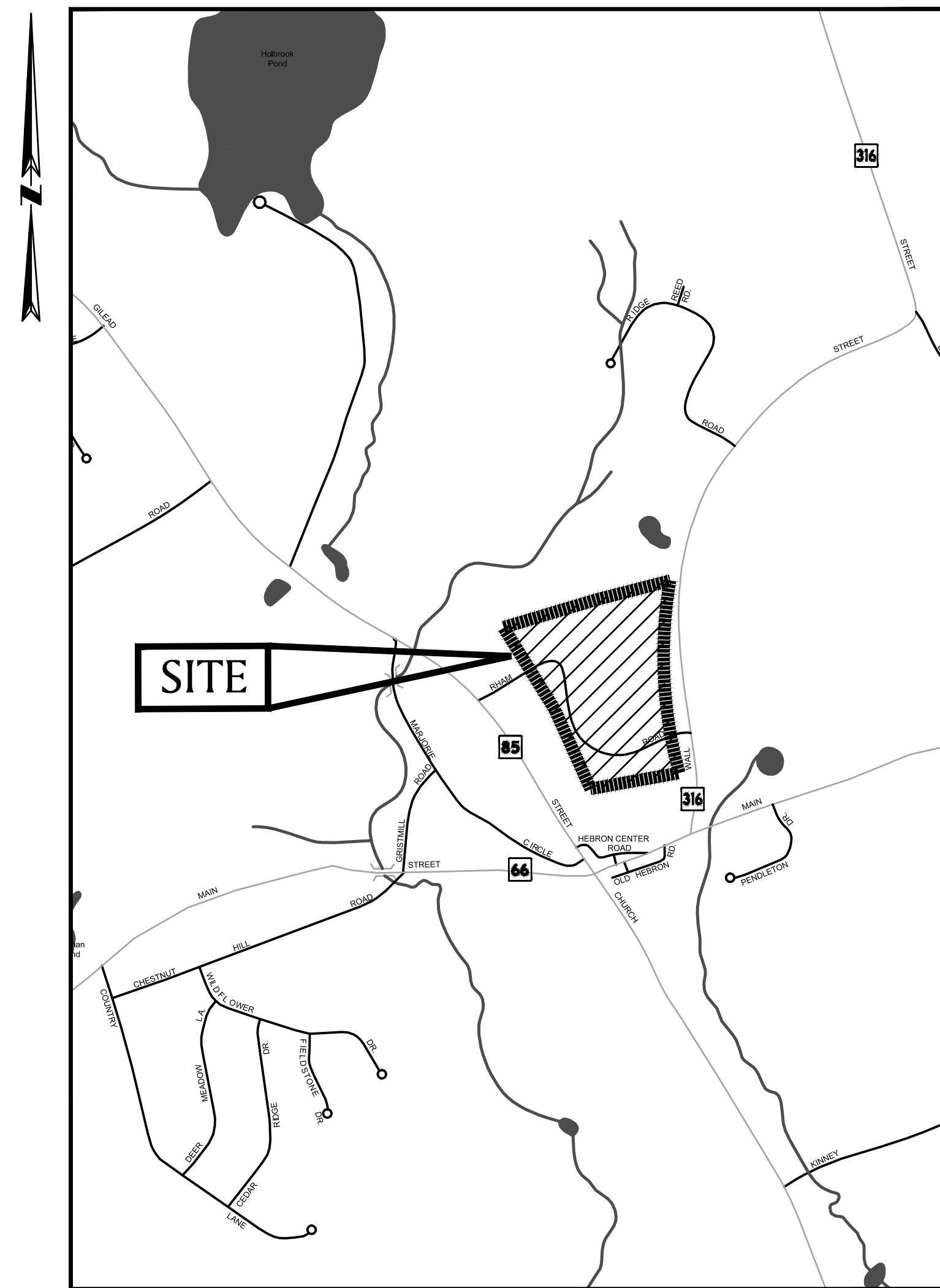

LOCUS MAP

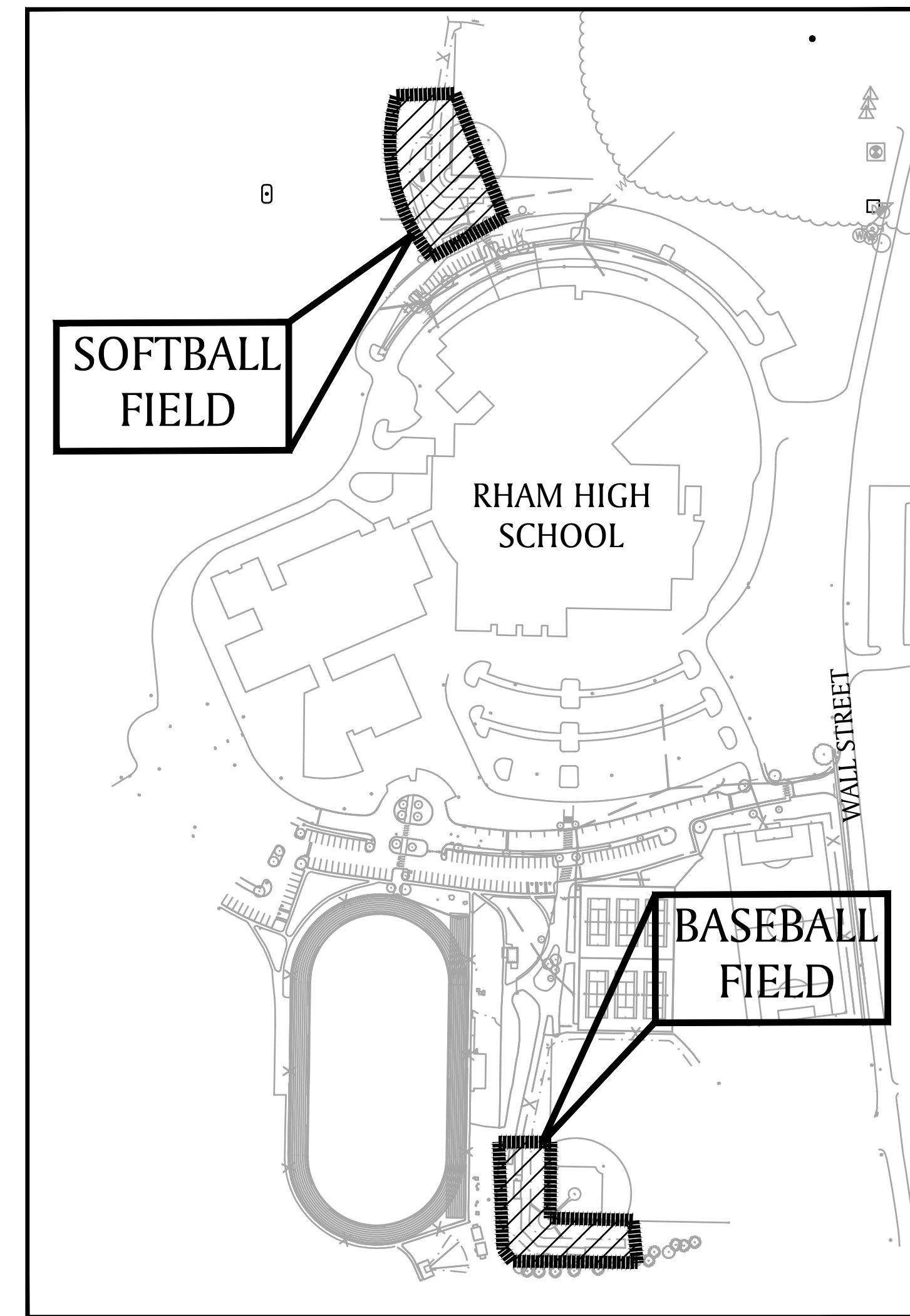
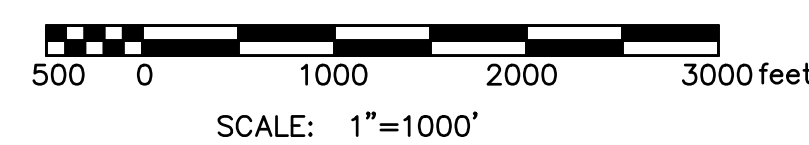

SITE MAP

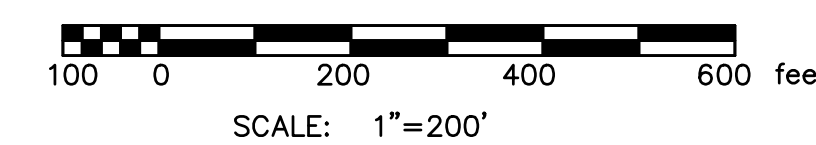

INDEX OF DRAWINGS

T-1.0	TITLE SHEET
L-1.0	SOFTBALL FIELD ACCESSIBILITY PLAN
L-2.0	BASEBALL DUGOUT ACCESSIBILITY PLAN
L-3.0	DETAILS

PREPARED FOR:

REGIONAL SCHOOL DISTRICT NO. 8
P.O. BOX 1438
HEBRON, CT 06248

PREPARED BY:

BSC GROUP
300 Winding Brook Drive
Glastonbury, Connecticut 06033
860 652 8227

ISSUED FOR BID



JESSE A. HARRIS NO. 1224

ATHLETIC FACILITY IMPROVEMENTS AT RHAM HIGH SCHOOL

85 WALL STREET
IN
HEBRON CONNECTICUT

SOFTBALL FIELD ACCESSIBILITY PLAN

MAY 15, 2019

REVISIONS:

NO.	DESCRIPTION

PREPARED FOR:
REGIONAL SCHOOL DISTRICT NO. 8
P.O. BOX 1438
HEBRON, CT 06248

300 Winding Brook Drive
Glastonbury, Connecticut 06033
860 652 8227

© 2018 BSC GROUP, INC.
SCALE: 1" = 10'



FILE: 83623.05-LM_NEW.DWG

DWG. NO. L-1.0

JOB. NO. 83623.05

ISSUED FOR BID

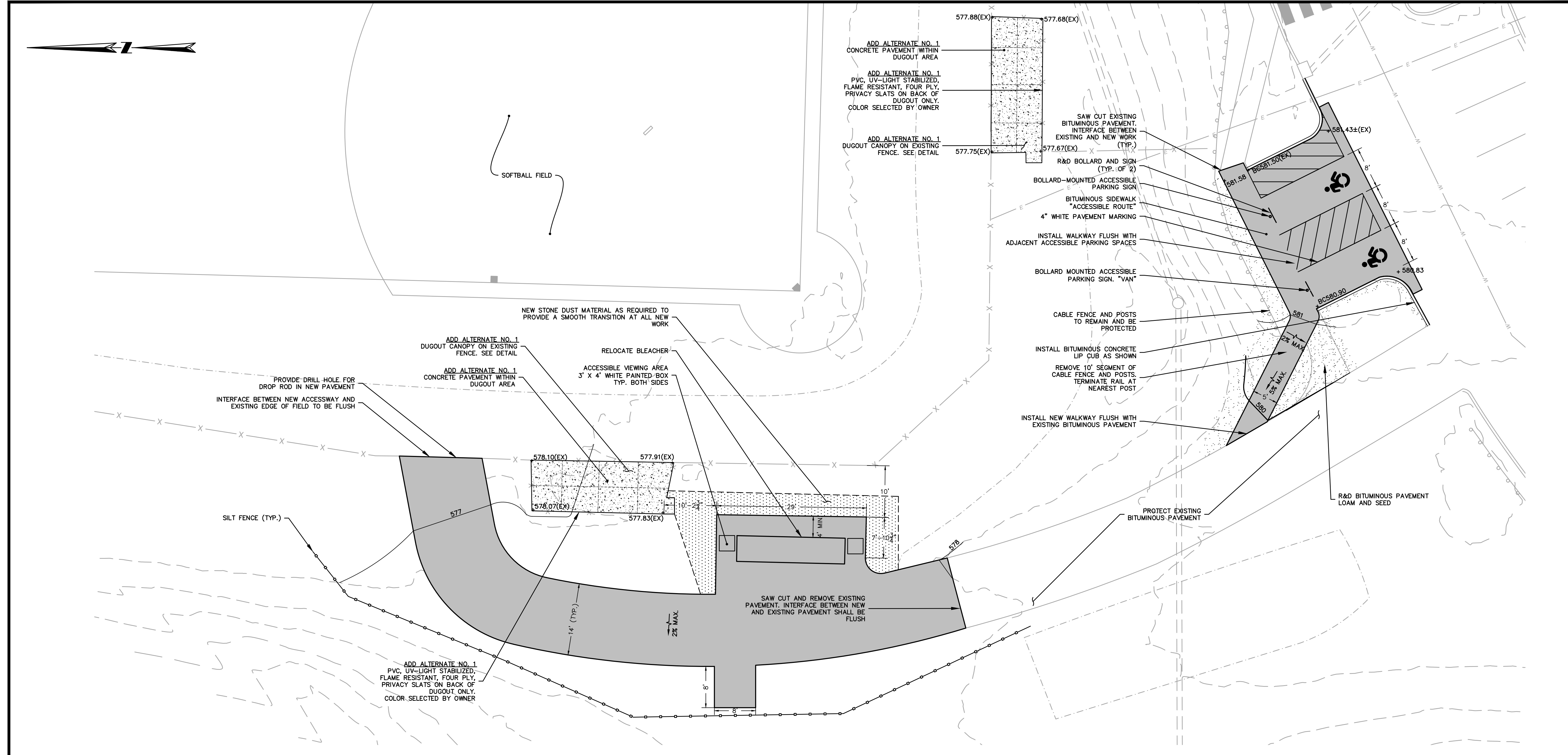

SITE PREPARATION NOTES

- CONTRACTOR SHALL NOTIFY CALL BEFORE YOU DIG (1-800-922-4455) AND VERIFY UTILITY MARK-OUT WITH THE OWNER PRIOR TO THE INITIATION OF ANY SITE DISTURBANCE.
- THE CONTRACTOR IS SOLELY RESPONSIBLE FOR VERIFYING THE LOCATION AND NATURE OF ALL SUBSURFACE UTILITIES AT THE PROJECT WHICH MAY BE AFFECTED BY THE WORK. COORDINATE WITH RESPECTIVE UTILITY OWNERS AND PERFORM VERIFICATION OF TYPE, LOCATION AND INVERTS AS REQUIRED.
- NOTIFY THE ENGINEER OF ANY AND ALL DISCREPANCIES BETWEEN EXISTING CONDITIONS AND THE CONTRACT DOCUMENTS BEFORE PROCEEDING WITH THAT PORTION OF THE WORK.
- THE LOCATIONS OF EXISTING SITE FEATURES AS SHOWN HAVE BEEN OBTAINED FROM MAPS, SURVEYS, FIELD INSPECTIONS, AND OTHER AVAILABLE INFORMATION. THEY MUST BE CONSIDERED APPROXIMATE BOTH TO LOCATION, SIZE, AND AS-BUILT CONDITION AND ARE PROVIDED FOR INFORMATIONAL PURPOSES ONLY. THE CONTRACTOR IS SOLELY RESPONSIBLE FOR DETERMINING ACTUAL FIELD CONDITIONS.
- THE DIMENSIONS SHOWN ON THE PLANS, INCLUDING THE INTENDED DIMENSIONS OF THE WORK, MAY VARY FROM ACTUAL EXISTING CONDITIONS IN THE FIELD. THE CONTRACTOR SHALL TAKE APPROPRIATE MEASUREMENTS TO VERIFY ALL DIMENSIONS SHOWN ON THE DRAWINGS AS WELL AS OTHER DIMENSIONS HE MAY DEEM APPROPRIATE TO FACILITATE THE COMPLETION OF THE WORK. NOTIFY THE ENGINEER OF ANY DISCREPANCIES BETWEEN EXISTING CONDITIONS AND THE CONTRACT DOCUMENTS BEFORE PROCEEDING WITH THAT PORTION OF THE WORK.
- IMPLEMENTING WORKER SAFETY AND/OR HEALTH PROTOCOLS THAT ADDRESS COMPLIANCE WITH RULES, LAWS, AND REGULATIONS PERTAINING TO CONSTRUCTION SAFETY AND/OR THE POTENTIAL AND/OR ACTUAL RISK OF EXPOSURE TO SITE-SPECIFIC PHYSICAL OR CHEMICAL HAZARDS IS SOLELY THE RESPONSIBILITY OF THE CONTRACTOR.
- THE SCHOOL FACILITY WILL BE OCCUPIED AND IN USE DURING THE COURSE OF THE WORK. PROVIDE SAFETY BARRIERS, INCLUDING BUT NOT LIMITED TO, FENCING, BARRICADES, AND SIGNAGE AS REQUIRED TO PREVENT UNAUTHORIZED ENTRY TO THE WORK AREA AT ALL TIMES.
- ALL CONSTRUCTION FENCING AND WARNING SIGNS SHALL BE INSTALLED PRIOR TO ANY CONSTRUCTION. INSTALL CONSTRUCTION FENCING AT THE LIMIT OF WORK.
- PROTECT ALL IMPROVEMENTS NOT INCLUDED IN THE SCOPE OF SITE DEMOLITION. ANY IMPROVEMENT WHICH IS DAMAGED SHALL BE REPAIRED OR REPLACED IN-KIND TO THE OWNER'S SATISFACTION.

LAYOUT & MATERIALS NOTES

- UNLESS OTHERWISE INDICATED, ALL DISTURBED AREAS SHALL BE RESTORED WITH SIX (6) INCHES OF LOAM, SEEDED, FERTILIZED, AND MULCHED. PROVIDE ADDITIONAL EROSION CONTROLS AS REQUIRED.
- THIS DRAWING IS INTENDED TO DEPICT THE LOCATION, LAYOUT, AND MATERIALS OF CONSTRUCTION AND IS INTENDED TO BE USED IN CONJUNCTION WITH THE DETAILS AND APPLICABLE SPECIFICATION SECTIONS.
- UNLESS OTHERWISE INDICATED, ALL DISTURBED AREAS SHALL BE RESTORED WITH SIX (6) INCHES OF LOAM, SEEDED, FERTILIZED, AND MULCHED. PROVIDE ADDITIONAL EROSION CONTROLS AS REQUIRED.
- ALL CURBING IS BITUMINOUS CONCRETE UNLESS OTHERWISE INDICATED.
- THE SLOPE OF HANDICAPPED PARKING SPACE AND ACCESS ISLE SHALL NOT EXCEED 1:48 (2%) IN ANY DIRECTION. ACCESS ISLES SHALL BE AT THE SAME ELEVATION AS THE PARKING SPACES THEY SERVE.
- ACCESSIBLE ROUTES SHALL COMPLY WITH CONNECTICUT BUILDING CODE. THE RUNNING SLOPE OF WALKING SURFACES SHALL NOT BE STEEPER THAN 1:20 (5%). THE CROSS SLOPE OF A WALKING SURFACE SHALL NOT BE STEEPER THAN 1:48 (2%).
- DIMENSIONS INDICATED ARE TO FACE OF CURB, PAVEMENT EDGE, EDGE OR CENTERLINE OF IMPROVEMENT, OR AS OTHERWISE NOTED.
- UNLESS OTHERWISE INDICATED, LINES ARE PARALLEL OR PERPENDICULAR TO LINE FROM WHICH THEY ARE MEASURED.
- UNLESS OTHERWISE INDICATED, BLEND TRANSITIONS IN ELEVATION BETWEEN NEW WORK AND AREAS TO REMAIN AT A MAXIMUM SLOPE OF 1V:2H AND RESTORE WITH FOUR (4) INCHES OF LOAM AND SEED. PROVIDE ADDITIONAL EROSION CONTROLS AS REQUIRED. COORDINATE WITH ENGINEER IF DIMENSIONAL CONSTRAINTS REQUIRE STEEPER SLOPES.
- GRADE TRANSITION BETWEEN TOPOGRAPHIC LINES AND SPOT GRADES SHALL BE UNIFORM UNLESS OTHERWISE INDICATED.

LEGEND

	- TOPOGRAPHY: MAJOR INTERVAL WITH LABEL
	- TOPOGRAPHY: MINOR INTERVAL
	- TOPOGRAPHY: SPOTGRADE
	- BITUMINOUS CONCRETE SIDEWALK/ACCESSWAY
	- ACCESSIBLE ACCESS PATHWAY
	- SILT FENCE
	- BITUMINOUS CONCRETE PAVEMENT
	- CONCRETE PAVEMENT
	- STONE DUST
	- LAWN
	- SIGN

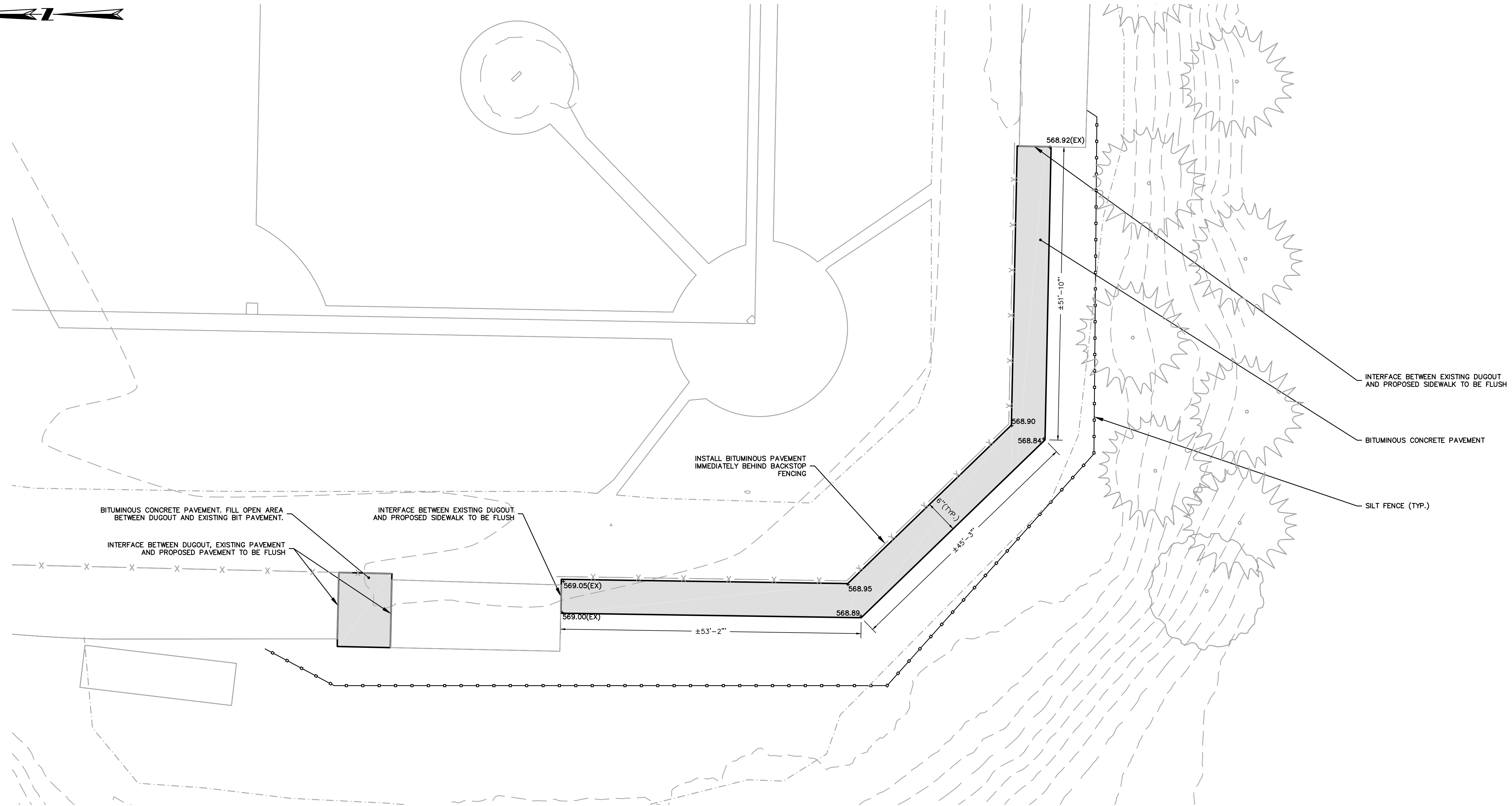

SITE PREPARATION NOTES

- CONTRACTOR SHALL NOTIFY 'CALL BEFORE YOU DIG' (1-800-922-4455) AND VERIFY UTILITY MARK-OUT WITH THE OWNER PRIOR TO THE INITIATION OF ANY SITE DISTURBANCE.
- THE CONTRACTOR IS SOLELY RESPONSIBLE FOR VERIFYING THE LOCATION AND NATURE OF ALL SUBSURFACE UTILITIES AT THE PROJECT WHICH MAY BE AFFECTED BY THE WORK. COORDINATE WITH RESPECTIVE UTILITY OWNERS AND PERFORM VERIFICATION OF TYPE, LOCATION AND INVERTS AS REQUIRED.
- NOTIFY THE ENGINEER OF ANY AND ALL DISCREPANCIES BETWEEN EXISTING CONDITIONS AND THE CONTRACT DOCUMENTS BEFORE PROCEEDING WITH THAT PORTION OF THE WORK.
- THE LOCATIONS OF EXISTING SITE FEATURES AS SHOWN HAVE BEEN OBTAINED FROM MAPS, SURVEYS, FIELD INSPECTIONS, AND OTHER AVAILABLE INFORMATION. THEY MUST BE CONSIDERED APPROXIMATE BOTH TO LOCATION, SIZE, AND AS-BUILT CONDITION AND ARE PROVIDED FOR INFORMATIONAL PURPOSES ONLY. THE CONTRACTOR IS SOLELY RESPONSIBLE FOR DETERMINING ACTUAL FIELD CONDITIONS.
- THE DIMENSIONS SHOWN ON THE PLANS, INCLUDING THE INTENDED DIMENSIONS OF THE WORK, MAY VARY FROM ACTUAL EXISTING CONDITIONS IN THE FIELD. THE CONTRACTOR SHALL TAKE APPROPRIATE MEASUREMENTS TO VERIFY ALL DIMENSIONS SHOWN ON THE DRAWINGS AS WELL AS OTHER DIMENSIONS HE MAY DEEM APPROPRIATE TO FACILITATE THE COMPLETION OF THE WORK. NOTIFY THE ENGINEER OF ANY DISCREPANCIES BETWEEN EXISTING CONDITIONS AND THE CONTRACT DOCUMENTS BEFORE PROCEEDING WITH THAT PORTION OF THE WORK.
- IMPLEMENTING WORKER SAFETY AND/OR HEALTH PROTOCOLS THAT ADDRESS COMPLIANCE WITH RULES, LAWS, AND REGULATIONS PERTAINING TO CONSTRUCTION SAFETY AND/OR THE POTENTIAL AND/OR ACTUAL RISK OF EXPOSURE TO SITE-SPECIFIC PHYSICAL OR CHEMICAL HAZARDS IS SOLELY THE RESPONSIBILITY OF THE CONTRACTOR.
- THE SCHOOL FACILITY WILL BE OCCUPIED AND IN USE DURING THE COURSE OF THE WORK. PROVIDE SAFETY BARRIERS, INCLUDING BUT NOT LIMITED TO, FENCING, BARRICADES, AND SIGNAGE AS REQUIRED TO PREVENT UNAUTHORIZED ENTRY TO THE WORK AREA AT ALL TIMES.
- ALL CONSTRUCTION FENCING AND WARNING SIGNS SHALL BE INSTALLED PRIOR TO ANY CONSTRUCTION. INSTALL CONSTRUCTION FENCING AT THE LIMIT OF WORK.
- PRIOR TO THE TERMINATION, ABANDONMENT, OR REMOVAL OF ANY UTILITY, VERIFY THAT APPLICABLE NOTIFICATIONS HAVE BEEN MADE TO THE UTILITY OWNER/OPERATOR AND THAT THE UTILITY HAS BEEN PROPERLY TERMINATED, CAPPED, OR PLUGGED AS REQUIRED.

- PROTECT ALL IMPROVEMENTS NOT INCLUDED IN THE SCOPE OF SITE DEMOLITION. ANY IMPROVEMENT WHICH IS DAMAGED SHALL BE REPAIRED OR REPLACED IN-KIND TO THE OWNER'S SATISFACTION.
- UNLESS OTHERWISE INDICATED, ALL DISTURBED AREAS SHALL BE RESTORED WITH SIX (6) INCHES OF LOAM, SEEDED, FERTILIZED, AND MULCHED. PROVIDE ADDITIONAL EROSION CONTROLS AS REQUIRED.

LAYOUT & MATERIALS NOTES

- THIS DRAWING IS INTENDED TO DEPICT THE LOCATION, LAYOUT, AND MATERIALS OF CONSTRUCTION AND IS INTENDED TO BE USED IN CONJUNCTION WITH THE DETAILS AND APPLICABLE SPECIFICATION SECTIONS.
- UNLESS OTHERWISE INDICATED, ALL DISTURBED AREAS SHALL BE RESTORED WITH SIX (6) INCHES OF LOAM, SEEDED, FERTILIZED, AND MULCHED. PROVIDE ADDITIONAL EROSION CONTROLS AS REQUIRED.
- ALL CURBING IS BITUMINOUS CONCRETE UNLESS OTHERWISE INDICATED.
- THE CROSS-SLOPE OF ANY SIDEWALK, WALKWAY, OR OTHER PEDESTRIAN SURFACE SHALL NOT BE STEEPER THAN 1:48 (2%).
- ACCESSIBLE ROUTES SHALL COMPLY WITH CONNECTICUT BUILDING CODE. THE RUNNING SLOPE OF WALKING SURFACES SHALL NOT BE STEEPER THAN 1:20 (5%). THE CROSS SLOPE OF A WALKING SURFACE SHALL NOT BE STEEPER THAN 1:48 (2%).
- DIMENSIONS INDICATED ARE TO FACE OF CURB, PAVEMENT EDGE, EDGE OR CENTERLINE OF IMPROVEMENT, OR AS OTHERWISE NOTED.
- UNLESS OTHERWISE INDICATED, LINES ARE PARALLEL OR PERPENDICULAR TO LINE FROM WHICH THEY ARE MEASURED.
- THE TOPS, RIMS, FRAMES, GRATES, AND COVERS (AS APPLICABLE) OF ALL UTILITY STRUCTURES THAT ARE TO REMAIN SHALL BE ADJUSTED TO MATCH FINAL GRADE IN A FLUSH CONDITION. ALL NEW UTILITY STRUCTURES SHALL BE INSTALLED WITH TOPS, RIMS, FRAMES, GRATES, AND COVERS (AS APPLICABLE) TO FINAL GRADE IN A FLUSH CONDITION.
- UNLESS OTHERWISE INDICATED, BLEND TRANSITIONS IN ELEVATION BETWEEN NEW WORK AND AREAS TO REMAIN AT A MAXIMUM SLOPE OF 1V:2H AND RESTORE WITH FOUR (4) INCHES OF LOAM AND SEED. PROVIDE ADDITIONAL EROSION CONTROLS AS REQUIRED. COORDINATE WITH ENGINEER IF DIMENSIONAL CONSTRAINTS REQUIRE STEEPER SLOPES.
- GRADE TRANSITION BETWEEN TOPOGRAPHIC LINES AND SPOT GRADES SHALL BE UNIFORM UNLESS OTHERWISE INDICATED.

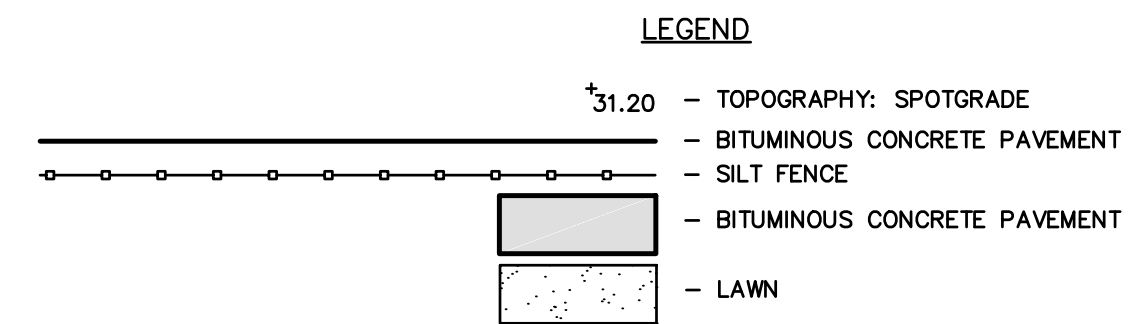

ISSUED FOR BID



JESSE A. HARRIS NO. 1224

ATHLETIC FACILITY IMPROVEMENTS AT RHAM HIGH SCHOOL

85 WALL STREET
IN
HEBRON
CONNECTICUT

BASEBALL DUGOUT ACCESSIBILITY PLAN

MAY 15, 2019

REVISIONS:

PREPARED FOR:
REGIONAL SCHOOL DISTRICT NO. 8
P.O. BOX 1438
HEBRON, CT 06248



© 2018 BSC GROUP, INC.
SCALE: 1" = 10'



FILE: 83623.05-LM_NEW.DWG
DWG. NO:
JOB. NO: 83623.05

L-2.0

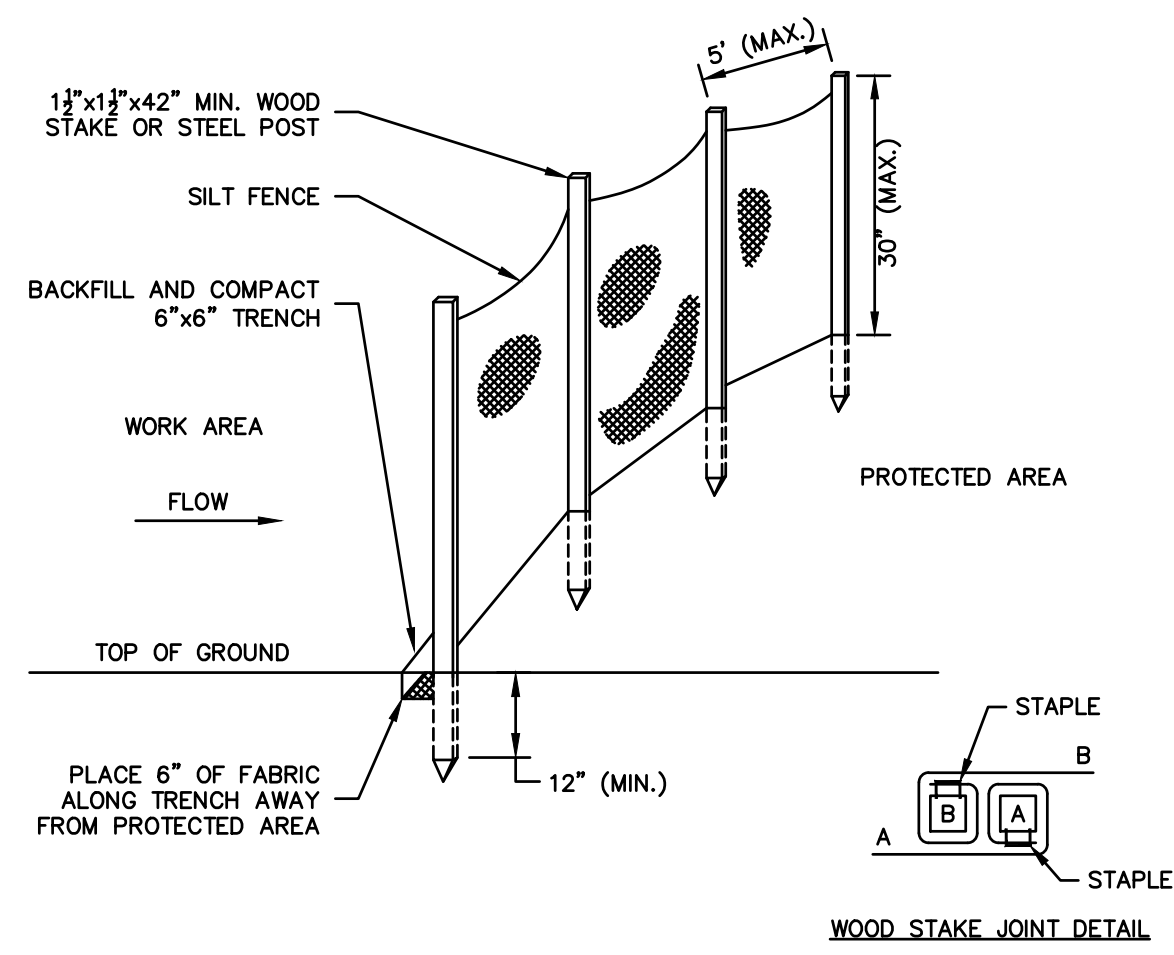

- NOTES:
1. FOR SLOPE & SWALE INSTALLATIONS, EXTEND FENCE UP SLOPE SUCH THAT BOTTOM ENDS OF FENCE WILL BE HIGHER THAN THE TOP OF THE LOWEST PORTION OF FENCE.
 2. FOR FENCE INSTALLED ON LEVEL TERRAIN INSTALL WING SECTIONS PERPENDICULAR TO MAIN BARRIER AT 50'-100' INTERVALS.

1 SILT FENCE BARRIER
SCALE: NONE

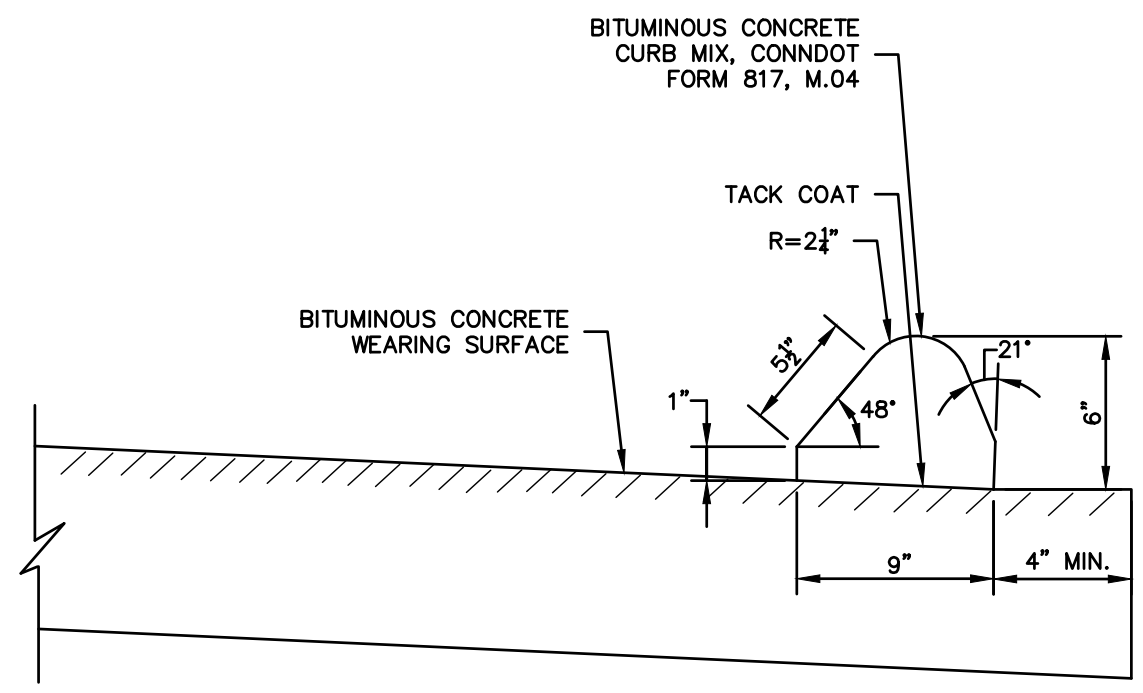

2 6" BITUMINOUS CONCRETE LIP CURBING
SCALE: NONE

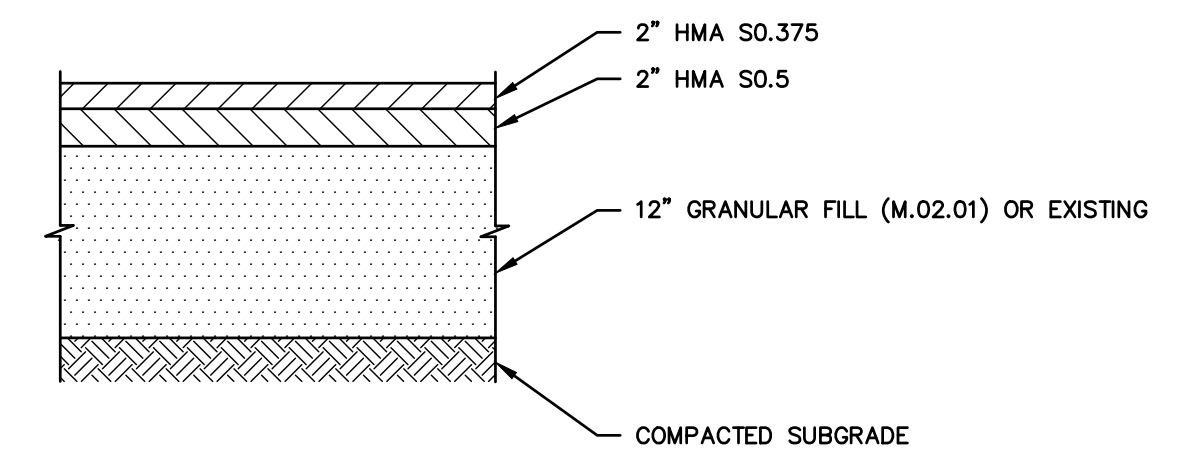

3 BITUMINOUS CONCRETE PAVEMENT
SCALE: NONE

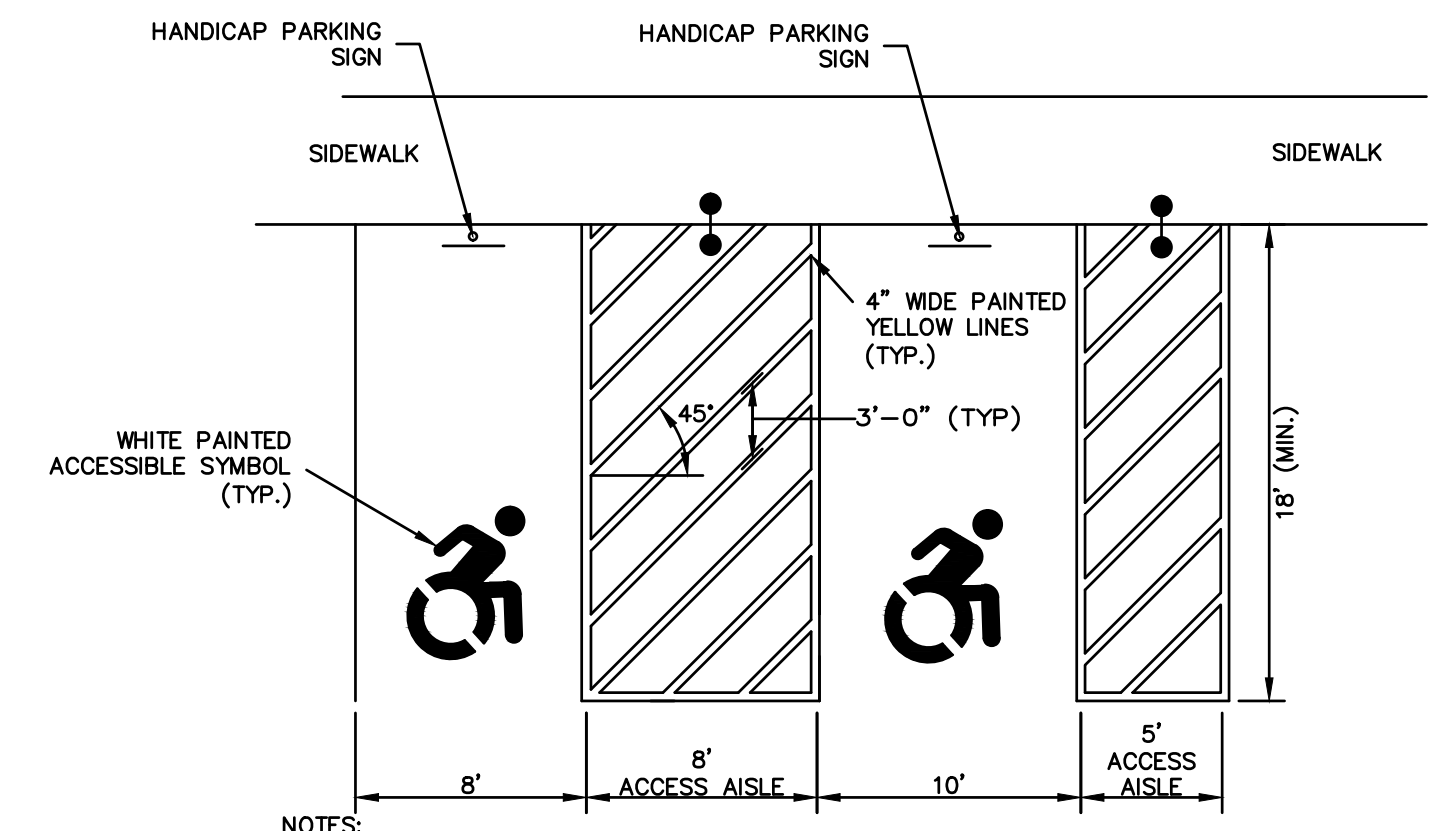

- NOTES:
1. GRADING WITHIN HANDICAP SPACES AND ACCESS AISLES SHALL BE LESS THAN 2.00% IN ALL DIRECTIONS.
 2. WIDTH MEASUREMENTS OF PARKING SPACES AND ADJACENT ACCESS AISLES SHALL BE MADE FROM THE CENTERLINE OF MARKING.
 3. ALL MARKINGS SHALL BE FAST-DRYING WATERBORNE PAINT, LOW VOC, 100 PERCENT ACRYLIC ASTM D1475 AND ASTM D211.
 4. YELLOW: FS 595, NO. 15538 OR LATEST ISSUE.
 5. WHITE: NO DARKER OR YELLOWER THAN FS 595, NO. 17778, LATEST ISSUE.

4 ACCESSIBLE PARKING SPACES
SCALE: NONE

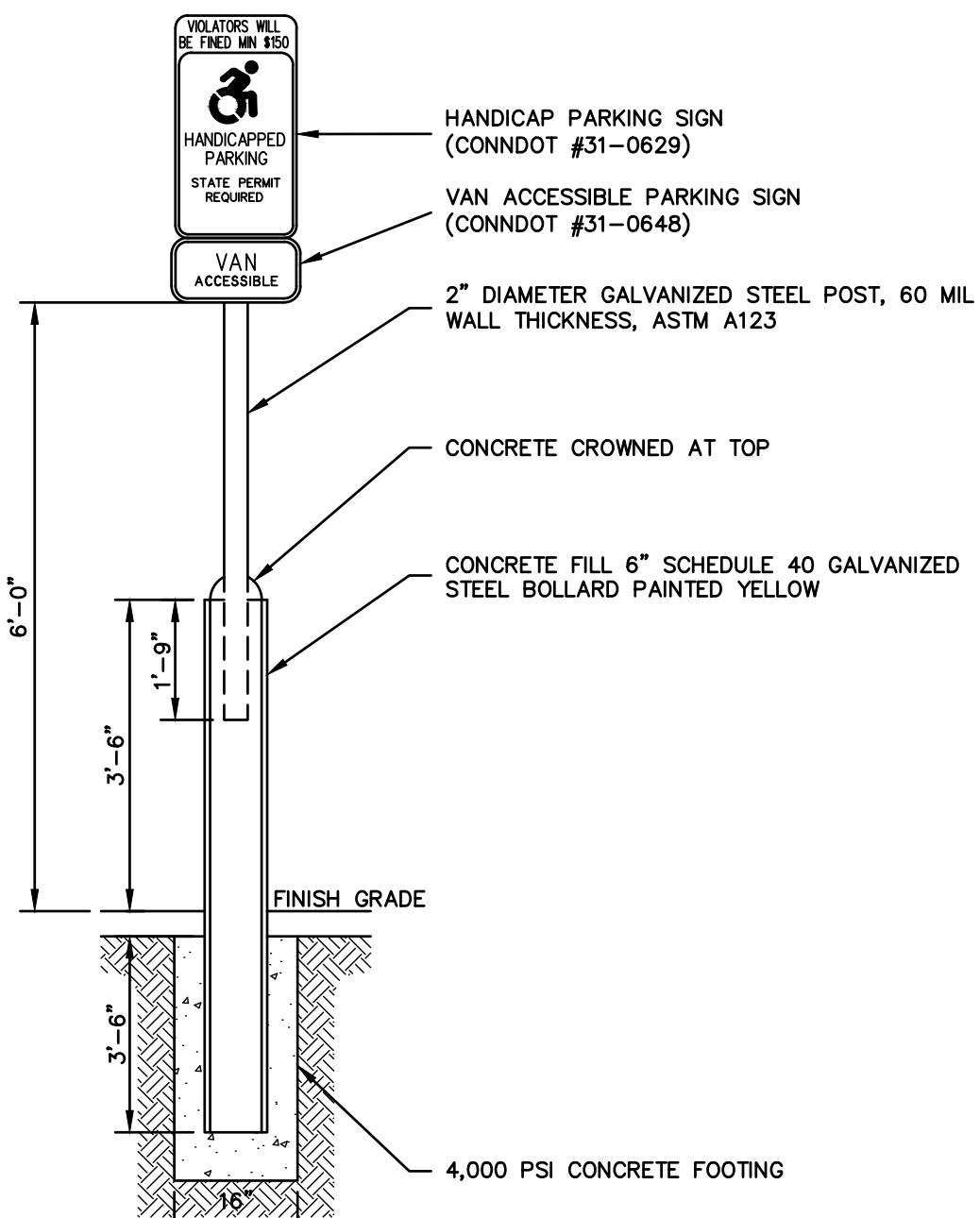

5 BOLLARD MOUNTED SIGN
SCALE:

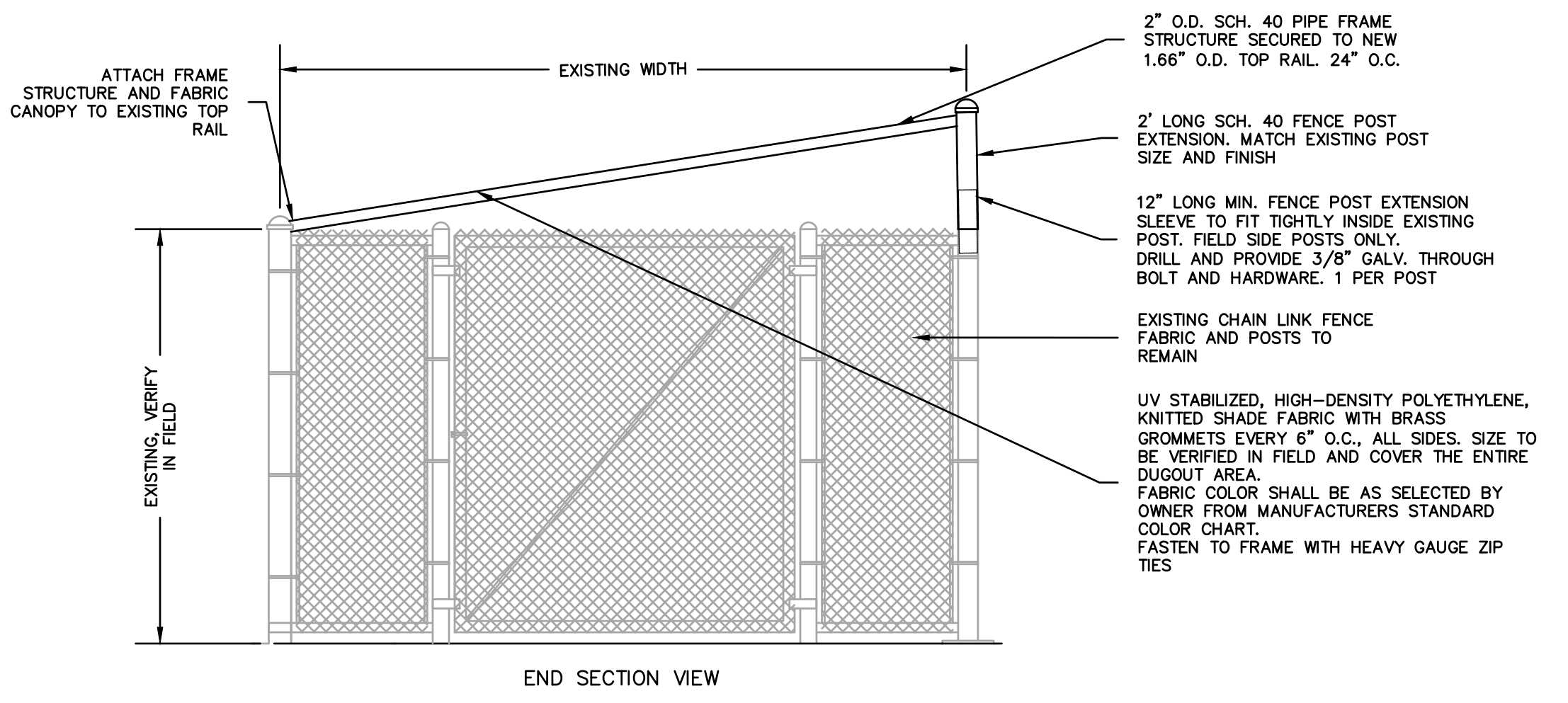

6 DUGOUT CANOPY AT EXISTING DUGOUT - ADD ALT. 1
SCALE: NONE

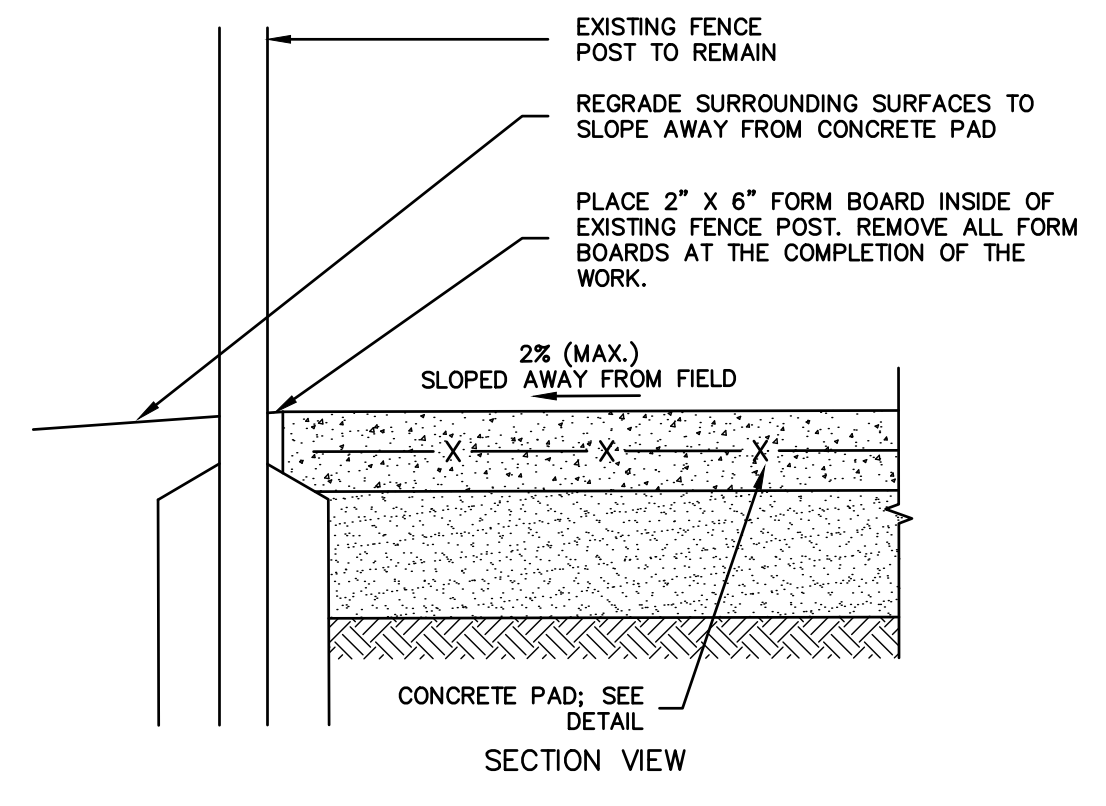

- NOTES:
1. REGRADE AS REQUIRED TO PROVIDE A SMOOTH TRANSITION FROM TOP OF CONCRETE TO EXISTING SURFACES.

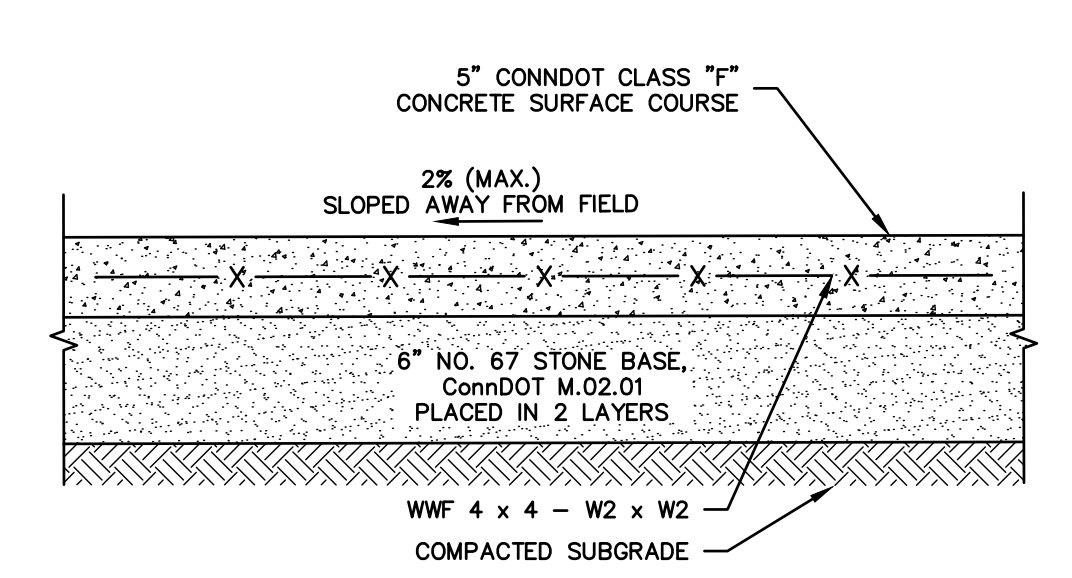

- NOTES:
1. TOOLED CONTROL JOINTS SHALL BE 1/4 SLAB THICKNESS. TOOL JOINTS EARLY IN FINISHING PROCESS AND RE-RUN TO ENSURE GROOVE BOND HAS NOT OCCURRED.
 2. CONCRETE SHALL HAVE LIGHT BROOM FINISH.

7 DUGOUT CONCRETE PAD - ADD ALT. 1
SCALE: NONE

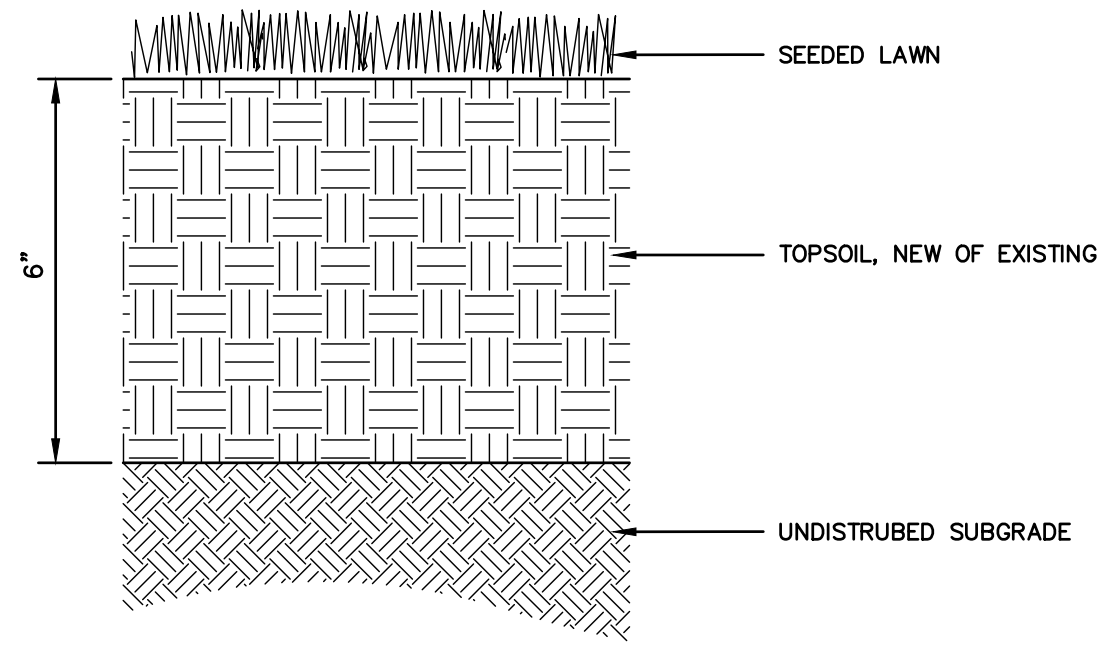

- NOTES:
1. CONTRACTOR SHALL PREPARE SOILS IN ALL DISTURBED AREAS AND AREAS USED FOR EQUIPMENT ACCESS.
 2. SEED MIXTURE SHALL BE 25% KENTUCKY BLUEGRASS, 25% CREEPING FESCUE, 25% TURF TYPE TALL FESCUE, 25% PERENNIAL RYEGRASS, OR APPROVED EQUAL.

8 LAWN
SCALE: NONE



JESSE A. HARRIS NO. 1224

ATHLETIC FACILITY IMPROVEMENTS AT RHAM HIGH SCHOOL

85 WALL STREET
IN
HEBRON CONNECTICUT
DETAILS

MAY 15, 2019

REVISIONS:

PREPARED FOR:
REGIONAL SCHOOL DISTRICT NO. 8
P.O. BOX 1438
HEBRON, CT 06248

BSC GROUP
300 Winding Brook Drive
Glastonbury, Connecticut 06033
860 652 8227

© 2018 BSC GROUP, INC.
SCALE: AS NOTED
0 .5 1 2 FEET

FILE: 83623.05-LM_NEW.DWG
DWG. NO:
JOB. NO: 83623.05 **L-3.0**

ISSUED FOR BID