

Town of West Hartford, Connecticut
Department of Financial Services Purchasing Services Division
50 South Main Street, West Hartford, CT 06107-2431

INVITATION TO BID

Bid No. 6707F	Opening Date May 28, 2019	Opening Time 2:30 PM	<input checked="" type="checkbox"/> Formal Bid	<input type="checkbox"/> Informal Bid	THIS IS <u>NOT</u> AN ORDER
-------------------------	-------------------------------------	--------------------------------	---	--	------------------------------------

This **INVITATION TO BID** form, with your response on it, must be received by the Purchasing Services Division, at the above address, prior to the bid opening at the time and date shown above. Bids must contain an original signature and must be submitted in a sealed envelope. All bid envelopes must indicate the bid number, time and opening date. At the designated time, all bids will be publicly opened and read. **THIS IS SUBJECT TO THE TERMS AND CONDITIONS ATTACHED AS WELL AS ALL ATTACHED SPECIFICATION SHEETS AND DRAWINGS.**

Department: Plant & Facilities	Division: Maintenance	Required Delivery Date	Requisition No.:
Shipping Destination: Duffy Elementary School 95 Westminster Dr, West Hartford, Ct 06107			
DESCRIPTION	UNIT PRICE	TOTAL	
<p>The Town of West Hartford is seeking a qualified Contractor to furnish and install 11,810 square feet of Johnsonite Cortina Grande Floor Tiles per the attached specifications at Duffy Elementary School located at 95 Westminster Drive, West Hartford, CT 06107. Installation is to be based on manufacturer recommendations to honor warranty. Color of tiles shall be chosen at time of award. Contractors will have access to the facility as early as July 16, 2019.</p> <p>Contractors are strongly encouraged to attend the pre-bid meeting on May 14, 2019 at 1:30 PM at Duffy E. S., 95 Westminster Dr., West Hartford. This will allow access to the site and discussion with the project team.</p> <p>Insurance Requirements per the attached Insurance Exhibit.</p> <p>This project meets criteria for CT Prevailing Wage Regulations. Attached are the wages for this project. Contractors shall submit proper prevailing wage documents throughout project.</p> <p>All work must conform to all Federal, State, and Local Building and Health Codes.</p>	<p>\$ _____ BASE BID: TILE INSTALLATION</p> <p>\$ _____ LEVELING / SF</p> <p>\$ _____ MITIGATION / SF</p>	<p>TOTAL \$</p>	

We hereby agree to furnish and invoice above listed materials or services, delivered or performed in accordance with your specifications, requirements and terms as specified herein at prices specified above.

Bidders are encouraged to attend the Town's bid opening at which time the public is afforded an opportunity to record bid prices received in response to the Town's solicitation. Bidders who would like the results of the bid but are unable to attend the bid opening, may check the Town website, <http://west-hartfordct.gov> a week after the bid opening date. Bidders calling the Purchasing Office for bid results will be referred to the above procedure. The bidder agrees that by affixing their signature to this request for bids, the authorized signatory grants approval to the Town Of West Hartford to obtain third party credit reports for the purpose of assessing the financial capacity of the business entity tendering such bid to the Town.

Delivery Date	Shipment via	FEIN #	Terms % DAYS
EMAIL ADDRESS:			
Vendor Name		Address	City, State, Zip
Telephone	Fax No	Authorized Signature	Printed Name Title
NOTE: Failure to affix an authorized signature to this form will result in rejection of the bid.			

FLOORING INSTALLATION AT DUFFY ELEMENTARY SCHOOL

SPECIFICATIONS

MAY 3, 2019

The Town of West Hartford is seeking a qualified Contractor to furnish and install 11,810 square feet of Johnsonite Cortina Grande Floor Tiles at Duffy Elementary School located at 95 Westminster Drive, West Hartford, CT 06107. Installation is to be based on manufacturer recommendations to honor warranty. Color of tiles shall be chosen at time of award. The contractor will be provided a clean work site. The contractor shall include one layer of leveling as part of the tile installation base bid. For the purpose of this project, one layer shall be up to 1/8" of leveling.

Supply and install 6" Johnsonite Cove Base (black)

Areas not covered by cove base to be caulked with color matching caulk including but not limited to door jambs, access plates and any other area not covered with cove base.

Floors tiles to be cut within 1/8" of jamb or wall.

All Access plates are to be flush with new flooring tile.

Transition strips are to be included in all areas where old flooring meets new flooring.

The project area will 11,810 square feet including offices, classrooms, lobbies, stairwell landings, closets and hallways. See attached asbestos plan for area in scope of work. Any discrepancies in the square footage are to be brought the Town of West Hartford's attention during the bid process in the form of a questions which will be responded to in an addendum otherwise the town's square foot measurement will be used throughout the contract.

The town will be responsible for moisture testing. However, the contractor may be required to provide moisture reduction barrier to meet the manufacturer's installation requirements. . A Separate Square foot cost for moisture mitigation. Any thickness to the base flooring added by the moisture mitigation process will not be included to the base bid leveling coat. This also includes any surface preparation that might be need prior to the moisture mitigation process.

A separate cost for leveling above the 1/8" shall be provided in the event these items are needed.

Contractors must adhere to the attached prevailing wage determination

The contractor shall adhere to the conditions defined in the Indemnification and Insurance Exhibit.

This installation is to be 100% complete. Any discrepancies in the scope of work, sketches or exclusion that would affect the project should be brought up at the site inspection during the pre-bid walk through.

This project shall have a one year warranty on materials and workmanship or as given by the manufacturer whichever is greater.

All work must conform to all Federal, State, and Local Building and Health Codes.

Project: Flooring Installation At Duffy Elementary School

**Minimum Rates and Classifications
for Building Construction**

ID# : B 26005

**Connecticut Department of Labor
Wage and Workplace Standards Division**

By virtue of the authority vested in the Labor Commissioner under provisions of Section 31-53 of the General Statutes of Connecticut, as amended, the following are declared to be the prevailing rates and welfare payments and will apply only where the contract is advertised for bid within 20 days of the date on which the rates are established. Any contractor or subcontractor not obligated by agreement to pay to the welfare and pension fund shall pay this amount to each employee as part of his/her hourly wages.

Project Number:

Project Town: West Hartford

State#:

FAP#:

Project: Flooring Installation At Duffy Elementary School

CLASSIFICATION	Hourly Rate	Benefits
1a) Asbestos Worker/Insulator (Includes application of insulating materials, protective coverings, coatings, & finishes to all types of mechanical systems; application of firestopping material for wall openings & penetrations in walls, floors, ceilings	38.25	27.96
1b) Asbestos/Toxic Waste Removal Laborers: Asbestos removal and encapsulation (except its removal from mechanical systems which are not to be scrapped), toxic waste removers, blasters.**See Laborers Group 7**		
1c) Asbestos Worker/Heat and Frost Insulator	40.21	29.30

As of: Friday, May 03, 2019

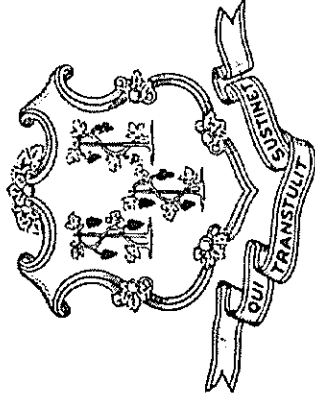

THIS IS A PUBLIC WORKS PROJECT

Covered by the

PREVAILING WAGE LAW

CT General Statutes Section 31-53

**If you have QUESTIONS regarding your wages
CALL (860) 263-6790**

Section 31-55 of the CT State Statutes requires every contractor or subcontractor performing work for the state to post in a prominent place the prevailing wages as determined by the Labor Commissioner.

Sec. 31-53b. Construction safety and health course. New miner training program. Proof of completion required for mechanics, laborers and workers on public works projects. Enforcement. Regulations. Exceptions. (a) Each contract for a public works project entered into on or after July 1, 2009, by the state or any of its agents, or by any political subdivision of the state or any of its agents, described in subsection (g) of section 31-53, shall contain a provision requiring that each contractor furnish proof with the weekly certified payroll form for the first week each employee begins work on such project that any person performing the work of a mechanic, laborer or worker pursuant to the classifications of labor under section 31-53 on such public works project, pursuant to such contract, has completed a course of at least ten hours in duration in construction safety and health approved by the federal Occupational Safety and Health Administration or, has completed a new miner training program approved by the Federal Mine Safety and Health Administration in accordance with 30 CFR 48 or, in the case of telecommunications employees, has completed at least ten hours of training in accordance with 29 CFR 1910.268.

(b) Any person required to complete a course or program under subsection (a) of this section who has not completed the course or program shall be subject to removal from the worksite if the person does not provide documentation of having completed such course or program by the fifteenth day after the date the person is found to be in noncompliance. The Labor Commissioner or said commissioner's designee shall enforce this section.

(c) Not later than January 1, 2009, the Labor Commissioner shall adopt regulations, in accordance with the provisions of chapter 54, to implement the provisions of subsections (a) and (b) of this section. Such regulations shall require that the ten-hour construction safety and health courses required under subsection (a) of this section be conducted in accordance with federal Occupational Safety and Health Administration Training Institute standards, or in accordance with Federal Mine Safety and Health Administration Standards or in accordance with 29 CFR 1910.268, as appropriate. The Labor Commissioner shall accept as sufficient proof of compliance with the provisions of subsection (a) or (b) of this section a student course completion card issued by the federal Occupational Safety and Health Administration Training Institute, or such other proof of compliance said commissioner deems appropriate, dated no earlier than five years before the commencement date of such public works project.

(d) This section shall not apply to employees of public service companies, as defined in section 16-1, or drivers of commercial motor vehicles driving the vehicle on the public works project and delivering or picking up cargo from public works projects provided they perform no labor relating to the project other than the loading and unloading of their cargo.

(P.A. 06-175, S. 1; P.A. 08-83, S. 1.)

History: P.A. 08-83 amended Subsec. (a) by making provisions applicable to public works project contracts entered into on or after July 1, 2009, replacing provision re total cost of work with reference to Sec. 31-53(g), requiring proof in certified payroll form that new mechanic, laborer or worker has completed a 10-hour or more construction safety course and adding provision re new miner training program, amended Subsec. (b) by substituting "person" for "employee" and adding "or program", amended Subsec. (c) by adding "or in accordance with Federal Mine Safety and Health Administration Standards" and setting new deadline of January 1, 2009, deleted former Subsec. (d) re "public building", added new Subsec. (d) re exemptions for public service company employees and delivery drivers who perform no labor other than delivery and made conforming and technical changes, effective January 1, 2009.

Informational Bulletin

THE 10-HOUR OSHA CONSTRUCTION SAFETY AND HEALTH COURSE

(applicable to public building contracts entered into *on or after July 1, 2007*, where the total cost of all work to be performed is at least \$100,000)

- (1) This requirement was created by Public Act No. 06-175, which is codified in Section 31-53b of the Connecticut General Statutes (pertaining to the prevailing wage statutes);
- (2) The course is required for public building construction contracts (projects funded in whole or in part by the state or any political subdivision of the state) entered into on or after July 1, 2007;
- (3) It is required of private employees (not state or municipal employees) and apprentices who perform manual labor for a general contractor or subcontractor on a public building project where the total cost of all work to be performed is at least \$100,000;
- (4) The ten-hour construction course pertains to the ten-hour Outreach Course conducted in accordance with federal OSHA Training Institute standards, and, for telecommunications workers, a ten-hour training course conducted in accordance with federal OSHA standard, 29 CFR 1910.268;
- (5) The internet website for the federal OSHA Training Institute is http://www.osha.gov/fso/ote/training/edcenters/fact_sheet.html;
- (6) The statutory language leaves it to the contractor and its employees to determine who pays for the cost of the ten-hour Outreach Course;
- (7) Within 30 days of receiving a contract award, a general contractor must furnish proof to the Labor Commissioner that all employees and apprentices performing manual labor on the project will have completed such a course;
- (8) Proof of completion may be demonstrated through either: (a) the presentation of a *bona fide* student course completion card issued by the federal OSHA Training Institute; *or* (2) the presentation of documentation provided to an employee by a trainer certified by the Institute pending the actual issuance of the completion card;
- (9) Any card with an issuance date more than 5 years prior to the commencement date of the construction project shall not constitute proof of compliance;

- (10) Each employer shall affix a copy of the construction safety course completion card to the certified payroll submitted to the contracting agency in accordance with Conn. Gen. Stat. § 31-53(f) on which such employee's name first appears;
- (11) Any employee found to be in non-compliance shall be subject to removal from the worksite if such employee does not provide satisfactory proof of course completion to the Labor Commissioner by the fifteenth day after the date the employee is determined to be in noncompliance;
- (12) Any such employee who is determined to be in noncompliance may continue to work on a public building construction project for a maximum of fourteen consecutive calendar days while bringing his or her status into compliance;
- (13) The Labor Commissioner may make complaint to the prosecuting authorities regarding any employer or agent of the employer, or officer or agent of the corporation who files a false certified payroll with respect to the status of an employee who is performing manual labor on a public building construction project;
- (14) The statute provides the minimum standards required for the completion of a safety course by manual laborers on public construction contracts; any contractor can exceed these minimum requirements; and
- (15) Regulations clarifying the statute are currently in the regulatory process, and shall be posted on the CTDOL website as soon as they are adopted in final form.
- (16) Any questions regarding this statute may be directed to the Wage and Workplace Standards Division of the Connecticut Labor Department via the internet website of <http://www.ctdol.state.ct.us/wgwkstnd/wgemenu.htm>; or by telephone at (860)263-6790.

THE ABOVE INFORMATION IS PROVIDED EXCLUSIVELY AS AN EDUCATIONAL RESOURCE, AND IS NOT INTENDED AS A SUBSTITUTE FOR LEGAL INTERPRETATIONS WHICH MAY ULTIMATELY ARISE CONCERNING THE CONSTRUCTION OF THE STATUTE OR THE REGULATIONS.

November 29, 2006

Notice

To All Mason Contractors and Interested Parties Regarding Construction Pursuant to Section 31-53 of the Connecticut General Statutes (Prevailing Wage)

The Connecticut Labor Department Wage and Workplace Standards Division is empowered to enforce the prevailing wage rates on projects covered by the above referenced statute.

Over the past few years the Division has withheld enforcement of the rate in effect for workers who operate a forklift on a prevailing wage rate project due to a potential jurisdictional dispute.

The rate listed in the schedules and in our Occupational Bulletin (see enclosed) has been as follows:

Forklift Operator:

- **Laborers (Group 4) Mason Tenders** - operates forklift solely to assist a mason to a maximum height of nine feet only.

- **Power Equipment Operator (Group 9)** - operates forklift to assist any trade and to assist a mason to a height over nine feet.

The U.S. Labor Department conducted a survey of rates in Connecticut but it has not been published and the rate in effect remains as outlined in the above Occupational Bulletin.

Since this is a classification matter and not one of jurisdiction, effective January 1, 2007 the Connecticut Labor Department will enforce the rate on each schedule in accordance with our statutory authority.

Your cooperation in filing appropriate and accurate certified payrolls is appreciated.

STATUTE 31-55a

- SPECIAL NOTICE -

To: All State and Political Subdivisions, Their Agents, and Contractors

Connecticut General Statute 31-55a - Annual adjustments to wage rates by contractors doing state work.

Each contractor that is awarded a contract on or after October 1, 2002, for (1) the construction of a state highway or bridge that falls under the provisions of section 31-54 of the general statutes, or (2) the construction, remodeling, refinishing, refurbishing, rehabilitation, alteration or repair of any public works project that falls under the provisions of section 31-53 of the general statutes shall contact the Labor Commissioner on or before July first of each year, for the duration of such contract, to ascertain the prevailing rate of wages on an hourly basis and the amount of payment or contributions paid or payable on behalf of each mechanic, laborer or worker employed upon the work contracted to be done, and shall make any necessary adjustments to such prevailing rate of wages and such payment or contributions paid or payable on behalf of each such employee, effective each July first.

- The prevailing wage rates applicable to any contract or subcontract awarded on or after October 1, 2002 are subject to annual adjustments each July 1st for the duration of any project which was originally advertised for bids on or after October 1, 2002.
- Each contractor affected by the above requirement shall pay the annual adjusted prevailing wage rate that is in effect each July 1st, as posted by the Department of Labor.
- It is the **contractor's** responsibility to obtain the annual adjusted prevailing wage rate increases directly from the Department of Labor's Web Site. The annual adjustments will be posted on the Department of Labor Web page: www.ctdol.state.ct.us. For those without internet access, please contact the division listed below.
- The Department of Labor will continue to issue the initial prevailing wage rate schedule to the Contracting Agency for the project. All subsequent annual adjustments will be posted on our Web Site for contractor access.

Any questions should be directed to the Contract Compliance Unit, Wage and Workplace Standards Division, Connecticut Department of Labor, 200 Folly Brook Blvd., Wethersfield, CT 06109 at (860)263-6790.

**Connecticut Department of Labor
Wage and Workplace Standards Division
FOOTNOTES**

- ⇒ Please Note: If the “Benefits” listed on the schedule for the following occupations includes a letter(s) (+ a or + a+b for instance), refer to the information below.

Benefits to be paid at the appropriate prevailing wage rate for the listed occupation.

If the “Benefits” section for the occupation lists only a dollar amount, disregard the information below.

Bricklayers, Cement Masons, Cement Finishers, Concrete Finishers, Stone Masons
(Building Construction) and
(Residential- Hartford, Middlesex, New Haven, New London and Tolland Counties)

- a. Paid Holiday: Employees shall receive 4 hours for Christmas Eve holiday provided the employee works the regularly scheduled day before and after the holiday. Employers may schedule work on Christmas Eve and employees shall receive pay for actual hours worked in addition to holiday pay.

Elevator Constructors: Mechanics

- a. Paid Holidays: New Year’s Day, Memorial Day, Independence Day, Labor Day, Veterans’ Day, Thanksgiving Day, Christmas Day, plus the Friday after Thanksgiving.
- b. Vacation: Employer contributes 8% of basic hourly rate for 5 years or more of service or 6% of basic hourly rate for 6 months to 5 years of service as vacation pay credit.

Glaziers

- a. Paid Holidays: Labor Day and Christmas Day.

Power Equipment Operators
(Heavy and Highway Construction & Building Construction)

- a. Paid Holidays: New Year’s Day, Good Friday, Memorial day, Independence Day, Labor Day, Thanksgiving Day and Christmas Day, provided the employee works 3 days during the week in which the holiday falls, if scheduled, and if scheduled, the working day before and the working day after the holiday. Holidays falling on Saturday may be observed on Saturday, or if the employer so elects, on the preceding Friday.

Ironworkers

- a. Paid Holiday: Labor Day provided employee has been on the payroll for the 5 consecutive work days prior to Labor Day.

Laborers (Tunnel Construction)

- a. Paid Holidays: New Year's Day, Memorial Day, Independence Day, Labor Day, Thanksgiving Day and Christmas Day. No employee shall be eligible for holiday pay when he fails, without cause, to work the regular work day preceding the holiday or the regular work day following the holiday.

Roofers

- a. Paid Holidays: July 4th, Labor Day, and Christmas Day provided the employee is employed 15 days prior to the holiday.

Sprinkler Fitters

- a. Paid Holidays: Memorial Day, July 4th, Labor Day, Thanksgiving Day and Christmas Day, provided the employee has been in the employment of a contractor 20 working days prior to any such paid holiday.

Truck Drivers

(Heavy and Highway Construction & Building Construction)

- a. Paid Holidays: New Year's Day, Memorial Day, Independence Day, Labor Day, Thanksgiving Day, Christmas day, and Good Friday, provided the employee has at least 31 calendar days of service and works the last scheduled day before and the first scheduled day after the holiday, unless excused.

Project: Flooring Installation At Duffy Elementary School

2) Boilermaker	38.34	26.01
----------------	-------	-------

3a) Bricklayer, Cement Mason, Concrete Finisher (including caulking), Stone Masons	34.72	32.55 + a
---	-------	-----------

3b) Tile Setter	34.90	25.87
-----------------	-------	-------

3c) Terrazzo Mechanics and Marble Setters	31.69	22.35
---	-------	-------

3d) Tile, Marble & Terrazzo Finishers	26.70	21.75
---------------------------------------	-------	-------

3e) Plasterer	33.48	32.06
---------------	-------	-------

As of: Friday, May 03, 2019

Project: Flooring Installation At Duffy Elementary School

-----LABORERS-----

4) Group 1: Laborers (common or general), acetylene burners, concrete specialists, wrecking laborers, fire watchers.	30.05	20.10
--	-------	-------

4a) Group 2: Mortar mixers, plaster tender, power buggy operators, powdermen, fireproofers/mixer/nozzleman (Person running mixer and spraying fireproof only).	30.30	20.10
--	-------	-------

4b) Group 3: Jackhammer operators/pavement breaker, mason tender (brick), mason tender (cement/concrete), forklift operators and forklift operators (masonry).	30.55	20.10
--	-------	-------

4c) **Group 4: Pipelayers (Installation of water, storm drainage or sewage lines outside of the building line with P6, P7 license) (the pipelayer rate shall apply only to one or two employees of the total crew who primary task is to actually perform the mating of pipe sections) P6 and P7 rate is \$26.80.	30.55	20.10
---	-------	-------

4d) Group 5: Air track operator, sand blaster and hydraulic drills.	30.55	20.10
---	-------	-------

As of: Friday, May 03, 2019

Project: Flooring Installation At Duffy Elementary School

4e) Group 6: Blasters, nuclear and toxic waste removal.	31.80	20.10
---	-------	-------

4f) Group 7: Asbestos/lead removal and encapsulation (except it's removal from mechanical systems which are not to be scrapped).	31.05	20.10
--	-------	-------

4g) Group 8: Bottom men on open air caisson, cylindrical work and boring crew.	28.38	20.10
--	-------	-------

4h) Group 9: Top men on open air caisson, cylindrical work and boring crew.	27.86	20.10
---	-------	-------

4i) Group 10: Traffic Control Signalman	16.00	20.10
---	-------	-------

5) Carpenter, Acoustical Ceiling Installation, Soft Floor/Carpet Laying, Metal Stud Installation, Form Work and Scaffold Building, Drywall Hanging, Modular-Furniture Systems Installers, Lathers, Piledrivers, Resilient Floor Layers.	32.60	25.34
---	-------	-------

As of: Friday, May 03, 2019

Project: Flooring Installation At Duffy Elementary School

5a) Millwrights	33.14	25.74
-----------------	-------	-------

6) Electrical Worker (including low voltage wiring) (Trade License required: E1,2 L-5,6 C-5,6 T-1,2 L-1,2 V-1,2,7,8,9)	40.00	25.97+3% of gross wage
--	-------	------------------------

7a) Elevator Mechanic (Trade License required: R-1,2,5,6)	53.37	33.705+a+b
---	-------	------------

-----LINE CONSTRUCTION-----

Groundman	26.50	6.5% + 9.00
-----------	-------	-------------

Linemen/Cable Splicer	48.19	6.5% + 22.00
-----------------------	-------	--------------

As of: Friday, May 03, 2019

Project: Flooring Installation At Duffy Elementary School

8) Glazier (Trade License required: FG-1,2)	37.18	21.05 + a
---	-------	-----------

9) Ironworker, Ornamental, Reinforcing, Structural, and Precast Concrete Erection	35.47	35.14 + a
---	-------	-----------

----OPERATORS----

Group 1: Crane handling or erecting structural steel or stone, hoisting engineer 2 drums or over, front end loader (7 cubic yards or over), work boat 26 ft. and over and Tunnel Boring Machines. (Trade License Required)	39.55	24.30 + a
--	-------	-----------

Group 2: Cranes (100 ton rate capacity and over); Excavator over 2 cubic yards; Piledriver (\$3.00 premium when operator controls hammer); Bauer Drill/Caisson. (Trade License Required)	39.23	24.30 + a
--	-------	-----------

Group 3: Excavator; Backhoe/Excavator under 2 cubic yards; Cranes (under 100 ton rated capacity), Grader/Blade; Master Mechanic; Hoisting Engineer (all types of equipment where a drum and cable are used to hoist or drag material regardless of motive power of operation), Rubber Tire Excavator (Drott-1085 or similar); Grader Operator; Bulldozer Fine Grade. (slopes, shaping, laser or GPS, etc.). (Trade License Required)	38.49	24.30 + a
--	-------	-----------

As of: **Friday, May 03, 2019**

Project: Flooring Installation At Duffy Elementary School

Group 4: Trenching Machines; Lighter Derrick; Concrete Finishing Machine; CMI Machine or Similar; Koehring Loader (Skooper).	38.10	24.30 + a
--	-------	-----------

Group 5: Specialty Railroad Equipment; Asphalt Paver; Asphalt Reclaiming Machine; Line Grinder; Concrete Pumps; Drills with Self Contained Power Units; Boring Machine; Post Hole Digger; Auger; Pounder; Well Digger; Milling Machine (over 24" Mandrell)	37.51	24.30 + a
--	-------	-----------

Group 5 continued: Side Boom; Combination Hoe and Loader; Directional Driller; Pile Testing Machine.	37.51	24.30 + a
--	-------	-----------

Group 6: Front End Loader (3 up to 7 cubic yards); Bulldozer (rough grade dozer).	37.20	24.30 + a
---	-------	-----------

Group 7: Asphalt roller, concrete saws and cutters (ride on types), vermeer concrete cutter, Stump Grinder; Scraper; Snooper; Skidder; Milling Machine (24" and under Mandrell).	36.86	24.30 + a
--	-------	-----------

Group 8: Mechanic, grease truck operator, hydroblaster; barrier mover; power stone spreader; welding; work boat under 26 ft.; transfer machine.	36.46	24.30 + a
---	-------	-----------

As of: Friday, May 03, 2019

Project: Flooring Installation At Duffy Elementary School

Group 9: Front end loader (under 3 cubic yards), skid steer loader regardless of attachments, (Bobcat or Similar): forklift, power chipper; landscape equipment (including Hydroseeder).	36.03	24.30 + a
--	-------	-----------

Group 10: Vibratory hammer; ice machine; diesel and air, hammer, etc.	33.99	24.30 + a
---	-------	-----------

Group 11: Conveyor, earth roller, power pavement breaker (whiphammer), robot demolition equipment.	33.99	24.30 + a
--	-------	-----------

Group 12: Wellpoint operator.	33.93	24.30 + a
-------------------------------	-------	-----------

Group 13: Compressor battery operator.	33.35	24.30 + a
--	-------	-----------

Group 14: Elevator operator; tow motor operator (solid tire no rough terrain).	32.21	24.30 + a
--	-------	-----------

As of: Friday, May 03, 2019

Project: Flooring Installation At Duffy Elementary School

Group 15: Generator Operator; Compressor Operator; Pump Operator; Welding Machine Operator; Heater Operator.	31.80	24.30 + a
---	-------	-----------

Group 16: Maintenance Engineer/Oiler.	31.15	24.30 + a
---------------------------------------	-------	-----------

Group 17: Portable asphalt plant operator; portable crusher plant operator; portable concrete plant operator.	35.46	24.30 + a
--	-------	-----------

Group 18: Power safety boat; vacuum truck; zim mixer; sweeper; (Minimum for any job requiring a CDL license).	33.04	24.30 + a
--	-------	-----------

-----PAINTERS (Including Drywall Finishing)-----

10a) Brush and Roller	33.62	21.05
-----------------------	-------	-------

As of: Friday, May 03, 2019

Project: Flooring Installation At Duffy Elementary School

10b) Taping Only/Drywall Finishing	34.37	21.05
------------------------------------	-------	-------

10c) Paperhanger and Red Label	34.12	21.05
--------------------------------	-------	-------

10e) Blast and Spray	36.62	21.05
----------------------	-------	-------

11) Plumber (excluding HVAC pipe installation) (Trade License required: P-1,2,6,7,8,9 J-1,2,3,4 SP-1,2)	42.62	31.21
--	-------	-------

12) Well Digger, Pile Testing Machine	37.26	24.05 + a
---------------------------------------	-------	-----------

13) Roofer (composition)	36.70	19.85
--------------------------	-------	-------

As of: **Friday, May 03, 2019**

Project: Flooring Installation At Duffy Elementary School

14) Roofer (slate & tile)	37.20	19.85
---------------------------	-------	-------

15) Sheetmetal Worker (Trade License required for HVAC and Ductwork: SM-1,SM-2,SM-3,SM-4,SM-5,SM-6)	37.50	36.79
--	-------	-------

16) Pipefitter (Including HVAC work) (Trade License required: S-1,2,3,4,5,6,7,8 B-1,2,3,4 D-1,2,3,4, G-1, G-2, G-8 & G-9)	42.62	31.21
---	-------	-------

-----TRUCK DRIVERS-----

17a) 2 Axle	29.13	23.33 + a
-------------	-------	-----------

17b) 3 Axle, 2 Axle Ready Mix	29.23	23.33 + a
-------------------------------	-------	-----------

As of: Friday, May 03, 2019

Project: Flooring Installation At Duffy Elementary School

17c) 3 Axle Ready Mix	29.28	23.33 + a
-----------------------	-------	-----------

17d) 4 Axle, Heavy Duty Trailer up to 40 tons	29.33	23.33 + a
---	-------	-----------

17e) 4 Axle Ready Mix	29.38	23.33 + a
-----------------------	-------	-----------

17f) Heavy Duty Trailer (40 Tons and Over)	29.58	23.33 + a
--	-------	-----------

17g) Specialized Earth Moving Equipment (Other Than Conventional Type on-the-Road Trucks and Semi-Trailers, Including Euclids)	29.38	23.33 + a
--	-------	-----------

18) Sprinkler Fitter (Trade License required: F-1,2,3,4)	43.92	15.84 + a
--	-------	-----------

As of: **Friday, May 03, 2019**

Project: Flooring Installation At Duffy Elementary School

19) Theatrical Stage Journeyman	25.76	7.34
---------------------------------	-------	------

As of: Friday, May 03, 2019

Project: Flooring Installation At Duffy Elementary School

Welders: Rate for craft to which welding is incidental.

**Note: Hazardous waste removal work receives additional \$1.25 per hour for truck drivers.*

***Note: Hazardous waste premium \$3.00 per hour over classified rate*

ALL Cranes: When crane operator is operating equipment that requires a fully licensed crane operator to operate he receives an extra \$4.00 premium in addition to the hourly wage rate and benefit contributions:

1) Crane handling or erecting structural steel or stone; hoisting engineer (2 drums or over)

2) Cranes (100 ton rated capacity and over) Bauer Drill/Caisson

3) Cranes (under 100 ton rated capacity)

Crane with 150 ft. boom (including jib) - \$1.50 extra

Crane with 200 ft. boom (including jib) - \$2.50 extra

Crane with 250 ft. boom (including jib) - \$5.00 extra

Crane with 300 ft. boom (including jib) - \$7.00 extra

Crane with 400 ft. boom (including jib) - \$10.00 extra

All classifications that indicate a percentage of the fringe benefits must be calculated at the percentage rate times the "base hourly rate".

Apprentices duly registered under the Commissioner of Labor's regulations on "Work Training Standards for Apprenticeship and Training Programs" Section 31-51-d-1 to 12, are allowed to be paid the appropriate percentage of the prevailing journeymen hourly base and the full fringe benefit rate, providing the work site ratio shall not be less than one full-time journeyman instructing and supervising the work of each apprentice in a specific trade.

The Prevailing wage rates applicable to this project are subject to annual adjustments each July 1st for the duration of the project.

Each contractor shall pay the annual adjusted prevailing wage rate that is in effect each July 1st, as posted by the Department of Labor.

It is the contractor's responsibility to obtain the annual adjusted prevailing wage rate increases directly from the Department of Labor's website.

The annual adjustments will be posted on the Department of Labor's Web page: www.ct.gov/dol. For those without internet access, please contact the division listed below.

The Department of Labor will continue to issue the initial prevailing wage rate schedule to the Contracting Agency for the project.

All subsequent annual adjustments will be posted on our Web Site for contractor access.

Contracting Agencies are under no obligation pursuant to State labor law to pay any increase due to the annual adjustment provision.

As of: Friday, May 03, 2019

Project: Flooring Installation At Duffy Elementary School

Effective October 1, 2005 - Public Act 05-50: any person performing the work of any mechanic, laborer, or worker shall be paid prevailing wage

All Person who perform work ON SITE must be paid prevailing wage for the appropriate mechanic, laborer, or worker classification.

All certified payrolls must list the hours worked and wages paid to All Persons who perform work ON SITE regardless of their ownership i.e.: (Owners, Corporate Officers, LLC Members, Independent Contractors, et. al)

Reporting and payment of wages is required regardless of any contractual relationship alleged to exist between the contractor and such person.

~~Unlisted classifications needed for work not included within the scope of the classifications listed may be added after award only as provided in the labor standards contract clause (29 CFR 5.5 (a) (1) (ii)).

Please direct any questions which you may have pertaining to classification of work and payment of prevailing wages to the Wage and Workplace Standards Division, telephone (860)263-6790.

As of: Friday, May 03, 2019

**Indemnification and Insurance Exhibit
Asbestos Abatement
Duffy Elementary School
Bid #:6707F**

For purpose of this Exhibit, the term "Contractor" shall also include their respective officers, agents, representatives, employees, and contractors of any tier; and the term "Town of West Hartford and West Hartford Board of Education" (hereinafter called the "Town") shall include their respective boards, commissions, officers, officials, employees, agents, representatives, and volunteers.

I. INDEMNIFICATION

- A. To the fullest extent permitted by law, the Contractor shall release, defend, indemnify, and hold harmless the Town of West Hartford, West Hartford Board of Education, and their respective boards, commissions, officers, officials, employees, agents, representatives and volunteers from any and all suits, claims, losses, damages, costs (including without limitation reasonable attorneys' fees), compensation, penalties, fines, liabilities or judgments of any name or nature for bodily injury, sickness, disease, or death; and/or damage to or destruction of real and/or personal property; and/or financial losses (including, without limitation, those caused by loss of use) sustained by any person or concern, including officers, employees, agents, contractors of any tier, or volunteers of the Town of West Hartford and West Hartford Board of Education, or the Contractor, or by the public, even if caused by the negligence of the Town, so long as the injury to person, property or financial losses is caused or alleged to have been caused in whole or in part by any and all negligent or intentional acts, errors or omissions of the Contractor, its officers, agents, contractors of any tier, or anyone directly or indirectly employed by them arising from or related to the performance of this Contract.
- B. To the fullest extent permitted by law, the Contractor shall release, defend, indemnify, and hold harmless the Town of West Hartford, West Hartford Board of Education, and their respective boards, commissions, officers, officials, employees, agents, representatives and volunteers from any and all suits, claims, damages, costs, (including without limitation reasonable attorneys' fees), compensation, penalties, fines, liabilities or judgments that may arise out of the failure of the Contractor, its officers, agents, contractors of any tier, or anyone directly or indirectly employed by them to comply with any laws, statutes, ordinances, building codes, and rules and regulations of the United States of America, the State of Connecticut, the Town of West Hartford, or their respective agencies.
- C. To the fullest extent permitted by law, the Contractor agrees to defend, indemnify and hold harmless Town of West Hartford, West Hartford Board of Education, and their respective boards, commissions, officers, officials, employees, agents, representatives and volunteers from any and all suits, claims, losses, damages, costs (including, without limitation, reasonable attorney's fees), compensations, penalties, fines, liabilities or judgments, on account of or in connection with any death of person or injury, loss or damage to any person, property, or to the environment, arising out of the activity of the type contemplated by this Contract, whether or not said activity complies strictly with the requirements of this Contract and, arises out of or in connection with;
 - a. the violation or breach, by any employee or person acting on behalf of the Contractor of any federal, state, or local environmental statute, rule, regulation, ordinance, or other law or any provision or requirement of the Contract dealing with hazardous substances or protection of the environment; or
 - b. the release or discharge, onto any public or private property, of any hazardous substances, regardless of the source of such hazardous substances, by any employee or person acting on behalf of the Contractor while present on, within, or in the vicinity of Town owned property; or
 - c. the subsequent storage, processing or other handling of such hazardous substances by any person or entity after they have been removed by the Contractor or persons acting on the Contractor's behalf from Town owned property.

- D. This duty to indemnify shall not be constrained or affected by the Contractor's insurance coverage or limits, or any other portion of the Contract relating to insurance requirements. It's agreed that the Contractor's responsibilities and obligations to indemnify shall survive the completion, expiration, suspension or termination of the Contract.

II. INSURANCE

A. Insurance Requirements

1. The Contractor shall obtain and maintain at its own cost and expense all the insurance described below continuously for the duration of the Contract, including any and all extensions, except as defined otherwise in this Exhibit.
2. Contractor's policies shall be written by insurance companies authorized to do business in the State of Connecticut, with a Best's rating of no less than A:VII, or otherwise approved by the Town.
3. All policies (with the exception of Worker's Compensation) shall be endorsed to include the Town of West Hartford, West Hartford Board of Education, and their respective boards, commissions, officers, officials, employees, agents, representatives, and volunteers as an Additional Insured. The coverage shall include, but not be limited to, investigation, defense, settlement, judgment or payment of any legal liability. Blanket Additional Insured Endorsements are deemed acceptable. Any Insured vs. Insured language shall be amended to eliminate any conflicts or coverage restrictions between the respective Insureds.
4. When the Town or the Contractor is damaged by failure of the Contractor to purchase or maintain insurance required under this Exhibit, the Contractor shall bear all reasonable costs including, but not limited to, attorney's fees and costs of litigation properly attributable thereto.

B. Required Insurance Coverages:

1. **Commercial General Liability:** \$1,000,000 each occurrence / \$2,000,000 aggregate for premises/operations, products/ completed operations, contractual liability, personal injury and broad form property damage. Contractor shall continue to provide products/ completed operations coverage for two (2) years after final completion of the work.
2. **Automobile Liability and Physical Damage Coverage:** \$1,000,000 each accident for any auto, including uninsured/underinsured motorist coverage and medical payments. Policy shall include collision and comprehensive physical damage coverage.
3. **Umbrella Liability:** \$2,000,000 each occurrence / \$4,000,000 aggregate, following form.
4. **Workers' Compensation and Employer's Liability:** Statutory coverage in compliance with the Workers' Compensation laws of the State of Connecticut or applicable to the work to be performed. Policy shall include Employer's Liability with minimum limits of \$1,000,000 each accident, \$1,000,000 disease/policy limit, \$1,000,000 disease/each employee.

The Contractor represents that they are currently in compliance with all requirements of the State of Connecticut Workers' Compensation Act and that it shall remain in compliance for the duration of the Contract. The Contractor agrees that Workers' Compensation is their sole remedy and shall indemnify and hold harmless the Town from all suits, claims, and actions arising from personal injuries to the Contractor, however caused. This indemnity shall not be affected by a lapse of Workers' Compensation coverage and/or if the Contractor failed, neglected, refused or is unable to obtain Workers' Compensation insurance.

5. **Personal Property:** All personal property of the Contractor are the sole risk of the Contractor. The Contractor agrees to indemnify, defend and hold harmless the Town from any and all losses or damages, however caused, to any and all personal property belonging to the Contractor.

6. **Contractor's Pollution Coverage:** \$3,000,000 each occurrence **project specific limit** / \$6,000,000 aggregate dedicated to work performed under this Contract only, unless otherwise approved by the Town's Risk Manager. Policy must specifically include pollution coverage for bodily injury, property damage, cleanup costs, defense costs, contractual liability and completed operations for all work performed by or on behalf of the Contractor under the Contract. Exclusions or limitations affecting work performed must be deleted. Policy form must be "pay on behalf of rather than "indemnity" and insurance company must have the "right and duty" to defend. The policy shall not contain any provision or definition that would serve to eliminate third party action over claims for employees of the Contractor. Policy shall state that insolvency or bankruptcy of the insured or the insured's estate will not relieve the insurance company of its obligations. The Contractor shall maintain completed operations coverage for two (2) years following the termination or expiration of the Contract, including any extensions.
7. **Hazardous Waste Transporter Coverage:** The Contractor shall have automobile liability coverage written for not less than \$1,000,000 each accident or as specified in the Motor Carrier Act of 1980, whichever coverage is greater. The policy shall include an Amended Pollution Exclusion to cover loading, unloading and transportation activities including hauling of waste to the final disposal location and a Non-Owned Disposal Site Endorsement (claims-made) with the scheduled landfill, or provide evidence of insurance from disposal site operator. **Policy shall be endorsed to include the MCS-90 endorsement and the reimbursement provision of the MCS-90 endorsement will be borne by the Contractor.** The Contractor must submit to the Town a list of transfer and disposal sites to be used, along with the waste manifest provided by the disposal facility identifying ability to accept the type of waste being delivered and limits of financial responsibility, including closure/post closure bonds. Contractor must comply with all applicable D.O.T. and E.P.A. requirements.
8. **Pollution Legal Liability (claims-made):** \$3,000,000 each loss / \$3,000,000 aggregate. Policy shall provide pollution coverage for sudden and non-sudden occurrences resulting in on-site and off-site bodily injury, property damage, cleanup costs and defense costs arising out of the consolidation, transfer, storage or disposal of waste by the Contractor or others contemplated by this Contract.

C. Additional Terms

1. Minimum Scope and Limits: The required insurance shall meet the minimum scope and limits of insurance specified in this Exhibit, or required by applicable federal, state and/or municipal law, regulation or requirement, whichever coverage is greater. Providing proof of compliance with the insurance requirements described in this Exhibit is not intended, and shall not be construed to exclude the Town from additional limits and coverage available to the Contractor.

Acceptance by the Town of insurance submitted by the Contractor does not relieve or decrease in any manner the liability of the Contractor arising out of or in connection with this Contract. The Contractor is responsible for any losses, claims and costs of any kind which exceed the Contractor's limits of liability, or which may be outside the coverage scope of the policies, or a result of non-compliance with any laws including, but not limited to, environmental laws. The requirements herein are not intended, and shall not be construed to limit or eliminate the liability of the Contractor that arises from the Contract.

2. Certificates of Insurance: The Contractor shall provide certificates of insurance, policy endorsements, declaration page(s) or provisions acceptable to the Town confirming compliance with this Exhibit and thereafter upon renewal or replacement of each required policy of insurance. Upon request, the Contractor agrees to furnish complete copies of the required policies.
3. Subcontractors: Contractor shall cause all contractors of any tier, acting on its behalf, to comply with this Exhibit. The Contractor shall either include its contractors as an Insured under its insurance policies or furnish separate certificates of insurance and endorsements for each subcontractor.
4. Premiums, Deductibles and Other Liabilities: Any and all related costs, including but not limited to, deductibles, retentions, losses, claim expenses, premiums, taxes, and audit charges earned are the sole responsibility of the Contractor.
5. Occurrence Form, Primary and Non-Contributory: All required insurance coverage shall be written on an occurrence basis, except as defined otherwise in this Exhibit. Each required policy of insurance shall be primary and non-contributory with respect to any insurance or self-insurance maintained by the Town.

6. Claims-made Form: Insurance coverage written on a claims-made basis shall have a retroactive date that precedes the effective date of this Contract. The Contractor shall maintain continuous coverage or obtain an extended reporting period in which to report claims following end of the Contract, for a minimum of two (2) years, except as defined otherwise in this Exhibit.
7. Waiver of Rights of Recovery: Both the Contractor and Contractor's insurers shall waive their rights of recovery or subrogation against the Town.
8. Claim Reporting: Any failure of the Contractor to comply with the claim reporting provisions of the required insurance policies shall not relieve the Contractor of any liability or indemnification in favor of the Town for losses which otherwise would have been covered by said policies.
9. Cancellation Notice: Each required insurance policy shall not be suspended, voided, cancelled or reduced except after thirty (30) days prior written notice has been given to the Town, ten (10) days for non-payment of premium.
10. Compliance: Failure to comply with any of the indemnification or insurance requirements may be held a willful violation and basis for immediate termination of the Contract

SIDE-C

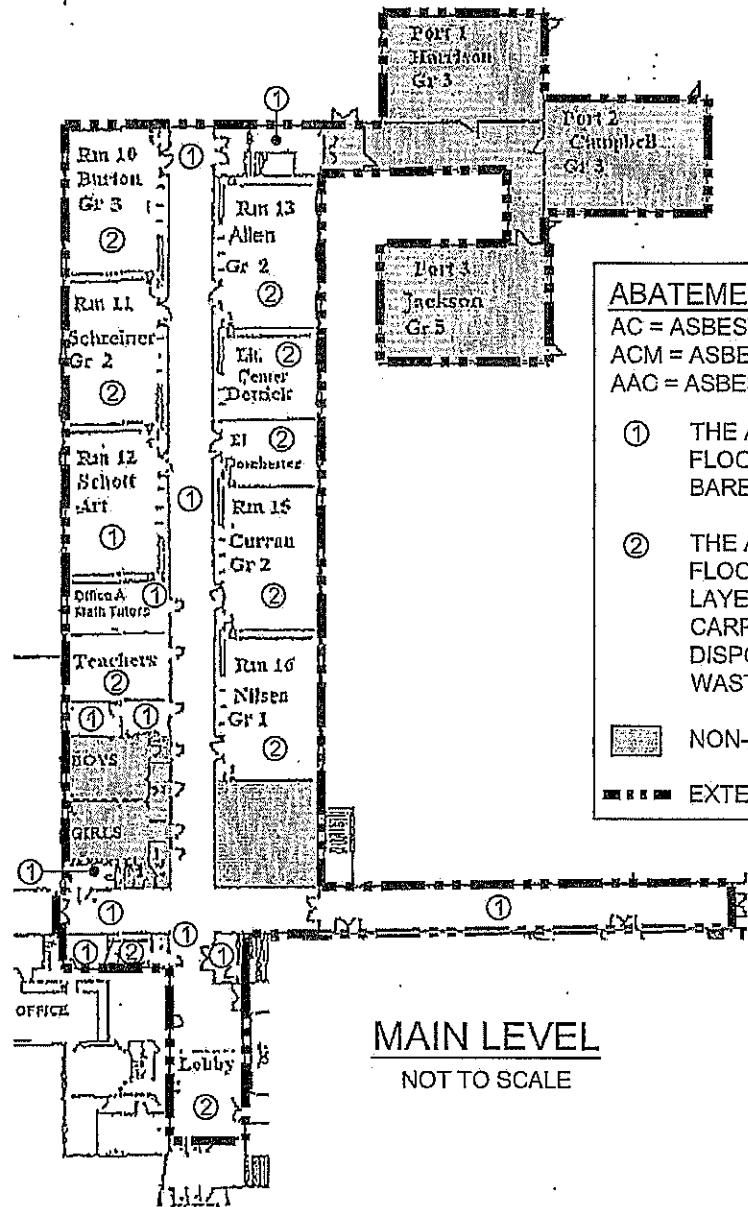
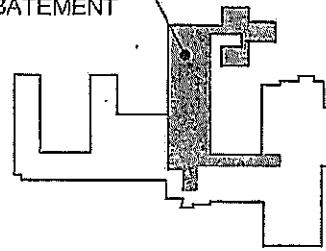

KEY PLAN

AREA OF
ABATEMENT

ABATEMENT KEY:

AC = ASBESTOS CONTAINING

ACM = ASBESTOS CONTAINING MATERIALS

AAC = ASBESTOS ABATEMENT CONTRACTOR

- ① THE AAC SHALL REMOVE AND DISPOSE OF AC FLOOR TILES AND MASTIC (ALL LAYERS TO BARE CONCRETE) AS ACM.
- ② THE AAC SHALL REMOVE AND DISPOSE OF AC FLOOR TILE AND MASTIC UNDER CARPET (ALL LAYERS TO BARE CONCRETE) AS ACM. CARPET COVERING THE FLOOR TILE SHALL BE DISPOSED OF AS ASBESTOS-CONTAMINATED WASTE.



NON-ACM FLOORING / NOT IN SCOPE (N.I.S.)



EXTENTS OF ABATEMENT

MAIN LEVEL

NOT TO SCALE

SIDE-A (STREET SIDE)

EAGLE
Environmental, Inc.8 SOUTH MAIN STREET, SUITE 3
TERRYVILLE, CONNECTICUT 06786
860-589-8257

SHEET NO.

ASB-1

SHEET 1 OF 1

DATE: 04/01/2019

PROJECT NO.: 19-041.11T2

DRAWN BY: BB

REVIEWED BY: AR

ASBESTOS CONTAINING MATERIALS ABATEMENT
TOWN OF WEST HARTFORD
LOUISE DUFFY ELEMENTARY SCHOOL
95 WESTMINSTER DRIVE
WEST HARTFORD, CONNECTICUT

INSTRUCTIONS TO BIDDERS

ANTI DISCRIMINATION

The Contractor agrees and warrants that in the performance of this Contract it will not discriminate or permit discrimination against any person or group of persons on the grounds of sex, race, color, religion, age, marital status, ancestry, national origin, past history of mental disorder, mental retardation or physical disability or other basis in any manner prohibited by the laws of the United States, the State of Connecticut, or the Town of West Hartford.

APPLICABLE LAW

The Contract pursuant to this solicitation shall be governed by, and the Town and Contractor shall have all remedies afforded each by the Uniform Commercial Code, as adopted in the State of Connecticut, except as otherwise provided in such Contract or in laws pertaining specifically to the Town. This Contract shall be governed by the laws of the State of Connecticut, and suits pertaining to this contract shall be brought only in federal or state courts in the state of Connecticut.

ASSIGNMENT - DELEGATION

No right or interest in the contract shall be assigned by the Contractor without prior written permission of the Town, and no delegation of any duty of Contractor shall be made without prior written permission of the Town's Purchasing Agent. The Town shall not unreasonably withhold approval and shall notify the Contractor of the Town's position within a reasonable period of time.

AWARD OF CONTRACT

Award will be made to the lowest responsible qualified bidder.

A Bidder, if requested, must be prepared to present evidence of experience, ability, service facilities and financial standing necessary to meet satisfactorily the requirements set forth or implied in the bid.

The Purchasing Agent reserves the right to reject the bid of any bidder in default of any prior contract or guilty of misrepresentation, or of any company having as its sales agent or representative, or member of the firm, any individual in default or guilty of misrepresentation.

Each bid will be received, with the understanding that the acceptance in writing by the Purchasing Agent of the offer to furnish any or all of the commodities described therein, shall constitute a contract between the Bidder and the Town, which shall bind the Bidder on his part to furnish and deliver the commodities at the prices given and in accordance with conditions of said accepted bid and specifications.

No alterations or variations of the terms of the contract shall be valid or binding upon the Town unless made in writing and signed by the Purchasing Agent. The placing, in the mail to the address given in the bid or delivery of a notice of award to a bidder will constitute notice of acceptance of an offer.

When so requested by the Purchasing Agent, the Contractor shall execute a formal contract with the Town for the complete performance specified therein. The contract may be terminated or annulled by the Purchasing Agent upon nonperformance of contract terms or failure of the Contractor to furnish performance surety and/or insurance certificates within ten (10) days from date of request. Any unfulfilled deliveries against such contract may be purchased from other sources at the Contractor's expense.

Failure of a Contractor to deliver within the time specified or within reasonable time as interpreted by the Purchasing Agent or failure to make replacements of rejected commodities when so requested, immediately or as directed by the Purchasing Agent, will constitute authority for the Purchasing Agent to purchase in the open market, the commodities to replace the commodities rejected or not delivered. The Purchasing Agent reserves the right to authorize immediate purchase in the open market against rejections on any contract when necessary. On all such purchases, the Contractor agrees promptly to reimburse the Town for excess costs occasioned by such purchases. Such purchases will be deducted from the contract quantities. However, should public necessity demand it, the Town reserves the right to use or consume commodities delivered which are substandard in quality, subject to an adjustment in price to be determined by the Purchasing Agent.

BEST CUSTOMER PREFERENTIAL PRICING

The contractor shall reduce the contract price of any good or service for which a contract award is executed to an amount equal to or lower than any pricing offered to any other commercial customer or the general public. This reduction in price shall be applied when the goods or services are identical to those contracted for and quantities requested meet any minimum quantity requirements for such pricing.

CERTIFICATION

By signature of the offeror, the offeror certifies:

The submission of the offer did not involve collusion or other anti-competitive practices.

The offeror had not given, offered to give, not intends to give at any time hereafter, any economic opportunity, future employment, gift, loan, gratuity, special discount, trip, favor, or service to a public servant in connection with the submitted offer. Failure to provide a valid signature affirming the stipulations required by this clause shall result in the rejection of the offer. Signing the offer with a false statement shall void the offer, any resulting Contract and may be subjected to legal remedies by law.

The offeror submitting the offer hereby certifies that the individual signing the offer and/or Contract is an authorized agent for the offeror and has the authority to bind the offeror to the contract.

CLAYTON ACT ASSIGNMENT OF RIGHTS

The Contractor and/or Subcontractor offers and agrees to assign to the Town of West Hartford and/or the West Hartford Board of Education all rights, titles and interest in all causes of action it may have under Section 4 of the Clayton Act., 15 U.S.C. Section 15, or under Connecticut General Statutes 35-24 et. seq., as amended, arising out of the purchase of services, property, or intangibles of any kind pursuant to the Agreement, or Subcontracts thereunder. This assignment shall be made and become effective at the time the Town/Board awards or accepts such Agreement, without further acknowledgment by the parties. In the alternative, at the option of the Town, the Contractor and/or Subcontractor agrees to pay to the Town its proportionate share of recoveries for anti-trust violations which relate to purchases pursuant to this Contract, or Subcontracts hereunder. The Contractor and/or Subcontractor agrees promptly to notify the Purchasing Agent of the Town of West Hartford of suspected anti-trust violations and claims.

CONTRACT

The contract pursuant to this solicitation shall be based upon the request for bid issued by the Town and the offer submitted by the Contractor in response to the request for bid. The offer shall substantially conform to the terms, conditions, specifications and other requirements set forth within the text of the request for bid. The Town reserves the right to clarify any contractual terms with the concurrence of the Contractor. However, any substantial non-conformity in the offer, as determined by the Town Purchasing Agent, shall be deemed nonresponsive and the offer rejected. Such contract shall contain the entire agreement between the Town and the Contractor relating to this requirement and shall prevail over any and all previous Agreements, contract, proposals, negotiations, purchase orders or master Agreements in any form.

CONTRACT AMENDMENTS

The contract pursuant to this solicitation shall be modified only by a written contract amendment signed by the Town Purchasing Agent and persons duly authorized to enter into contracts on behalf of the Contractor.

COST OF BID PREPARATION

The Town shall not reimburse the bidder for the cost of developing, presenting or providing any response to this solicitation. Offers submitted for consideration should be prepared simply and economically, providing adequate information in a straightforward and concise manner.

DELIVERY

All prices bid must be on the basis of F.O.B. destination, inside delivery, unloaded and assembled unless otherwise indicated in the bidding documents. The contractor shall be responsible for all freight cost.

It shall be understood and agreed that any and all commodities furnished shall comply fully with all applicable O.S.H.A., Federal and State laws and regulations.

Any equipment delivered must be standard new equipment, latest model, except as otherwise specifically stated in bidding documents. Where any part or nominal appurtenances of equipment are not described, it shall be understood that all the equipment and appurtenances which are usually provided in the manufacturer's stock model shall be furnished.

Delivery must be made as ordered and in accordance with the bidding documents. The decision of the Purchasing Agent as to reasonable compliance with delivery terms shall be final. Burden of proof of delay in receipt of order shall rest with the Contractor.

Commodities shall be securely and properly packed for shipment according to accepted standard commercial practice, without extra charge for packing cases, bailing or sacks, the containers to remain the property of the Town unless otherwise stated in the bidding documents.

GRATUITIES

The Town may, by written notice to the Contractor, cancel the contract if it is found that gratuities, in the form of entertainment, gifts or otherwise, were offered or given by the Contractor or any agent or representative of the Contractor, to any officer or employee of the Town amending, or the making of any determinations with respect to the performing of such contract. In the event this contract is canceled by the Town pursuant to this provision, the Town shall be entitled, in addition to any other rights and remedies, to recover or withhold from the Contractor the amount of the gratuity.

INDEMNIFICATION

The Bidder is aware of and agrees that, if awarded an Agreement, he is bound by the following indemnification language:

To the fullest extent permitted by law, the Contractor shall release, defend, indemnify, and hold harmless the Town of West Hartford and the West Hartford Board of Education, their respective boards, commissions, officers, officials, employees, agents, representatives, and servants from any and all suits, claims, losses, damages, costs (including without limitation reasonable attorneys' fees), compensation, penalties, fines, liabilities or judgments or any name or nature for:

Bodily injury, sickness, disease, or death; and/or

Damage to or destruction of property, real or personal; and/or

Financial losses (including, without limitation, those caused by loss of use)

sustained by any person or concern, including officers, employees, agents, Subcontractors or servants of the Town, the Board of Education, or the Contractor, or by the public, which is cause or alleged to have been caused in whole or in part by the negligent act(s) or omission(s) of the Contractor, its officers, employees, agents, or Subcontractors, in the performance of this Agreement or from the inaccuracy of any representation or warranty of the Contractor contained in the Contract Documents. This indemnity shall not be affected by other portions of the Agreement relating to insurance requirements.

- To the fullest extent permitted by law, the Contractor agrees to release, defend, indemnify, and hold harmless the West Hartford Board of Education and the Town of West Hartford, their respective boards and commissions, officials, officers, employees, agents, representatives, and servants from any loss, claim, cost penalty, fine or damage that may arise out of the failure of the Contractor, its officers, agents, employees or Subcontractors to comply with any laws or regulations of the United States of America, the State of Connecticut, the Town of West Hartford, or their respective agencies. This undertaking shall not be affected by other portions of the Agreement relating to insurance requirements.

INTERPRETATION OF BIDS

Qualified bids are subject to rejection in whole or in part. A qualified bid is defined as one limiting or modifying any of the terms and conditions and/or specifications of the invitation to bid.

Bidders are cautioned to initial erasures, alterations or corrections. Failure to do so may result in rejection of bids.

Unless limited by the term "no substitute", the use of the name of a manufacturer or of any particular make, model, or brand in describing an item, does not restrict bidders to that manufacturer or specific article, this means being used simply to indicate the character or quality of the article so described; but the article offered must be of such character and quality that it will serve the purpose for which it is to be used, equally as well as that specified, and shall be deemed by the Town to be so warranted by the bidder. Bids on comparable items must clearly state the exact article being offered, and bidder shall furnish such other information concerning the article being offered as necessary to evaluate its acceptability for the purpose intended. If the bidder does not indicate that the article he offers is other than as specified, it will be understood that the bidder is offering the article exactly as specified.

The Purchasing Agent reserves the right to reject any or all bids, or the bid for any one or more commodities or contracted services included in any or all bids, to waive any informality in bids and unless otherwise specified, to buy any part or the whole from one or more bidders when it is to the Town's best interest to do so.

INTERPRETATION - PAROL EVIDENCE

The contract pursuant to this solicitation is intended by the parties as a final expression of their agreement and is intended also as a complete and exclusive statement of the terms of such Contract. No course of prior dealings between the parties and no usage of the trade shall be relevant to supplement or explain any term used in the contract. Acceptance or acquiescence in a course of performance rendered under the contract shall not be relevant to determine the meaning of the contract even though the accepting or acquiescing party had knowledge of the nature of this performance and opportunity to object.

LAW OF WAIVER

Any breach of contract which the Town does not object to shall not operate as a waiver of the Town to seek remedies available to it for any subsequent breach.

LICENSES

Contractor shall maintain in current status all federal, state and local licenses and permits required for the operation of the business conducted by the Contractor as applicable to this contract.

PUBLIC RECORD

All proposals submitted in response to this request shall become the property of the Town and shall become a matter of public record available for review subsequent to the award notification.

PROPERTY TAX ASSESSMENT

All owners of real estate, or of tangible personal property located in any town for three months or more during the assessment year immediately preceding any assessment day, who are nonresidents of such town, shall file lists of such real estate and personal property with the assessors of the town in which the same is located on such assessment day, if located in such town for three months or more in such year, otherwise, in the town in which such property is located for the three months or more in such year nearest to such assessment day, under the same provisions as apply to residents, and such personal property shall not be liable to taxation in any other town in this state. The list of each nonresident taxpayer shall contain his post-office and street address. The assessors shall mail to each nonresident, or to his attorney or agent having custody of his taxable property, at least fifteen days before the expiration of the time for filing lists, blank forms for filing lists of such property. The lists of taxable property of nonresidents shall be arranged in alphabetical order and separate from the lists of residents, provided no such separation shall be necessary in any town the board of assessors of which, upon the request of its property tax collector, has made rules and regulations approved by the secretary of the office of policy and management settling up an alternative method of arrangement.

PROVISIONS REQUIRED BY LAW

Each and every provision of law and any clause required by law to be in the contract shall be read and enforced as though it were included herein, and if through mistake or otherwise any such provision is not inserted, or is not correctly inserted, then upon the application of either party the contract shall forthwith be physically amended to make such insertion or correction.

RELATIONSHIP OF PARTIES

It is clearly understood that each party shall act in its own individual capacity and not as an agent, employee, partner, joint venturer, or associate of the other. An employee or agent of one party shall not be deemed or construed to be the employee or agent of the other party for any purpose whatsoever. The Contractor is advised that taxes or social security payments shall not be withheld from a Town payment issued hereunder and that Contractor should make arrangements to directly pay such expenses, if any. The Contractor understands that it is not entitled to compensation in the form of salaries, or to paid vacation or sick days by the Town. The Contractor further understands that the Town shall not provide any insurance coverage to the Contractor, including workmen's compensation coverage.

RIGHTS AND REMEDIES

No provision in these solicitation documents or in the offeror's bid shall be construed, expressly or by implication as a waiver by either party of any existing or future right and/or remedy available by law in the event of any claim of default or breach of contract. The failure of either party to insist upon the strict performance of any term or condition of the contract or to exercise or delay the exercise of any right or remedy provided in the contract, or by law, or the acceptance of materials or services, obligations imposed by this contract or by law, and shall not be deemed a waiver of any right of either party to insist upon the strict performance of the contract.

SEVERABILITY

The provisions of this contract are severable to the extent that any provision or application held to be invalid shall not affect any other provision or application of the contract which may remain in effect without the invalid provision or application.

SUBCONTRACTS

No subcontract shall be entered into by the Contractor with any other party to furnish any of the material/service specified herein without the advance written approval of the Town's Purchasing Agent. All subcontracts shall comply with federal and state laws and regulations which are applicable to the services covered by the subcontract and shall include all the terms and conditions set forth herein which shall apply with equal force to the subcontract, as if the subcontractor were the Contractor referred to herein. The Contractor is responsible for contract performance whether or not subcontractors are used. The Town shall not unreasonably withhold approval and shall notify the Contractor of the Town's position within a reasonable period of time.

SUBMISSION OF BIDS

Signed bid offers, on this form, must be returned in sealed envelopes addressed to Department of Finance, Division of Purchasing Services, Town Hall, 50 South Main St., West Hartford, CT 06107 and the envelope must bear the notation that it is a sealed bid, the Bid Number and the vendor's name and address.

Bidders are cautioned to examine the specifications, drawings, samples, etc. pertaining to the bid.

Failure on the part of the bidder to examine all pertinent documents samples, or job areas shall not entitle him to any relief from the conditions imposed in the proposal, the specifications and the contract. Unsigned bids or bids without an original signature will not be accepted.

When a bidder desires an interpretation or clarification of any ambiguity in the bidding documents, he must contact the Purchasing Agent prior to bid opening. The Purchasing Agent's interpretation shall be final and will be made known to all bidders concerned. The bidder shall insert the price per stated unit and the extensions against each item which he proposed to provide. In the event of a discrepancy between the unit price and the extension, the unit price will govern. (If discounts are shown and there is an error in the extension of the total, the discount offered will govern.) If the price bid per unit is based on any unit other than that stated, the bidder shall state the unit on which the unit price is based.

A bid will not be accepted if it, or the Bid Surety if required, is received at the Purchasing Division Office after the stated time of opening as shown on the bid form. This applies to bids sent by mail as well as those hand delivered. Unsigned bids shall be rejected.

Contractors must furnish Bid Surety, Labor & Materials and Performance Bonds when required. Certificates of Insurance may be required and must be furnished by the Contractor prior to any work being performed.

Purchases made by the Town are exempt from Fair Trade Laws as well as the payment of any sales, excise or Federal transportation taxes. Such taxes must not be included in bid prices. Tax exemption certificates, for merchandise accepted by the Town, will be completed at the request of the Contractor furnishing the goods or services.

When samples are requested they shall be delivered by the bidder properly identified at the time of the bid opening unless the bidding documents indicate a different time. Samples shall be submitted free of charge. Samples will be removed by the bidder at his expense. The Town will not be responsible for any samples which are destroyed or mutilated in examination. If samples are not removed within thirty (30) days after written notice to the Vendor, they shall be considered as abandoned and the Town shall have the right to dispose of them as its own property. The Purchasing Agent may, at his discretion, hold the sample or samples of the successful bidder or bidders, for comparison with articles delivered on the Purchase Order, or orders issued subsequent to the award.

SUBMISSION OF INVOICES

The following provisions regarding submission of invoices are an integral part of these bidding documents, and as such, will create a contractual obligation on the part of the awarded vendor. Failure to comply with these contractual requirements may result in a breach of contract:

All invoices submitted to the Town of West Hartford for goods or services shall contain the following minimum information:

- Town Order Number
- Complete description of goods or services rendered.
- Agency and name of individual requesting goods or rendering of services.
- Date of delivery of goods or rendering of services.
- Complete price information including gross amount, discount if applicable, net amount and itemization of labor charges if applicable.
- Additional information as may be required by contract.

All invoices must be forwarded to the Town department to whom goods or services were rendered.

TOXIC SUBSTANCES

In accordance with section 31-40 of the General statutes of Connecticut any person who supplies any toxic substance as defined in 31-40 shall provide the following information:

- 1) The generic or basic chemical name of the toxic substance;
- 2) the level at which exposure to the substance is determined to be hazardous. If known;
- 3) the acute and chronic effects of exposure of hazardous levels;
- 4) the symptoms of such effects;
- 5) appropriate emergency treatment;
- 6) proper conditions for safe use and exposure to such toxic substance;
- 7) procedures for cleanup of leaks and spills of such toxic substance; and
- 8) a label on each container of any such substance which states, in a clearly legible and conspicuous form, that a toxic substance is contained therein.

This information shall be disclosed at the time of the bid opening and chemical data sheets will also be required if the products meet the toxic substance criteria.

VENDOR WARRANTY

Vendor hereby agrees to:

- a. Perform contract in accordance with the specifications and bid under which the contract was awarded.
- b. Warranty the products or services against defective material or workmanship and to repair or replace any damage or marring of products occasioned in transit.
- c. Furnish adequate protection from damage for all work and to repair damages of any kind, for which he or his workmen are responsible, to the premises or equipment, to his own work or to the work of other contractors.
- d. Indemnify and hold harmless the Town, its agencies, agents, offices, servants or employees from any action, law suit or judgment arising out of defects in its products, materials or workmanship, negligence in its activities or breach of its agreement with the Town, including the cost of defense and counsel fees.

Articles which in any respect fail to conform with the specifications upon which the award is made will be rejected and held subject to the Bidder's disposition and expense.

WEST HARTFORD TOWN HALL DIRECTIONS
Purchasing, 2nd FL
Room 223

FROM THE WATERBURY AREA

1. Exit 43 (Park Road)
2. Take a left on to Park Road
3. Take a right at the traffic light (Raymond Road)
4. Go straight through traffic light (Boulevard)

The Town Hall parking lot is on your left

FROM THE BOSTON AREA

1. Exit 43 (Park Road)
5. Take a left on to Park Road
6. Take a right at the traffic light (Raymond Road)
7. Go straight through traffic light (Boulevard)

The Town Hall parking lot is on your left