

**Addendum No. 7  
January 14, 2019**

**Anna Rockwell Elementary School  
Renovations & Additions  
400 Whittlesey Drive  
Bethel, CT 06801  
State Project No. 009-0058 RNV  
Phase 1 of 2**

**This addendum shall modify/change and/or clarify the original bidding document for the above project. Acknowledgement of receipt of this document is provided on the Bid Form. Failure to acknowledge receipt of this addendum, previous and/or future addenda on the Bid Form may result in disqualification of the bidder.**

**The modifications, changes and/or clarifications are as follows:**

**GENERAL INFORMATION:**

**The date for receipt of bids for the following is: January 23, 2019 at 1:00pm.  
All bids should be delivered on or before the bid date and closing time to:**

**The Town of Bethel, Purchasing Department  
Clifford J. Hurgin Municipal Center  
1 School Street  
Bethel, CT 06801**

**Bids will be opened and read following the closing time in Meeting Room “A”.**

- 1. Bid Package #6 General Trades to include the following allowances for the following scope of work as added or revised:
  - a. Dumpsters-General Construction Debris: \$50,000.00
  - b. Snow/Ice Removal within Building Structure: \$7,500.00
  - c. Porta-Johns: \$10,000.00
  - d. Drinking Water: delete not required
  - e. Clean-Up Labor: \$90,000.00
  - f. Temporary Covered Walk-Fencing. \$75,000.00
  - g. Temporary Protection Building: \$75,000.00
  - h. Shift Premiums: \$50,000.00
  - i. Epoxy Terrazzo: \$30,000.00**

**ATTACHMENTS:**

**Perkins Eastman Addendum #7, January 10, 2019  
68961\_BETHEL-R\_SKA-009 Rockwell.**

**End of Addendum No. 7**

**ADDENDUM #7**

JANUARY 10, 2019

---

**ANNA H. ROCKWELL ELEMENTARY SCHOOL**

**State Project # 009-0058-RNV**

400 Whittlesey Drive  
Bethel, CT 06801

**Bethel Public Schools**

1 School Road  
Bethel, CT 06801

---

To All Potential Bidders:

The items and attachments set forth herein shall act to qualify, clarify, or otherwise modify the Contract Documents previously issued regarding the above referenced project. These items, whether of omission, addition, substitution, or clarification, shall be incorporated into the proposals submitted by all bidders, and receipt of this document and its attachments must be acknowledged, either in the space provided on the Bid Form or on the Contractor's Form of Proposal. Failure to do so may subject the Bidder to disqualification.

**The items and references:**

**SPECIFICATIONS**

**1. 09 66 23 – EPOXY TERRAZZO**

Description:

ADD Line 9. To Article 2.02 A. to read as follows: "Terroxy Resin Systems"

**DRAWINGS**

**1. LS-101 – Life Safety Plan Level 1 + 2**

ADD note: "*ALL STRUCTURAL STEEL MEMBERS TO RECEIVE 1 HOUR RATED SPRAY FIREPROOFING FOR STRUCTURAL BAY SUPPORTING RATED SHAFT; EXTEND A MIN. 12" PAST THE CONNECTION BEYOND BAY (UL#D-703)*" to detail # 2; Life Safety Plan – Level 2 at rated shaft in Room 207. (Refer to attached sketch, SKA-009)

ALL STRUCTURAL STEEL MEMBERS TO RECEIVE 1 HOUR RATED SPRAY FIREPROOFING FOR STRUCTURAL BAY SUPPORTING RATED SHAFT; EXTEND A MIN. 12" PAST THE CONNECTION BEYOND BAY (UL#D-703)

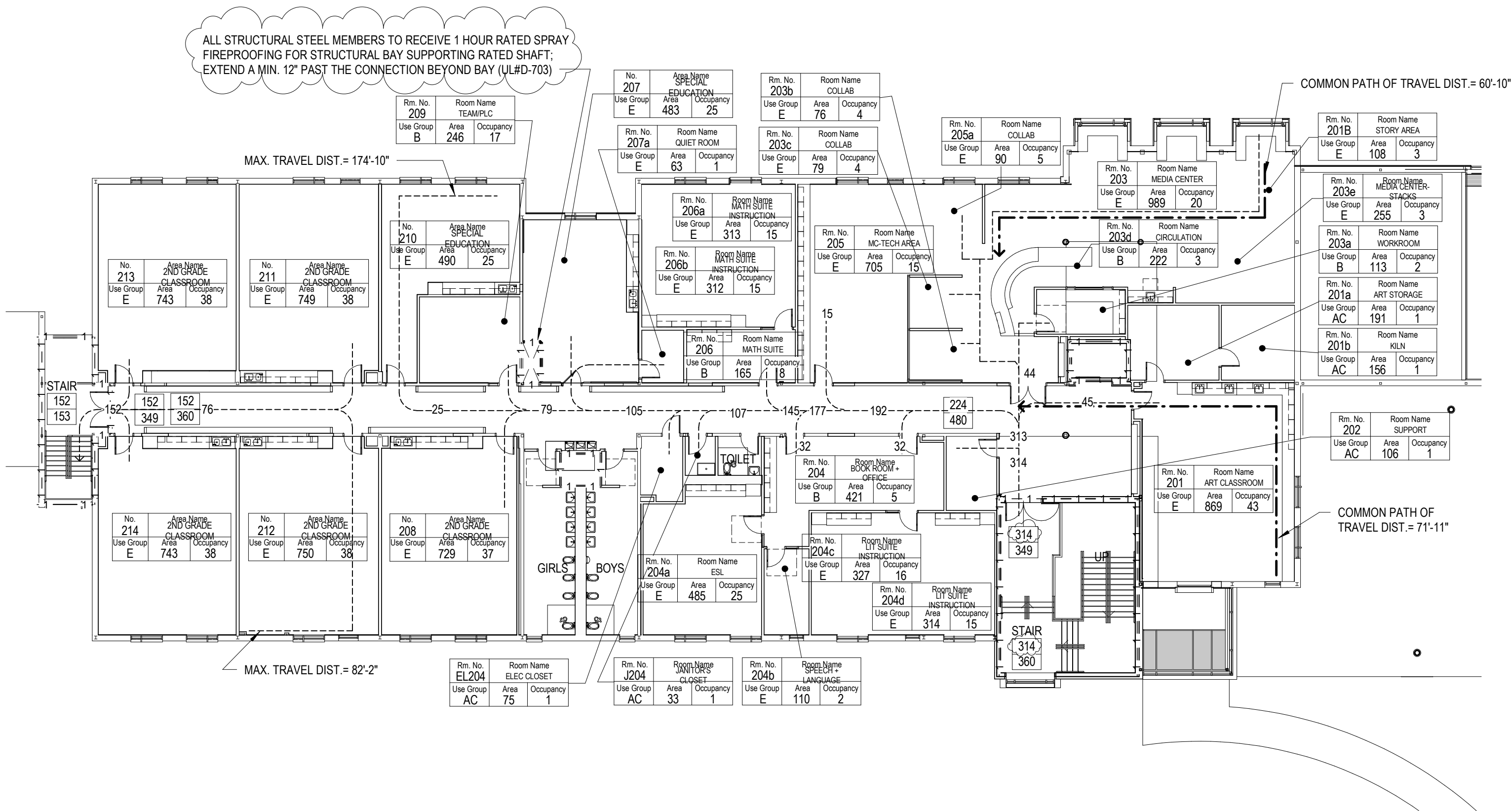

**PERKINS — EASTMAN**

677 Washington Blvd  
Suite 101  
Stamford, CT 06901  
T. +1 203 251 7400  
F. +1 203 251 7474

PROJECT: ANNA H. ROCKWELL ELEMENTARY SCHOOL ADDITIONS & RENOVATIONS

DRAWING TITLE: LIFE SAFETY PLAN - LEVEL 2

DATE: JAN. 10, 2019

PROJECT NO. 68961.00

SCALE: 1/16" = 1'-0"

DWG. NO.: **SKA-009**