

Margaret Gilbert

Buyer

860-679-1988

Telephone Number

mgilbert@uchc.edu

E-mail Address

860-284-5873

Fax Number

**UNIVERSITY OF CONNECTICUT HEALTH CENTER**  
**Procurement Operations & Contracts**  
**263 Farmington Avenue, MC4036**  
**Farmington, CT 06032-4036**

ITB NUMBER:	BID DUE DATE:	BID DUE TIME:	ITB SURETY:
UCHC4-109656223	November 19, 2018	2:00PM EST	10% Bid Bond with Respons
ITB TITLE: Project 18-010 Labor & Delivery/OB Finish Upgrades (Rebid)			

**ADDENDUM NUMBER:** 4

**DATE ADDENDUM ISSUED:** November 8, 2018

**FOR:** The University of Connecticut Health Center

**NOTE:** Reply to supplier question and revised SK-2.1R to follow this cover sheet.

This addendum shall become part of the bid documents, supplier response and

any resulting contract. This addendum is two (2) pages in length, the

remainder of pages are included herein by reference.

**This Addendum must be Signed & Returned with your bid.**

\_\_\_\_\_  
*Authorized Signature of Bidder*

\_\_\_\_\_  
*Company Name*

**Approved By:** \_\_\_\_\_

[ Margaret Gilbert  
Buyer ]

(Original Signature on Document in Procurement Files)

UConn Health - UCHC4-109656223 LD OB Finish Upgrades Project 18-010

Question #	Supplier Question	UConn Health Response
1	<p>I wanted to confirm the direction the wood grain flooring should be installed in the room.</p> <p>On the floor pattern plan SK-2.1 it shows room FG122-FG130 shall be installed parallel to the window.</p> <p>Please clarify if the rest of the rooms need to be installed the same direction (North to south or East to west).</p>	<p>All flooring will run the same direction as the corridors except FG122- FG130. See revised SK-2.1R.</p>

**LEGEND**

- FLOOR TYPE LVT-1
- FLOOR TYPE LVT-2
- FLOOR TYPE SVF-1
- FLOOR TYPE CPT-1

**NOTE:**  
FOR ALL AREAS RECEIVING NEW FLOORING THE EXISTING WALL BASE SHALL BE REMOVED AND REPLACED WITH NEW WALL BASE (VB-1)

**ROOM TYPE-D**  
(5) ROOMS SIM

FLOORING SHALL BE PARALLEL TO THE WINDOW WALL CURVE ALONG THE TANGENT LINE FOR ROOMS FG122, FG124, FG126, FG128 AND FG130

**ROOM TYPE-C**  
(5) ROOMS SIM

**ROOM TYPE-B**  
(2) ROOMS SIM

**ROOM TYPE-A**  
(4) ROOMS SIM

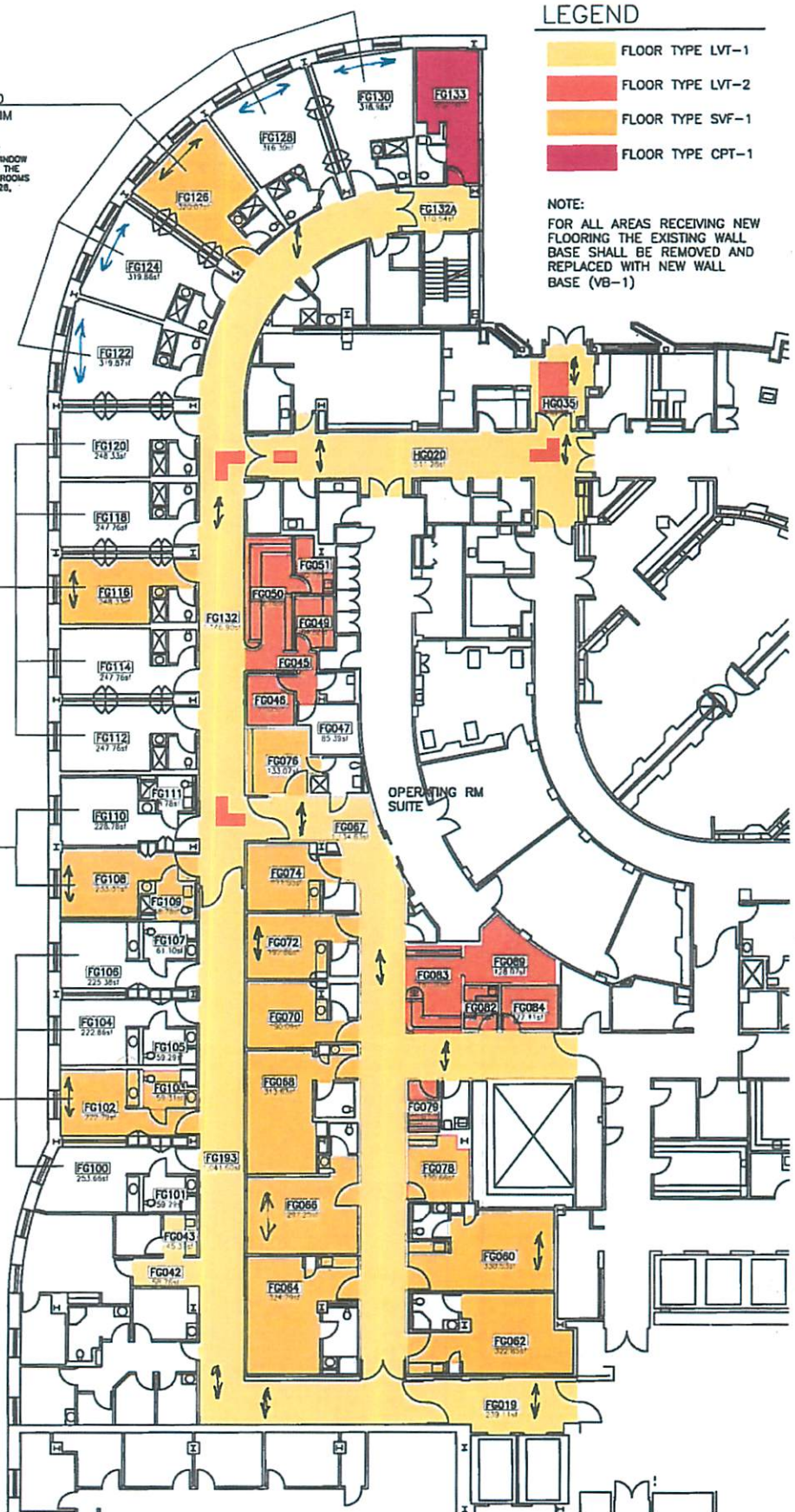

*11/5/18 - Arrows indicating installation direction*

ISSUE DATE 10/19/18	PROJECT NO. 18-010	PROJECT NAME LD/OB FINISH UPGRADES
DRAWING NO. <b>SK-2.1</b>	DRAWN BY CMOSS	DRAWING TITLE FLOOR PATTERN PLAN
	SCALE NOT TO SCALE	