

FINISH SCHEDULE			
CODE	ITEM	MANUFACTURER/STYLE/COLOR	DESCRIPTION   FLAME SPREAD CLASSIFICATION
LV1	Very Thin		
B1	Very Thin Base		4" High, 1/8" Gauge
DR	Decorative Finish	Black	Chartermark Finish
L1	Laminates		
L2	Laminates		
P1	General Wall Panel	Burgundy Navy P100	Laminates
P2	Door and Trim Panel	Burgundy Navy P100	Engineered Finish
P3	Master Ceiling	Custom Mill CC111	Sheet-Like Finish
P4	Master Ceiling		Laminates
P5	Master Ceiling		Sheet-Like Finish

CONSTRUCTION KEY	
	Existing door and frame to remain in place. Typical.
	New door and frame shown in typical.
	Existing partition to remain, patch and repair in place as indicated.
	New partition construction shown in typical.
	Existing Division Tag
	Door Opening Tag shown in Door Schedule
	Work Item Indicator

- CONSTRUCTION NOTES:**
- Con 1: Measure and mark locations for new 2" diameter grommets through existing structure.
  - Con 2: Measure and mark locations for new 2" diameter grommets through existing structure.
  - Con 3: Measure and mark locations for new 2" diameter grommets through existing structure.
  - Con 4: Measure and mark locations for new 2" diameter grommets through existing structure.
  - Con 5: Measure and mark locations for new 2" diameter grommets through existing structure.
  - Con 6: Measure and mark locations for new 2" diameter grommets through existing structure.
  - Con 7: Measure and mark locations for new 2" diameter grommets through existing structure.
  - Con 8: Measure and mark locations for new 2" diameter grommets through existing structure.
  - Con 9: Measure and mark locations for new 2" diameter grommets through existing structure.
  - Con 10: Measure and mark locations for new 2" diameter grommets through existing structure.
  - Con 11: Measure and mark locations for new 2" diameter grommets through existing structure.
  - Con 12: Measure and mark locations for new 2" diameter grommets through existing structure.

FINISH KEY	
	Deviation areas where new finish is required in all heights of wall unless otherwise noted.
	Deviation over walls and base finish.
	Deviation over floor finish.
	Deviation over partitions.
	Numbered Note Tag

- FINISH NOTES:**
- FN1: Refer to specification part in accompanying work.
  - FN2: Measure and mark locations for new 2" diameter grommets through existing structure.
  - FN3: Measure and mark locations for new 2" diameter grommets through existing structure.
  - FN4: Measure and mark locations for new 2" diameter grommets through existing structure.
  - FN5: Measure and mark locations for new 2" diameter grommets through existing structure.
  - FN6: Measure and mark locations for new 2" diameter grommets through existing structure.
  - FN7: Measure and mark locations for new 2" diameter grommets through existing structure.
  - FN8: Measure and mark locations for new 2" diameter grommets through existing structure.
  - FN9: Measure and mark locations for new 2" diameter grommets through existing structure.

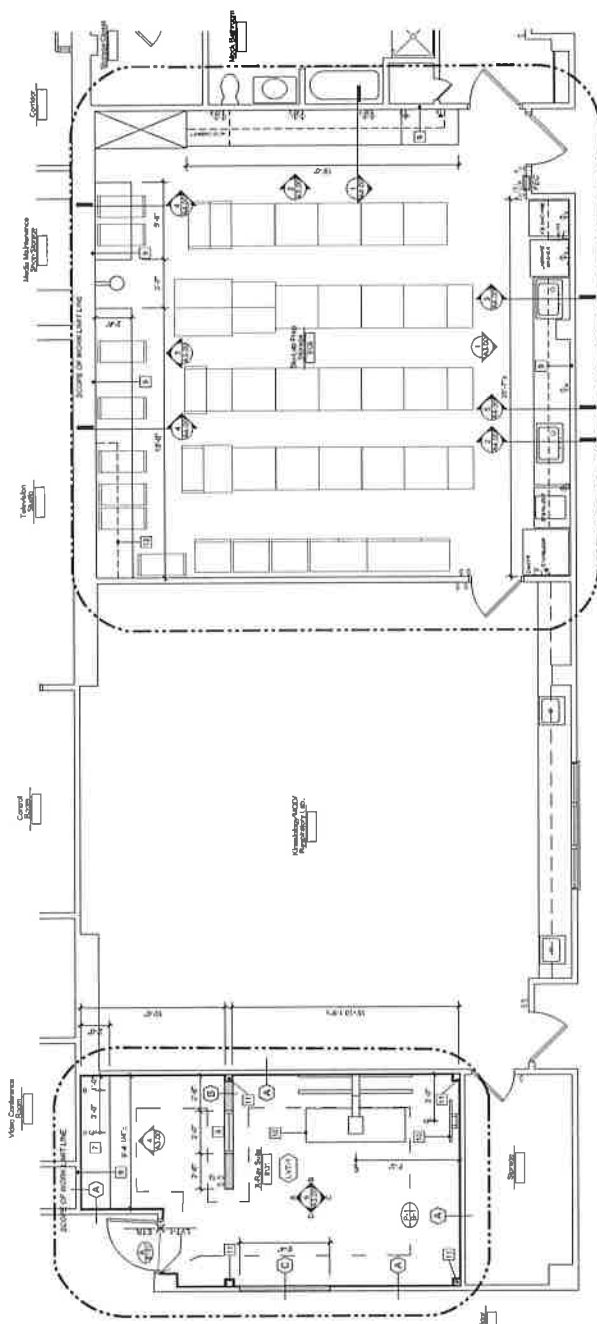

FIRST FLOOR CONSTRUCTION PLAN  
SCALE: 1/8" = 1'-0"



STATE OF CONNECTICUT  
DEPARTMENT OF ADMINISTRATIVE SERVICES  
DIVISION OF CONSTRUCTION SERVICES

PROJECT: FIRST FLOOR CONSTRUCTION PLAN  
DATE: 04/11/2011  
DRAWN BY: [Name]  
CHECKED BY: [Name]

MANAGER: MAJER DESIGN GROUP LLC  
100 HULL STREET, SUITE 20  
MANCHESTER, CT

MANCHESTER COMMUNITY COLLEGE  
RENOVATION X-RAY, BIO PREP  
MANCHESTER, CT

PROJECT NO.: [Number]  
DATE: [Date]  
SCALE: [Scale]

PROJECT NO.: [Number]  
DATE: [Date]  
SCALE: [Scale]

PROJECT NO.: [Number]  
DATE: [Date]  
SCALE: [Scale]

PROJECT NO.: [Number]  
DATE: [Date]  
SCALE: [Scale]

A1.01

